



EXPIRES 2/28/2022

All prices are F.O.B. our warehouse unless otherwise specified.  
Lease figures are approximate and subject to change.



PRICES SUBJECT TO CHANGE  
VISA AND MASTERCARD ACCEPTED



Video on proper air tool maintenance; make your tools last! (También en español)

<http://vimeo.com/212944966/>



## 1/2" Drive Super Duty Air Impact Wrench

- 2" extended anvil
- Handle exhaust
- Free speed: 8000 RPM
- Maximum torque: 600 ft./lbs.
- Proven design and the most popular configuration in the tire service industry
- Powered by the durable and high performing twin hammer mechanism
- Net weight: 5.6 lbs.

**\$119.99**



A2312G

Protect your investment with bootie JB04BLUE.

| Ascot No. | McGee No. | Description                                      |
|-----------|-----------|--|
| 153-33120 | A2312G    | 1/2" Drive Air Impact Wrench - 2" Extended Anvil |
| 153-33121 | 15323121  | 1/2" Drive Air Impact Wrench Short Anvil         |

## Instant Puncture Protection

Instant puncture protection. Repairs any pneumatic tire, tubeless or tube type. Prevents flats from cactus needles, thorns, stickers, and most small nails. Also prevents high pressure and rim leaks.



| McGee No.    | Description                                       | Price    |
|--------------|---|----------|
| FS15         | Applicator pump with a 16" hose for 1 gallon size | \$11.68  |
| FSP          | Metal 5 gallon tire sealant pump with lid         | \$78.05  |
| STSOTRCS4128 | STS OTR tire sealant 1 gallon                     | \$31.79  |
| STSOTR640    | STS OTR tire sealant 5 gallon                     | \$112.96 |
| TC405        | Enforce highway tire sealant 1 gallon             | \$26.20  |
| TC415        | Enforce Fibroseal OTR tire sealant 1 gallon       | \$32.29  |
| TC417        | Enforce Fibroseal OTR tire sealant 5 gallon       | \$99.00  |

McGee Company stocks a complete line of tire mounting compounds!

Largest stock of tire chains in the Rocky Mountain Area!



Wide Base Truck Cam Chains



Autosock



DUO Tractor Chains

## Bias or Radial — Universal Repair Units - Square

| Repair Unit | Inch     | mm    | Qty/Box | Price   |
|-------------|----------|-------|---------|---------|
| SSA45       | 1 3/4 sq | 45 sq | 100     | \$24.31 |
| SSA55       | 2 1/8 sq | 55 sq | 80      | \$26.04 |

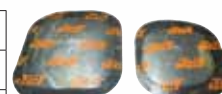

AS - Square

## Bias or Radial — Universal Repair Units - Round

| Repair Unit | Inch  | mm | Qty/Box | Price   |
|-------------|-------|----|---------|---------|
| SRA45       | 1 3/4 | 45 | 30      | \$7.65  |
| SRA45T      | 1 3/4 | 45 | 100     | \$20.80 |
| SRA55       | 2 1/8 | 55 | 30      | \$9.34  |

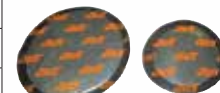

AR - Round

## Fast Dry Vulcanizing Cement

JET Fast Dry Vulcanizing Cement is formulated to provide outstanding performance when used with JET Repair Materials.



| McGee No. | Description                             | Size       | Price   |
|-----------|---|------------|---------|
| 1645J     | Fast Dry Vulcanizing Cement (Flammable) | 8 fl. oz.  | \$6.03  |
| 1646J     | Fast Dry Vulcanizing Cement (Flammable) | 32 fl. oz. | \$15.65 |

# 2 LUBRICATION EQUIPMENT SYSTEMS & PARTS



## Automatic Lubrication Equipment (ALE)

### Why Auto Lube?

- Safer work environment
- Increases productivity
- No lubricant waste
- Less down time
- Reduces component failure
- Optimize lubrication intervals

### What to Auto Lube?

- Yellow Iron
- Industrial equipment
- Anything needing regular lubrication

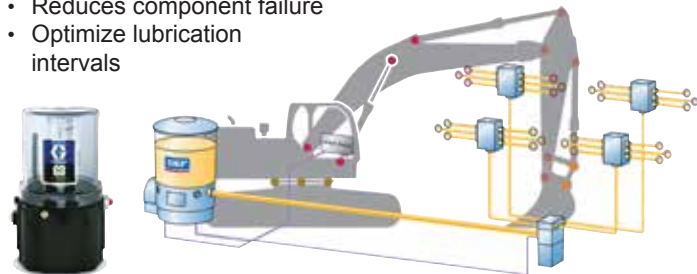

\*PRICES SUBJECT TO CHANGE JAN 1ST OF THE YEAR

## Did you know we design complete systems for your needs?

It doesn't matter the size of your shop, we have the right solution for you. We can design at your location with tablets to give you an idea for a new system or an upgrade before we bring it back to design in CAD. Call today for your time and money saving system from the Graco pros at McGee Company.



1-800-525-8888

## Graco Pumps & Accessories



**24G576**  
**LD Series**  
**3:1 \$388**

Affordable and full featured LD series is designed for lower volume applications.



**246775**  
**Fireball 225**  
**3:1 \$569**

Introducing Graco's classic Fire-Ball design as a 3:1



**203876**  
**Fireball 300**  
**5:1 \$755**

This pump has been the "crown jewel" of Graco since the 1950s and is the pump of choice in the most demanding environments.

## Heavy Duty & High Quality



**HPL25B** 50' AIR **\$379**  
**HPM33B** 35' OIL **\$415**  
**HPM65B** 50' OIL **\$445**



SDM8

- ELECTRONIC
- PRESETTABLE
- VERSION AVAILABLE



EM8

**25C903 — \$325**  
**Rigid Extension**  
**25C904 — \$325**  
**Flexible Extension**

- ELECTRONIC
- LIGHTWEIGHT

**25M404 — Rigid Extension \$459**  
**25M406 — Flexible Extension**

## Maintenance & Installation Available!

### Graco Enclosed Hose Reel

**\$239 24H658X** Air 3/8" x 50'

**\$290 24H662X** OIL 1/2" x 35'

#### Features:

- Designed for light duty applications
- Enclosed for safety and protection, extended hose life
- 5 year warranty



\*Required inlet hose kit sold separately.  
**218547X**

### Tank Gauges

Numbers decrease as fluid level lowers indicating how many inches are left until the tank is empty. For use with oil, waste, diesel fuel, antifreeze and other fluids with a high flash point.

**\$189 008566** used oil gauge



**008164**  
**new oil gauge**  
**\$189**



## Whip your shop into shape with stackable fluid storage & dispensing systems



Dual wall options available



### Oil King

- Large 25 gallon capacity with sight gauge
- Convenient tool trays and filter areas
- Large offset collection pan with screen
- Oversized tires to get over hoses and rough floors



**\$489**  
**238866**

Splatter pads available



### Graco

AIR DIAPHRAGM PUMPS

**3/4" 241906 15 GPM \$479**

**1" 647731 40 GPM \$649**

McGee Company has Graco service and parts!

## 8-1 Drain Plug Wrench \$25.99

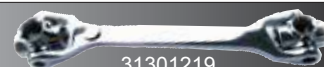

31301219



## SP012 12,000 lbs. capacity SHOCKWAVE™ EQUIPPED



Model Shown:  
SP012U7T5RD  
SHOCKWAVE  
equipped lift

Low  
CEILING  
MODEL  
AVAILABLE

2X faster rise and descent

Three-stage arms add  
reach

Thread-up  
truck adapters  
with stackable  
inserts

Three higher rise  
and extended height  
options – add up to 3' of  
height!

## SP016 16,000 lbs. capacity HEAVY DUTY FRAME CONTACT LIFT



SP0 Series Lifts feature  
thread-up adapters for easy  
vehicle contact

Comes standard with 5" and  
10" stackable inserts

LOW CEILING MODEL AVAILABLE

ALSO AVAILABLE

## SP020

20,000 lbs. capacity  
two post frame contact lift

**McGEE  
COMPANY  
CAN DO THE  
CUSTOMIZED  
CAD DRAWINGS  
FOR YOUR  
SHOP!**

*Price is just the tip of  
the iceberg when  
evaluating equip-  
ment purchase.  
Beware of hid-  
den future  
problems.*



## MACH™ Series Mobile Column Lifts

### MCH14 wireless

4 Column Configuration; 52,000 lbs. capacity

### Easy to use!

- Exclusive intuitive control console - lift is controlled from any column
- Lifts with two, four or six columns at multiple capacities
- Easily adjusts to accommodate a variety of tire sizes
- Inverted, concealed hydraulic cylinder
- Surface mounted and portable - no excavation or site preparation
- Battery operated with an onboard charger that uses only 110v electricity to charge - no power cords to clutter service bays
- 14K - 19K configuration
- Shipped with batteries & hydraulic fluid so ready to use!



Shown  
MCH413U1A00RDYL

## Mach Flex Mobile Column Lifts

- New higher column capacity 18,800 lbs
- Easy to use intuitive remote control operation
- Control all columns from anywhere in the bay with remote included with purchase.
- Includes LockLight™ on each column
- Vehicle Height and Weight digital display gauges



2, 4, 6, & 8 column configurations available!



SM301 - 30,000 LBS.  
LIFTING CAPACITY

CALL FOR PRICING



## Two-Post Lifts

- Original "Double S" single piece column design maximizing strength
- Slider block bearings of Tivar 1000 polyethylene that self-lubricate and are maintenance free
- Adjustable height options with column extensions
- Asymmetrical and symmetrical designs to suit your needs
- Trio three stage arms for asymmetrical lifts
- Shockwave and standard (10,000-20,000lbs) configuration available in two-post
- Multi-position column locks



SPOA10

## SHOCKWAVE Equipped Lifts

- 2X Faster rise and descent than standard lifts
- DC powered which reduces installation/operating costs
- Two standard Group 24 batteries charged by the 110v that runs the lift removes the need for expensive 220v wiring and can operate during power loss
- Spotline motion activated laser helps spot vehicles the first time
- Available on lifts from 7,000-20,000 lbs



## Inground Smartlifts

- 10,000-12,000 lbs capacity models available
- High efficiency power and air per lifting cycle, selected in key lead projects
- Reduces space usage and allows more lifts
- Trio three stage arms for pinpoint location
- Shockwave or standard available



SL210

## Smartlift Green Features

- Uses only 19 quarts "Bio-Fluid"
- An entirely closed system housed in a recycled polymer composite containment which protects the environment and the lift
- The Smartlift uses only .045 kWh of electricity and .01 cfm of air per lifting cycle
- Steel components and housing can be recycled again at the end of the lift's lifecycle



## McGee Company

offers turn key solutions for your shop or dealership equipment needs, lubrication systems, and compressed air including free CAD design!

**Call today for pricing**  
**1-800-525-8888**

**Our experts can help you design your air piping systems, lift installations, and lubrication systems to fit your needs.**

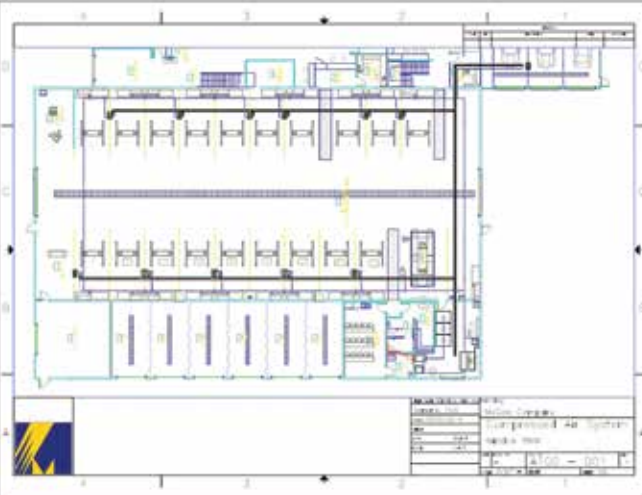

**The World's Most Trusted Lift™** A DOVER COMPANY

## Rotary Symmetric / Asymmetric

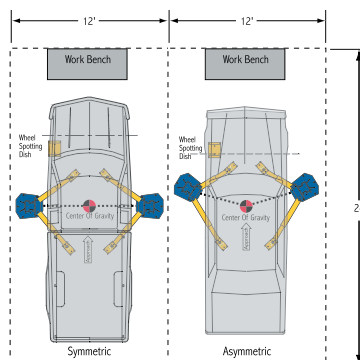

### Benefits of True Asymmetric Lifting:

- When the lift is loaded properly, doors can be opened and the vehicle is positioned a minimum of 24" away from the nearest obstruction.
- With true asymmetrical lifting, the columns are rotated 30° to place the approximate center of gravity of the vehicle in reduce wear and tear on the lift.
- Asymmetrical lifting provides more clearance at the rear of the columns (the open door contact point) approximately 117" vs. 103".

## Versymmetric® / 2-in-1 Lift

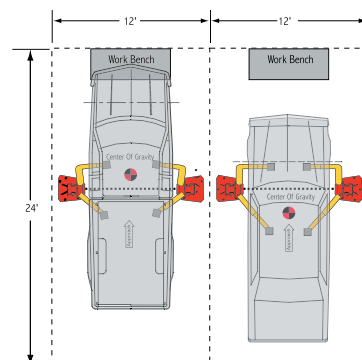

### Pitfalls of Versymmetric / 2-in-1 Lifting:

- When the lift is loaded, long vehicles that should be loaded symmetrically extend too far forward, leaving no room for work benches or walking area. Asymmetrical lifting positions the vehicle too far back, which intrudes into the drive-through area or even an exterior bay door.
- Versymmetric lifting places the approximate center of gravity of the vehicle in front of or behind the optimum load capacity of the lift. By doing so, wear and tear on the column, carriage and bearings is increased.
- No spotting dish makes vehicle positioning "Guesswork".
- The front arm is offset 5" which requires short wheelbase vehicles be pulled further forward to clear the front tire, which reduces the clearance to open doors.



Versymmetric and 2-in-1 style lifts have short arms on the front and long arms on the rear. This is done to accommodate the pick up points of vehicles that are shifted to the rear in order to improve open door clearance for the technician getting in and out of the car. In a symmetric load condition the vehicle is centered fore and aft (not shifted to the rear). The short front arms are unable to reach the pick up points in the symmetric load condition. This can be easily demonstrated by picking up an F350 as shown.

Lift any, vs, way, 2009.02  
©2006 Rotary®. Printed in U.S.A. All Rights Reserved. Unless otherwise indicated, ROTARY, DOVER and all other trademarks are property of Dover Corporation and its affiliates.

\*VERSYPHETRIC is a Registered Trademark of Challenger Lifts, Inc.





## Air/Electric Utility Boxes

- Two 110v electric outlets and air connections mount easily to any column and provide quick access to utilities.
- The filter/regulator/lubricator extends the life of your airtools.

**FA5911BK (with filter/regulator/lubricator)**  
**FA5910BK (without filter/regulator/lubricator)**



## Door Defender™

Rotary's new door defender allows technicians to easily enter and exit the vehicle without damaging their customer's vehicles. The door defender is a low profile solid rubber guard designed to fit over the two-post lift carriage. The N823 door defender kit includes: 1 door defender, adhesive to attach to the lift, a Rotary decal and instructions.

**Model #N823**



## Norco under hoist stand 3/4 ton

- Lightweight, slender design makes handling easy, even in close quarters
- Quick adjust spin handle with thrust bearing eliminates wear and provides ease of turning under load
- Extended height 81"

**81033A**

## Norco 1/2 ton transmission Jack

- Fully adjustable universal saddle with adjustable corner brackets and safety chain, 72" raised height
- Safety overload system prevents jack from being used beyond rated capacity
- Foot operated pump and lowering pedals
- Two-stage flash chromed rams inhibit rust from entering hydraulic system
- Wide base with polyurethane wheels to protect floors.

**72500E**



Ask us about fuel tank saddles

## Wheel Arm for lifts

**92100**

- 100 lbs Capacity
- Set of two arms
- Comes with 2 magnetic tool trays, hex key, and mounting shims



Wheel arms hold tires at the lift arm height – great for tire rotations and brake jobs

## Rubber lift pad for any lift available!



| Ascot No. | Mfg. No. | Description                   | Application  |
|-----------|----------|-------------------------------|--|
| 309-00003 | JOK03M   | Rubber Lift Pad - 5" Round    | Nussbaumlifts  |
| 309-00005 | JOK05M   | Rubber Lift Pad - 4" x 5"     | BenPearsonlifts  |
| 309-00007 | JOK07M   | Rubber Lift Pad - 5" x 5"     | Forward, Worth, American, Gemini, Grand, Tuxedo, Eagle, & Whip lifts |
| 309-00009 | JOK09M   | Rubber Lift Pad - 4" x 4"     | Challenger CL9 and CL10 lifts  |
| 309-00022 | JOK22D   | Rubber Lift Pad - 3.25" x 4"  | Rotary SPO10, SPO12 lifts  |
| 309-00014 | JOK14O   | Rubber Lift Pad - 5.25" Round | Challenger CL10, Quality lifts                                       |
| 309-00011 | JORB-1   | Rubber Block 1.5"             | Rotary Airjacks and all Mid-Rise pad lifts                           |
| 309-00013 | JORB-3   | Rubber Block 3"               | Rotary Airjacks and all Mid-Rise pad lifts                           |

## Did you know?

2019 Chevy & GMC pickups require a specially designed adapter to properly and safely engage the truck's newly designed wider frame.

McGee is stocking for Rotary and Challenger.



**FJ6259KIT (Set of 4)**



**FJ6258KIT (Set of 2)**  
**FJ6257KIT (Set of 2 for Trio)**



**RA, TA, and Trio adapters for Rotary and other brands available, call for pricing!**



**Each LOCKLIGHT™ includes:**

- Indicator light assembly
- Pressure switch
- Mounting Bracket
- 10' of electrical wire

**Part #FA834/110v**  
**Part #FA835/220v**

- Compatible with most surface and in-ground lifts using electric/hydraulic power units
- Retrofits to most existing lifts
- 110v and 220v configurations



**LOCK ENGAGED**

**LOCK NOT ENGAGED**

## Quincy QT® Compressors "Rated #1"



Meticulously designed for maximum productivity. Completely rebuildable with stainless steel valves and heavy duty cast iron crank case and cylinders. Leading the industry with the most CFM per brake horse-power. Includes ASME receiver, enclosed belt guard, EPA high efficiency motor, and loadless auto stop/start.

| Part No.         | HP  | Electric Spec. | ACFM at 175 PSI | Tank Size | Tank Style | Price          |
|------------------|-----|----------------|-----------------|-----------|------------|----------------|
| 251CS80VCB1MAG   | 5   | 230V, 1ph      | 17.2            | 80        | vert.      | <b>\$2,295</b> |
| 271CS80VCB1MAG   | 7.5 | 230V, 1ph      | 22.6            | 80        | vert.      | <b>\$2,495</b> |
| P2103DS12VCB3MAG | 10  | 230V, 3ph      | 35              | 120       | horz.      | <b>\$3,695</b> |

### 3-Year Warranty Program



- Quincy's True Blue 3-Year Warranty
- Register unit within 10 days after purchase to activate warranty
- Purchase and use genuine Quincy filters and lubricant during the warranty period. (Proof of purchase required)
- Receive a 3-year limited warranty on the compressor.
- Receive a 2-year limited warranty on the package.
- Motors and engines are warranted by the original manufacturer.

*Ask about our Energy Audits for rebates from energy companies*

- Electric Operated Drain Valve 1/2"
- 1/4" NPT Inlet & 1/2" Female Pipe
- 300 Maximum Working Pressure
- 110 Volt w/6Ft Power Cord
- Y-Strainer & Ball Valve Included
- Adjustable Timer For Blow Down
  - » 1/2 Second - 45 Minutes Interval Time
  - » 1/2 Second - 10 Seconds Discharge Time

**2523J - \$99.95**



## ELIMINATE WATER!

### Where Water Comes From

The atmospheric air entering a compressor intake contains water vapor. Because of the effects of compression, most of this water vapor turns into troublesome liquid water in your air lines.

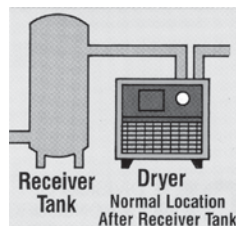

|        |                                    |                   |
|--------|------------------------------------|-------------------|
| QPNC13 | 13 CFM 1PH 115V Refrigerated Dryer | <b>\$895.00</b>   |
| QPNC21 | 21 CFM 1PH 115V Refrigerated Dryer | <b>\$975.00</b>   |
| HPR50  | 50 CFM 1PH 115V Refrigerated Dryer | <b>\$1,575.00</b> |

## Quincy Gas Powered Compressor

**Now \$2,395.00! or Champion version available**

Heavy Duty 13HP Honda engine, 2 stage compressor, 23.6 CFM at 175 PSI!

**Model G213H30HCB**

### Quincy Gasoline Air Compressors

- Truck Bed Mountable, ideal for Field Service Applications
- Heavy Duty Two-Stage Compressors
- V-Belt Drive with Totally Enclosed Belt Guard
- Unloader for loadless start prolongs motor life
- Each new assembled unit comes with a 3-year limited warranty



### Improper Piping for Compressed Air

- PVC has a pressure rating but that is for water, not air!
- PVC pipes and fittings are intended for use in plumbing.
- Water under high pressure does not behave nearly as violently as compressed air does when the vessel in which they are contained breaks.
- PVC pipe and fittings, which can become very brittle after prolonged exposure to sunlight and cold temperatures, can rupture and shatter relatively easily when subjected to high-pressure compressed air, sending sharp pieces of shrapnel flying through the air.
- OSHA and Plastic Pipe and Fittings Association (PPFA), specifically warn against PVC and CPVC for compressed air in the general duty clause.



### Proper Piping for Compressed Air

- 100% aluminum for compressed air, copper ok as well.
- Aluminum offers excellent mechanical resistance to pressure and to impacts.
- The upgraded design of the new PPS1 aluminum fitting is more compact, lighter and more resistant.
- The aluminum alloy used, combined with epoxy paint on the outside and a treatment on the inside, protects the pipe against the risks of oxidation and corrosion.
- Simply insert the pipe into the fitting and then tighten the PPS1 fitting.



## McGee Company recommended reciprocating compressor maintenance

This guide is not designed to be a complete maintenance manual for all air compressors. Refer to manufacturer's manual for detailed instructions. If the unit is in an excessively dusty area, increase frequency of all checks! Always turn power off before servicing.

### DAILY CARE . . .

|  |
|--|
| Check for proper oil level                   |
| Drain any condensate from receiver and traps |
| Check for any unusual noise or vibration     |

### WEEKLY CARE . . .

|  |
|--|
| Clean air filter   |
| Clean all external parts of compressor and driver                    |
| Safety valve should be tested manually to see that it does not stick |

### MONTHLY CARE . . .

|   |
|---|
| Inspect entire air system for leaks                   |
| Inspect oil for contamination and change if necessary |
| Check belt tension and wear                           |

### EVERY SIX MONTHS . . .

|                          |
|--------------------------|
| Change Oil               |
| Inspect valve assemblies |

**Call 800-525-8888 today for details!**

**Detail maintenance chart available. Preventive maintenance programs available in Colorado.**



# CEMB TIRE CHANGERS AND BALANCERS

7



## SM825 Tire Change and EZ10 Balancer

### EZ10 2D Balancer

**\$4150.00**

The EZ10 blends existing technical features – such as Auto Adaptive mode and Virtual Sonar – with the addition of an electromagnetic brake, which eases operations for counterweight application makes this space-saving wheel balancer unbeatable.

- AutoAdaptive™ Mode
- Automatic Approach
- Virtual Sonar
- Automatic Gauge
- Touch panel
- Manual Locking
- Electric brake

**CEMB Balancers include free LT. Truck cone kit**

### SM825

**\$3495.00**



### ER72TD only

**\$6595.00**



## ER72TD and SM628PA High Volume Equipment

The CEMB Digital Wheel Balancer ER72TD is made especially for busy tire shops. SM628PA is a professional grade swing arm tire changer for OEM and oversized tires and custom wheel applications.

- One Plane Balancing
- Auto Adaptive Mode and 3D Sensor
- Laser spotter and manual locking
- EMS sonar
- Max rim width 20", max rim dia. 30"
- Max tire dia. 42"
- 110/220V, 1ph, but air power option available
- Bead Press System w/table top clamping
- Two stage inflation with 2 speed high torque motor
- Rim dia. 12-26"
- Max tire dia. 44"
- Max wheel width 16"
- 220V, 1ph but air power option available

### SM628PA

**\$8395.00**



## DWA 1000/XLT HD Truck and Bus Aligner

**Call for demo and pricing!**

**CEMB**

ADAS calibration assistance available

CEMB's DWA 1000 total vehicle wheel alignment machine improves safety and driver comfort, reduces fuel consumption and tire wear. Comes fully assembled.

- 8 sensor CCD technology
- DSP processing
- PC computer, keyboard and storage cabinet standard
- Four shock resistant BT2 wireless rechargeable truck alignment heads with charging station standard
- Featherweight alignment heads. Only 7.5 lbs each
- Lithium ion batteries for long life
- MEMS static accelerometers provide the newest measuring technology
- 30" wheel clamping range (not rim diameter)
- Windows based software with multiple languages
- Complete vehicle and customer database for Heavy Duty truck with alignment specification 30 years
- Handles up to seven truck axles



## C212 Truck Balancer

**\$11,199.00**

- Fully automatic cycle with braking
- Includes all adapters from passenger to heavy duty truck
- Electro-pneumatic stationary brake
- Automatic distance and diameter input
- Shows static and dynamic unbalance
- Self-diagnosis and self-calibrating
- Built in pneumatic tire lift

Pictured C212



**CEMB**

# TIRE CHANGER ACCESSORIES

## Coats Leverless DuckHead®

Coats Leverless DuckHead® hook and tail booties provide the proper rim protection for all leverless DuckHead® systems - Proguard

89233409 6 hooks, 2 tails  
**\$109.99**

Pictured:  
 PN 89233409

For Coats  
 50X and  
 70X  
 Part #  
 182788



**\$129.84**

## Grey Plastic High Spoke Mount/Demount Duckhead® Tool

For Coats  
 50X  
 and 70X  
 machines  
 Part #184432



**\$40.99**

## High Grip Jaw Protectors

Polymer jaw covers prevent metal-to-metal contact when performing external clamping.  
 - TCX500 Series Machine

RP11811100358 - 8 ea.  
**\$80.99**



## Slide Cover for Bead Lifting Tool

Protects custom rims.

85000783 - Slide Cover for Top of Bead Coats Lifting Tool  
 10 pk - Coats

**\$40.25**

RP11811400098 - 4 pk for Hunter tire machines

Lever sleeve protector, Hunter **\$35.24**



85000783

## Coats Replacement Tire Changer Air Hose - 5 ft.

Coats Replacement Tire Changer Air Hose with Euro Chuck

Part # W44RJ5

**\$13.92**



1822501 Plunger Spring-Loaded Clamp Jaw Button



For Grip  
 Max

**\$14.52 ea.**

85607787 Grip Max Plus Laminated Clamps (4) 6"-24"

**\$749.99**



Part # 181354  
 444-81354

**Special  
 \$36.69**

## For All Rim Clamp Tire Changers



Plastic Inserts for 182788 Metal Mount/Demount Head (Pkg of 2) 50X, 60X, 70X Model 182961

**\$7.17**



183604 Quilted Clamp Socks (10 pk) for series machine - 50X, 60X, 70X

**\$41.99**



Plastic Inserts for 182788 Metal Mount/Demount Head (Pkg. of 12) Model 182963 **\$24.47**  
 444-82963

8560716108 Replacement black grip for new style Grip Max Plus **\$43.67**  
 (8 each)



## Tire Changer Duckhead Specials!

### Hybrid Duckhead Mount/Demount Tool

85608959 **\$169.99**

Replacement tail  
 85608961 **\$14.99**



For 50X, 60X, 70X

### Plastic Duckhead Kit

Part  
 #183061  
 444-01220



**Special  
 \$29.99**

Head, Mount/Demount, Polymer Red  
 Hunter TC3250/3500  
 (1 ea.) Part #2216752



**\$20.99 ea.**

### Plastic Handled Brass Sidewall Brush

- Densely packed brass bristles
- Great for cleaning white sidewall tires



### Wooden Handled Wire Brush with Metal Scraper



| Ascot No. | McGee No. | Description                             | Price         |
|-----------|-----------|---|---------------|
| 395-13124 | 99593     | 8" Plastic Handled Brass Sidewall Brush | <b>\$7.49</b> |
| 535-00150 | 25150     | 14" Wooden Handled Wire Brush           | <b>\$2.89</b> |

### Tuffbar 72080T **\$119.99**



- Prevent mar, scuff or scratches while working on Mag Chrome, and Alloy wheel.
- Extra length than standard bar for more leverage with rim clamp TC machines
- Ideal for mounting low profile tires on large wide diameter alloy rims.
- The polymer plates are replaceable.

### 5500 Low Profile Bead Lever Tool

**Now \$49.95**

Designed by technicians to assist with hard to change low profile tires. The easy grip ergonomically designed handle allows the user needed leverage for the toughest of sidewalls while remaining a safe distance from the face of the wheel.





**Good!**



**60X\_H1**

**STEP UP**

- Swing Arm Design
- Air or 110v Electric Motor
- Built-in Water Separator (Air)
- 6"-24" External Clamping Range
- Metal Clamps
- Hand Actuated Bead Loosener
- Single Point Sealer
- Extended Warranty
- Patented Robo-Arm®
- Metal and Plastic Duckhead
- Can be converted to 70X

**Best!**



**80X\_3**

- **220V, 2 HP electric motor or Air powered**
- Roboroller arm for low pro/run flat tires
- Upgraded chassis design
- Single point sealer
- 6-24" rim diameter with max tire of 50" diameter
- Warranty: 3 Year Parts, 6 Months Labor

**Call today for best prices! 1-800-525-8888**

**1300**

**STEP UP**

- Direct drive motor with 40mm shaft
- 2D Auto data entry
- 220V 1/3ph
- 8-30" diameter wheel range with max tire diameter of 44"
- Warranty: 3 Year Parts, 6 Months Labor



**1500**

- Direct Drive Motor
- Laser Guided Tape-A-Weight
- Side Shadow Board with Basic Pro Kit
- Auto Start Hood
- Static-On-Screen
- New Display Mounting Bracket
- Automatic Data Entry (Distance/Diameter/Width)
- 12 o'clock Inboard Laser
- Stop, Lock & Index



*Coats alignment systems available; call for demo!*

Extended 3 year warranty

**Featuring Pro-Cut & Hunter lathes!**

**CALL FOR QUOTE ON BRAKE LATHES**

## Rep Boy

#3050RB

WAS \$495 **NOW - \$259<sup>95</sup>**

The Rep Boy has a 360° swivel top, adjustable tire spreader, four tilt settings, and a tool bin. The adjustable tire spreader can accommodate all tires from garden service right through to light truck tires. The Rep Boy is versatile enough to be used at the corner service center, high volume tire service centers, or section repair shops.



## Manual Tire Spreader

- Lightweight and easy to use
- Special locking pin for safety
- Made from durable materials
- Locks both beads open for easy tire inspection and repair



| Ascot No. | McGee No. | Description          | Price          |
|-----------|-----------|----------------------|----------------|
| 605-14191 | MS1       | Manual Tire Spreader | <b>\$64.90</b> |

## Channel Lock Cutters

- Precision made of fine polished, high carbon steel
- Distinctive CHANNEL LOCK Blue comfort grips



CHA358



CHA437



CHA447

| Ascot #   | McGee No. | Description                                     | Price          |
|-----------|-----------|---|----------------|
| 319-00358 | CHA358    | 8" Cutting plier with end cutter                | <b>\$33.91</b> |
| 319-00437 | CHA437    | 7" Cutting plier – box joint                    | <b>\$27.70</b> |
| 319-00447 | CHA447    | 7.75" Curved diagonal cutting plier – lap joint | <b>\$32.80</b> |
| --        | CHA337    | 7" Lap joint diagonal plier                     | <b>\$27.91</b> |

## Overhose Kit



| Ascot #   | McGee # | Description   | Price          |
|-----------|---------|---|----------------|
| 173-09165 | 2500    | Quick Change Chuck  | <b>\$22.18</b> |
| 173-09201 | 2510    | 1 <sup>11</sup> / <sub>16</sub> " x 3 <sup>3</sup> / <sub>8</sub> "-24 Chuck Adap. w/Washer & Nut                       | <b>\$4.64</b>  |
| 173-09202 | 2511JD  | 2 <sup>3</sup> / <sub>4</sub> " x 3 <sup>3</sup> / <sub>8</sub> "-24 Chuck Adap. w/Nut & Wheel Spacer                   | <b>\$6.62</b>  |
| 173-09211 | 2512JD  | 1 <sup>7</sup> / <sub>8</sub> " x 3 <sup>3</sup> / <sub>8</sub> "-24 Threaded Adap. w/Washer & Nut - Quick Change       | <b>\$3.91</b>  |
| 173-09212 | SLP9212 | 2 <sup>1</sup> / <sub>4</sub> " long x 3 <sup>3</sup> / <sub>8</sub> " - 24 Threaded Adap. w/ Washer & Nut Quick Change | <b>\$4.64</b>  |
| 173-09213 | 2522    | 1 <sup>5</sup> / <sub>16</sub> " Adap. w/Set Screw for 1 <sup>1</sup> / <sub>8</sub> " Shank                            | <b>\$3.07</b>  |
| 173-09215 | 2523JD  | 1 <sup>5</sup> / <sub>16</sub> " Adapter w/Set Screw for 1 <sup>1</sup> / <sub>4</sub> " Shank                          | <b>\$3.07</b>  |
| 173-09216 | SLP9216 | 1 <sup>5</sup> / <sub>16</sub> " Adapter w/Set Screw for 5 <sup>1</sup> / <sub>16</sub> " Shank                         | <b>\$3.07</b>  |
| 173-09400 | SLP9400 | Overhose Kit - Rear Exhaust   | <b>\$22.18</b> |

## Xlight Tire Service LED Work Light

**\$49.33**

- Designed for hands-free lighting during tire service and other work applications

| Ascot No. | McGee No. | Description                        |
|-----------|-----------|------------------------------------|
| 312-14921 | 31214921  | Xlight Tire Service LED Work Light |



The clamp on handle quickly and easily grips over the bead of a tire.

## RPG Air Powered Tire Repair Vacuum

- Quick change from blow to vacuum function
- KIT INCLUDES: Plastic body gun, dust bag, 2 extension tubes, shop brush, flat tube, tiny tube

**\$44.95**

| Ascot No. | Mfg. No. | Description                        |
|-----------|----------|------------------------------------|
| 537-00003 | VGB2     | RPG Air Powered Tire Repair Vacuum |

## Tire Repair Knife

- High carbon steel, round point skiver, round burnt finish handle (Riveted X2RF)

| Ascot No. | McGee No. | Blade Length | Price          |
|-----------|-----------|--------------|----------------|
| 531-75190 | X2RF      | 4" (102mm)   | <b>\$11.25</b> |
| 531-75190 | X2T       | 4" (102mm)   | <b>\$9.98</b>  |

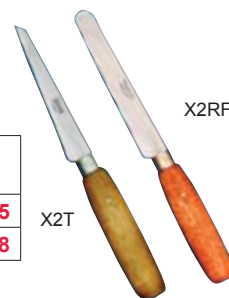

## Low Speed Tire Buffer with Quick Change Slip Chuck

**15810873 - \$74.63**

- Brass bushings provide performance and durability in tough working conditions
- Includes whip hose and exhaust hose
- Built in regulator
- Lock off throttle to prevent accidental start ups
- Rear exhaust directs air away from work area
- Quick change slip chuck for fast and easy change of buffing wheel
- Ideal for patchwork, roughing areas for recapping and cleaning tire moldings
- Equivalent to and has same dynamics as the CP 873k
- Overhose kit also available 175-00873



## High Speed Tire Buffer Kit with Quick Change Chuck

**15811871 - \$73.04****15810871 - with Jacobs - \$73.04**

- Lock-off throttle
- Free speed 22,000 RPM
- Includes overhose kit



## Heavy Duty Skiving Air Buffers and Die Grinders — Compare to DOTCO



**#241160** 4000 rpm Heavy Duty Skive Air Buffer with Q/C chuck and exhaust hose  
\*Spec with industrial needle bearings  
**\$175.55**



**#117814** HD Retread Shop Die Grinder  
25000 rpm .3 hp with collet chuck **\$185.55**



## Prema Universal Repairs

**PREMA** Universal Repairs are designed for NAILHOLE REPAIRING of tubeless tires in the CROWN area only. Universal Repairs are available in round or square versions. Install with PREMA Ultra Fast Dry Vulcanizing Cement. Always fill the injury channel with the appropriate Prema repair material.



PUR2

| Ascot No. | McGee No. | Description        | L (in.) | W (in.) | Qty/Box | Price   |
|-----------|-----------|--------------------|---------|---------|---------|---------|
| 550-00502 | PUR2      | Universal Round 2  | 2 1/4   | --      | 50      | \$28.33 |
| 550-00522 | PUS2      | Universal Square 2 | 1 3/4   | 1 3/4   | 100     | \$37.93 |
| 550-00533 | PUS3      | Universal Square 3 | 2 1/2   | 2 1/2   | 100     | \$59.00 |
| 550-00534 | PUS4      | Universal Square 4 | 3       | 3       | 50      | \$43.60 |

## Ultra Fast Dry Vulcanizing Cement

**PREMA** Ultra Fast Dry Vulcanizing Cement is formulated to provide outstanding performance when used in conjunction with PREMA Repair Materials. Contains no ozone depleting chemicals.



| Ascot No. | McGee No. | Description                                   | Size       | Price   |
|-----------|-----------|---|------------|---------|
| 501-00508 | PFC8      | Ultra Fast Dry Vulcanizing Cement (Flammable) | 8 fl. oz.  | \$10.19 |
| 501-00532 | PFC32     | Ultra Fast Dry Vulcanizing Cement (Flammable) | 32 fl. oz. | \$26.93 |

## Rema Tip Top Universal Patch

The Hole Solution™ - The only patch you'll ever need for making a nail hole repair. For radial and bias-ply passenger or truck tires.



| Ascot No. | REMA No. | Injury Size    | Qty. | Price    |
|-----------|----------|----------------|------|----------|
| 550-26707 | UP3      | Small Nailhole | 100  | \$64.65  |
| 550-26714 | UP45     | 3/16" Nailhole | 300  | \$287.40 |
| 550-26721 | UP6      | 1/4" Nailhole  | 50   | \$70.68  |
| 550-26745 | UP8      | 5/16" Nailhole | 50   | \$94.72  |

## RAD 100 Series Radial Repair Units

**RL110 Bulk 30 Per Bag - \$44.75**

REMA RAD 100 Series center-over-injury repair units. Due to our fully-integrated blue bonding layer and center over injury design, REMA TIP TOP Radial-Ply repair units are suitable for use with all current vulcanizing systems. For best results, always select the corresponding REMA TIP TOP Stem insert unit.



| Ascot No. | McGee No. | Patch Size Inches | (mm)     | Qty/Box | Price   |
|-----------|-----------|-------------------|----------|---------|---------|
| 575-00110 | RAD110    | 2 x 2-3/4         | 55 x 75  | 20      | \$48.22 |
| 575-00115 | RAD115    | 3-1/2 x 3         | 70 x 115 | 10      | \$57.81 |
| 575-00120 | RAD120    | 4-7/8 x 3         | 85 x 130 | 10      | \$57.18 |

## PREMA

### Prema Radial Repairs - Passenger and Light Truck

**PREMA** Center-Over-Injury Repairs are designed for use in all radial tires. The PREMA Radial Repair is intended for use in HOT or COLD applications. PREMA Radial Repairs are designed for use in the crown, sidewall and shoulder of radial tires. Install with PREMA Ultra Fast Dry Vulcanizing Cement. Refer to the PREMA Repair Chart for proper selection of the repair unit. Always fill the injury channel with the appropriate Prema repair material.



| Ascot No. | McGee No. | Description  | L (in.) | W (in.) | # Plies | Qty/Box | Price    |
|-----------|-----------|--------------|---------|---------|---------|---------|----------|
| 575-05109 | PR109     | Radial 109   | 3       | 1 3/4   | 1       | 20      | \$21.17  |
| 575-05110 | PR110     | Radial 110   | 3 1/4   | 2 1/4   | 1       | 20      | \$22.98  |
| 575-05111 | PR110B    | Radial 110   | 3 1/4   | 2 1/4   | 1       | 80      | \$95.56  |
| 575-05112 | PR112     | Radial 112   | 4 3/4   | 3       | 1       | 10      | \$20.61  |
| 575-15112 | PR112B    | Radial 112   | 4 3/4   | 3       | 1       | 40      | \$81.04  |
| 575-05113 | PR113     | Radial 112HD | 5       | 3 1/4   | 1       | 10      | \$24.23  |
| 575-05114 | PR114     | Radial 114   | 5 1/4   | 3 1/2   | 1       | 10      | \$32.65  |
| 575-05120 | PR120     | Radial 120   | 5       | 3 1/4   | 2       | 10      | \$39.65  |
| 575-05135 | PR135     | Radial 135   | 7 1/2   | 5 1/2   | 4       | 10      | \$110.75 |
| 575-05140 | PR140     | Radial 140   | 7 3/4   | 4 1/4   | 3       | 10      | \$94.56  |

## Pre-Buff Cleaner

**PREMA Pre-Buff Cleaner** is formulated to remove contaminants and silicone from the innerliner of the tire prior to buffing. Contains no ozone depleting chemicals.



| Ascot No. | McGee No. | Description                  | Size     | Price   |
|-----------|-----------|------------------------------|----------|---------|
| 505-00532 | PPC32     | Pre-Buff Cleaner (Flammable) | 32 fl oz | \$14.82 |
| 505-00516 | PPC16     | Pre-Buff Cleaner (Aerosol)   | 16 fl oz | \$9.32  |

## Rema Minicombi Repair Units & Accessories

Part of Rema's renowned Blue Bonding System™, Minicombi features a metal pilot guide for easy installation and seating. Specially designed for tread area punctures on both radial and bias-ply tires, Minicombi should be used with Special Cement BL.



| Ascot No. | McGee No. | REMA# | Description(Units/Box)     | Price    |
|-----------|-----------|-------|----------------------------|----------|
| 581-67050 | A3        | A3    | 1/8" Minicombi A3 (50/Box) | \$113.83 |
| 581-67340 | A6        | A6    | 1/4" Minicombi A6 (40/Box) | \$136.41 |
| 581-68008 | B8MC      | B8-MC | 5/16" Minicombi B8 (20)    | \$96.98  |



Rema tire tube patches are renowned for their easy application and extraordinary effectiveness. A unique rubber compound allows the patch to stretch evenly and equally in all directions upon inflation, assuring a reliable bond and minimal bulging in any service condition.

| Ascot No. | McGee No. | Units Size   | Per Box | Price   |
|-----------|-----------|--------------|---------|---------|
| 541-00410 | 1         | 1-1/2" Round | 30      | \$9.92  |
| 541-00420 | 2         | 1-3/4" Round | 30      | \$17.26 |
| 541-00430 | 3         | 2" Round     | 30      | \$22.21 |

Patch should be 1/2-inch larger in both width and length than the injury.

## Carbide Cutting Tools

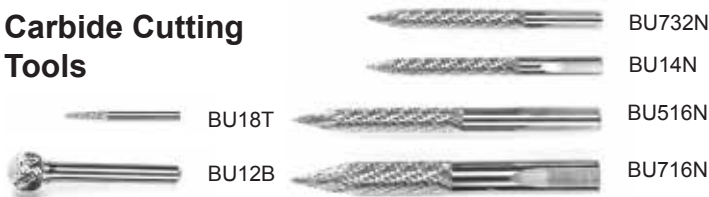

| Part No. | Description   | Prices          |
|----------|---|-----------------|
| BU18T    | 1/8" Taper Burr (PCC1)                              | <b>\$9.31</b>   |
| BU14T    | 1/4" Taper Burr (PCC2)                              | <b>\$37.07</b>  |
| BU38T    | 3/8" Taper Burr (PCC4)                              | <b>\$32.67</b>  |
| BU12B    | 1/2" Ball Burr                                      | <b>\$30.13</b>  |
| BU732N   | 7/32" Long Pointed Burr (Use with 1/4" Plug)        | <b>\$36.11</b>  |
| BU516N   | 5/16" Long Pointed Burr (Use with 3/8" Plug) (PCC3) | <b>\$49.99</b>  |
| BU716N   | 7/16" Long Pointed Burr (Use with 1/2" Plug)        | <b>\$104.99</b> |

## Professional Stitchers

- Corrugated ball bearing stitcher with hardened steel wheel and varnished wooden handle



| Ascot No. | Part # | Description                  | Price         |
|-----------|--------|------------------------------|---------------|
| 536-00001 | 30     | 1-1/2" Diameter x 1/16" Face | <b>\$9.34</b> |

## Gooseneck Stitchers

The newly designed GOOSENECK STITCHER has been proven to enhance stitching performance, providing ample pressure at all points on the tire without causing muscle fatigue for the tire technician.

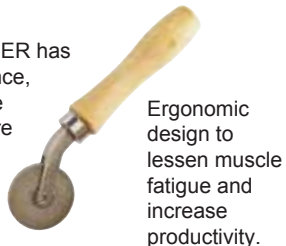

Ergonomic design to lessen muscle fatigue and increase productivity.

| Part No. | Description   | Price          |
|----------|---------------|----------------|
| 30GN     | 1-1/2" x 1/8" | <b>\$11.33</b> |
| 6005GN   | 2" x 1/4"     | <b>\$14.51</b> |



- This tool is a must for professional tire repairs
- Eliminates power buffing on many tire repairs
- Scraper removes material that might contaminate buffing wheels, ensuring a better repair every time

| Ascot #   | McGee No. | Blade Length                     | Price         |
|-----------|-----------|----------------------------------|---------------|
| 537-00004 | 933       | Black Handle Inner Liner Scraper | <b>\$7.80</b> |

## 1/4" Shaft Tool

- Larger spheres, tapers & rotor saw are excellent for high-tread skiving.
- Smaller spheres chamfer around injuries on liner; don't take a chance on entrapped air!
- For section repair or high-tread repairs on radial truck tires & hot repair on nail injuries for retreaders.

| Part # | Shape  | Diameter      | Coating      |
|--------|--------|---------------|--------------|
| RH603  | Sphere | 7/8" (22.2mm) | Coarse (330) |

## 2-1/2" All-Purpose Tire Buffing Wheel



- Our most popular wheel
- Covers more tire sizes than any other wheel
- Wide range of applications: Passenger/LT, Medium & Commercial Truck and Retreading

## 1-1/4" High Performance/Low Profile Tire Buffing Wheel



- Buff's inner liner of low-aspect tires without damaging the bead area
- Machined-steel construction for smooth operation
- Internal thread; no exposed threads at top
- Superb control and comfortable use
- Preferred by many for any passenger or light truck repair

| Part # | Diameter | Bore   | Coating      |
|--------|----------|--------|--------------|
| RH107  | 2-1/2"   | 3/8-24 | Fine (170)   |
| RH109  | 2-1/2"   | 3/8-24 | Medium (230) |

| Part # | Diameter | Bore   | Coating    |
|--------|----------|--------|------------|
| RH140  | 1-1/4"   | 3/8-24 | Fine (170) |

## Polyplugs-RH152 2 1/2" is most popular

- Compensates for mounting inaccuracies
- Improves wheel life
- Reduces vibration for smoother, quieter, more comfortable operation.



Don't forget to upgrade your Flared Contour Wheels with PolyPlug Inserts for an even better buffing experience!

## RUBBERHOG TIRE REPAIR

Rubberhog carbides have a coating of randomly spaced sharp uniform conical teeth made from a very hard tungsten carbide material. It is the combination of the sharpness of the teeth, with the uniform height and shape of the teeth, that gives the Rubberhog rasp a fast, cool, superior buff texture resulting in a longer rasp service life.

## Wire Brushes

Ideal for buzzout repair of radials



535-08014

535-15463

## Copper Center® Wire Wheel Brushes-Wire Fill

| Ascot #   | Mfg. # | Dia. | Wire Size | Arbor RPM | Hole      | Price          |
|-----------|--------|------|-----------|-----------|-----------|----------------|
| 535-15463 | 15463  | 2"   | .0118"    | 20,000    | 1/2"-3/8" | <b>\$8.85</b>  |
| 535-15533 | 15533  | 3"   | .006"     | 20,000    | 1/2"      | <b>\$13.20</b> |
| 535-15543 | 15543  | 3"   | .008"     | 20,000    | 1/2"      | <b>\$11.29</b> |
| 535-15563 | 15563  | 3"   | .0118"    | 20,000    | 1/2"-3/8" | <b>\$10.69</b> |

## Knotted Brushes

|           |       |    |        |        |          |                |
|-----------|-------|----|--------|--------|----------|----------------|
| 535-08014 | 08014 | 3" | .014"  | 20,000 | 1/2-3/8" | <b>\$30.94</b> |
| 535-08034 | 08034 | 4" | .0118" | 20,000 | 1/2-3/8" | <b>\$35.80</b> |

## Buffing Wheels



33



539-00788

538-14000  
RH140

BC-1



TCW21060SAEN



1030G

| Ascot No. | McGee No.    | Description  | Price          |
|-----------|--------------|--|----------------|
| 539-00033 | 33           | 3/8" - 24 Arbor for mounting buffing wheels  | <b>\$7.15</b>  |
| 539-10001 | BC1          | 36 grit, round-nose buffer wheel, Tungsten Carbide 2 1/2" diameter — use on tires or tubes | <b>\$3.98</b>  |
| 538-13000 | 1030G        | 2" fine tooth buffing cone-Ideal for passenger inner liners                                | <b>\$16.67</b> |
| 538-01034 | 1034T        | 2" med. tooth buffing cone-Ideal for passenger inner liners                                | <b>\$20.58</b> |
| 539-00788 |              | (2) No. BC-1 buffing wheels mounted back-to-back on No. 33 Arbor (order item separately)   |                |
| 538-14000 | RH140        | Faster, cleaner buffing; avoid burning   | <b>\$26.48</b> |
|           | TCW21060SAEN | 2" x 1" 3/8" SAE 60g rasp cup  | <b>\$22.99</b> |

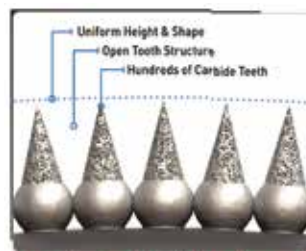

SSG Structured Carbide coatings and unique flared shape maximizes contact, producing a flat, level buffed surface!





## Premium Quality Chemical Vulcanizing Rubber Patches

Stems Repair Unit



JSU - Combi

Note: The JET Combi may only be used when the angle of the injury is LESS THAN 25°. If the injury angle is GREATER THAN 25°, repair with the appropriate two-piece stem and repair unit.

(Poly coated stem style)



| Repair Unit | Inch | mm | Cutter | Qty/Box | Price   |
|-------------|------|----|--------|---------|---------|
| SCU03       | 1/8  | 3  | BU18T  | 24      | \$25.02 |
| SCU06       | 1/4  | 6  | BU14T  | 24      | \$29.90 |
| SCU08       | 5/16 | 8  | BU516N | 24      | \$37.51 |
| SCU10       | 3/8  | 10 | BU38T  | 10      | \$31.68 |

## Ascot (Lead Wire Pull Through Patch/Plug)

- Easiest and most popular method to fill a nail hole and apply a patch in one simple step
- Lead wire guides the rubber stem through injury
- Stem coated with self vulcanizing material and patch features Versacure bonding gum
- For tread area of bias and radial passenger and truck tires



| McGee No. | Xtra Seal | Description | Box Qty. | Sale    |
|-----------|-----------|-------------|----------|---------|
| 58700301  | 13-670    | 1/8" Stem   | 48       | \$36.70 |
| 58700306  | 13-673    | 1/4" Stem   | 24       | \$18.36 |
| 58700309  | 13-674    | 3/8" Stem   | 24       | \$23.16 |

## TUBE REPAIR PATCHES AND PUNCTURE REPAIR UNITS

### Ascot (Push Through Patch/Plug)

- One-piece molded rubber patch/plug unit with a metal quill that protects the stem from damage during insertion
- For tread area of bias and radial passenger and truck tires



| Ascot No. | McGee No. | Xtra Seal | Description      | Box Qty. | Sale    |
|-----------|-----------|-----------|------------------|----------|---------|
| 587-01151 | QSR-1     | 13-386    | 1/4" (6mm) Stem  | 24       | \$22.78 |
| 587-01152 | QSR-2     | 13-382    | 1/4" (6mm) Stem  | 48       | \$36.03 |
| 587-01150 | QS50R     | 13-381    | 1/8" (3 mm) Stem | 48       | \$39.96 |

## Bead Sealer

JET Bead Sealer provides a seal between the bead area of the tire and rim, assisting in the prevention of leaks caused by minor surface imperfections.

| McGee No. | Description | Size       | Price   |
|-----------|-------------|------------|---------|
| 1770J     | Bead Sealer | 32 fl. oz. | \$15.82 |



Bead Sealer

## JET Radial Repairs - Passenger and Light Truck

JET Center-Over-Injury Repairs are designed for use in all radial tires. The JET Radial Repair is intended for use in HOT or COLD applications. JET Radial Repairs are designed for use in the crown area of radial tires. Install with JET Fast Dry Vulcanizing Cement.



Radial Repair Units

| Repair Unit | Size          |          | Qty/Box | Price   |
|-------------|---------------|----------|---------|---------|
|             | Inch          | mm       |         |         |
| SR110       | 2 3/4 x 2     | 70 x 50  | 20      | \$15.93 |
| SR110H      | 3 1/4 x 2 3/8 | 80 x 60  | 10      | \$10.05 |
| SR112       | 4 3/8 x 2 1/2 | 110 x 65 | 10      | \$12.37 |
| SR114       | 5 3/4 x 3     | 145 x 75 | 10      | \$20.68 |
| SR120       | 5 x 3         | 125 x 75 | 10      | \$20.02 |
| SR122       | 6 7/8 x 2 3/8 | 175 x 80 | 10      | \$26.90 |
| SR124       | 8 1/4 x 3 3/8 | 210 x 85 | 10      | \$35.28 |

Additional sizes - SR133, SR140, SR142

Universal repairs - nail hole injuries in crown area only. Techno cushion gum for max adhesions.

### Bias or Radial — Universal Repair Units - Square

| Repair Unit | Inch     | mm    | Qty/Box | Price   |
|-------------|----------|-------|---------|---------|
| SSA45       | 1 3/4 sq | 45 sq | 100     | \$24.31 |
| SSA45T      | 1 3/4 sq | 45 sq | 100     | \$22.34 |
| SSA55       | 2 1/8 sq | 55 sq | 80      | \$26.04 |
| SSA55T      | 2 1/8 sq | 55 sq | 120     | \$35.91 |



AS - Square

### Bias or Radial — Universal Repair Units - Round

| Repair Unit | Inch  | mm | Qty/Box | Price   |
|-------------|-------|----|---------|---------|
| SRA45       | 1 3/4 | 45 | 30      | \$7.65  |
| SRA45T      | 1 3/4 | 45 | 100     | \$20.80 |
| SRA55       | 2 1/8 | 55 | 30      | \$9.34  |
| SRA55T      | 2 1/8 | 55 | 120     | \$26.45 |



AR - Round

## Fast Dry Vulcanizing Cement

JET Fast Dry Vulcanizing Cement is formulated to provide outstanding performance when used with JET Repair Materials.



| McGee No. | Description                             | Size       | Price   |
|-----------|---|------------|---------|
| 1645J     | Fast Dry Vulcanizing Cement (Flammable) | 8 fl. oz.  | \$6.03  |
| 1646J     | Fast Dry Vulcanizing Cement (Flammable) | 32 fl. oz. | \$15.65 |

## Pre-Buff Cleaner

JET Pre-Buff Cleaner is formulated to remove contaminants and silicone from the innerliner of the tire prior to buffing.



| McGee No. | Description                | Size     | Price   |
|-----------|----------------------------|----------|---------|
| 1723J     | Cleaner (Flammable)        | 32 fl oz | \$19.95 |
| 1722J     | Pre-Buff Cleaner (Aerosol) | 16 fl oz | \$13.95 |

## Wall Mount Repair Cabinet

Empty cabinet  
#PCAB1

**\$129.00!**

McGee Company can help you determine tire repair items needed to get started. Call for details.





McGee Company does not recommend "temporary" tire repairs. All repairs should perform the function of filling or replacing the injured section as recommended by the RMA and other industry associations.

## Vulcanized Tubeless Tire Repair Seals

- For emergency repair use only
- String repairs are not designed to be used in lieu of a permanent repair
- Repair a punctured tire in a matter of minutes
- Made from high-strength yarn and butyl rubber

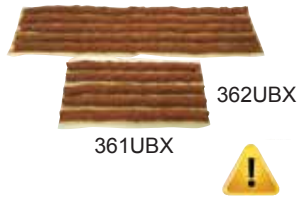

| McGee No. | Description                 | Qty/Box | Price          |
|-----------|-----------------------------|---------|----------------|
| 361UBX    | 4" Brown String Repair      | 50      | <b>\$11.95</b> |
| 362UBX    | 8" Brown String Repair      | 25      | <b>\$9.95</b>  |
| 370UBX    | 7" Thin Black String Repair | 50      | <b>\$11.95</b> |



Clean out small injuries

| Rema No.  | McGee No. | Description | Price         |
|-----------|-----------|-------------|---------------|
| 537-95893 | 261RT     | Reamer      | <b>\$7.90</b> |

- Used to inspect injuries in tires and to remove small stones and debris



| Ascot No. | McGee No. | Description      | Price         |
|-----------|-----------|------------------|---------------|
| 537-00001 | 1013P     | Black Handle Awl | <b>\$6.53</b> |

## Tire Denailer

- Blade length 3"
- Point diameter 5/16"
- Made in USA



537-00353  
**\$11.15**

Developed by a tire repairman to probe the injury and push the nail back through the tire. Probe has a recess at the tip to accept the point of a nail or other puncturing object.



537-15227



537-15230

| Ascot No. | Mfg. No. | Description                 | Price          |
|-----------|----------|-----------------------------|----------------|
| 537-15227 | 23113IR  | Insert Tool Open Needle     | <b>\$4.65</b>  |
| 537-15230 | 20000    | Insert T Handle Open Needle | <b>\$22.90</b> |

**McGee Company can help you determine the tire repair items needed to get started. Call for details!**

## Tire Marking Crayons



459-54222

- Bright Color On Any Tire
- Will not melt, soften or rub off in the pocket. A quality crayon that marks on tires, tubes and rubber.
- Sold 12 per box.



The White Markal Crayon in use.

| Ascot No. | McGee No. | Color  | Price         |
|-----------|-----------|--------|---------------|
| 459-51420 | 51420     | White  | <b>\$6.95</b> |
| 459-51422 | 51421     | Yellow | <b>\$6.95</b> |



## Safety Seal Auto/Light Truck Tire Repair Refills

- 24 plies of a custom made high tensile (350 lb break strength) chemical resistant nylon yarn
- Each yarn is immersed in proprietary rubber sealant system (250% rubber to yarn)
- Patented manufacturing process assures the final Safety Seal® repair has an equal amount of rubber sealant (250% rubber to yarn) throughout the Safety Seal® Repair
- Includes 60 4" (10cm) refill repairs per kit



| Ascot No. | McGee No. | Description   | Price                  |
|-----------|-----------|---|------------------------|
| 585-60410 | SSRA      | Auto Light/Truck Tire Repair Refills 60 4" (10cm) Repairs | <b>\$23.95</b> per box |

Alternate 361UBX

## Safety Seal® Deluxe Tire Repair Kit

For autos and light trucks

"On the Wheel" design for the professional who wants to fix a flat quickly and easily

Repairs punctures up to 1/4" and seals entire puncture from tread to inner liner

Also available in other sizes: truck, off-road and heavy equipment



SSKTP

| Ascot No. | McGee No. | Description            | Price              |
|-----------|-----------|------------------------|--------------------|
| 571-22960 | SSKAP     | Deluxe Tire Repair Kit | <b>\$47.46</b> Kit |
| 571-22926 | SSKTP     | Deluxe Truck Kit       | <b>\$48.31</b>     |

## Safety Seal® Truck Tire Repair Refills

- 24 plies of a custom made high tensile (350 lb break strength) chemical resistant nylon yarn
- Each yarn is immersed in proprietary rubber sealant system (250% rubber to yarn)
- Patented manufacturing process assures the final Safety Seal® repair has an equal amount of rubber sealant (250% rubber to yarn) throughout the Safety Seal® Repair
- Includes: 30 8" (20cm) refill repairs per kit



| Ascot No. | McGee No. | Description                                    | Price                  |
|-----------|-----------|--|------------------------|
| 585-30820 | SSRT      | Truck Tire Repair Refills 30 8" (20cm) Repairs | <b>\$22.67</b> per box |

or 362UBX

## Paintstik® Marker



Markal®

Permanent, waterproof and fadeproof. Marks on wet tires, withstands retreading temperatures. Nontoxic, contains no lead. Sold 12 per box. Other colors available.

| Ascot No. | McGee No. | Color  | Price          |
|-----------|-----------|--------|----------------|
| 459-80257 | MKWhite   | White  | <b>\$11.33</b> |
| 459-80258 | MKYellow  | Yellow | <b>\$11.55</b> |





# ALIGNMENT SOLUTIONS

15



**\$122.<sup>99</sup>**

## 23450 HONDA/ACURA ADJ BALLJOINT

Use this sliding ball joint to adjust camber on the rear of the Acura MDX for improved handling and tire wear. The OE quality ball joint is easily installed and corrects camber angles  $\pm 3^\circ$ .

**Rear** Adjustment range:  
Camber  $\pm 3.00^\circ$

Required: 1 per wheel

### APPLICATIONS

**Acura:** 2014 & Up MDX

**Honda:** 2016 & Up Pilot

**Honda:** 2017 & Up Ridgeline

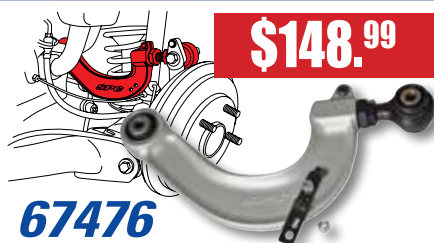

**\$148.<sup>99</sup>**

## 67476 CIVIC REAR CAMBER ARM

Get your late model ready for the street or track with SPC's forged aluminum adjustable rear camber arm. SPC forged aircraft grade aluminum arm weighs less than the OE arm it will replace. The arm is built with SPC's xAxis™ sealed flex joint to reduce compliance.

**Rear** Adjustment range:  
Camber  $\pm 3.00^\circ$

Installation time: .6 hr/side

Required: 1 per wheel

### APPLICATIONS

**Honda:** 2017 & Up CR-V  
2016 & Up Civic (Inc. Si & Type R)



67570

**\$99.<sup>99</sup>**

67580

**\$76.<sup>99</sup>**

## 67570/67580 HONDA REAR CAMBER ARM

These adjustable rear upper control arms deliver  $\pm 3^\circ$  of camber change. The arm has OE style ball joint and bushing making it an ideal piece for both collision repair and traditional wheel alignment needs.

**Rear** Adjustment range:  
Camber  $-2.00^\circ$  to  $+4.0^\circ$

Installation time: .5 hr/side

Required: 1 per wheel

### APPLICATIONS

**67570**

**Honda:** 2009 - 15 Pilot

**67580**

**Honda:** 2007 - 16 CR-V

## RAV4 2006-2018 ALIGNMENT PARTS 67806 ADJUSTABLE TOE ARM

Due to a factory recall for Toyota RAV4's, much of the third generation of this popular platform no longer has provisions for rear toe adjustment. Replace Toyota's non-adjustable rear arm with SPC's adjustable link and get the toe changes needed to avoid premature tire wear. SPC's R&R rear link provides  $\pm 3.0^\circ$  of toe change.

## 67810/67811 ADJ. CAMBER ARM

Adjust rear camber on late model RAV4 with this adjustable rear camber arm. With  $\pm 3^\circ$  of adjustment, this arm will get your vehicle back into factory specification for proper tire wear, handling, and ride quality. Use part #67810 for the right hand side or part #67811 for the left hand side.

## 81290 EZ CAM™

Make a two bolt strut adjustable up to  $\pm 1.75^\circ$  camber with the EZCam™. Simply remove the upper bolt, install the EZCam, loosen the lower bolt, and dial in the required change.

67806

67810  
67811

81290

**67806**

**Rear** Adj. range:  
Toe  $\pm 3.0^\circ$

**\$93.<sup>99</sup>**

Install time: .3 hr/side Req.: 1 per wheel

## 67810 RIGHT / 67811 LEFT

**Rear** Adj. range:  
Camber  $\pm 3.0^\circ$

**\$109.<sup>99</sup>**

Install time: .6 hr/side Req.: 1 per wheel

**81290**

**Front** Adj. range:  
Camber  $\pm 1.75^\circ$

**\$23.<sup>99</sup>**

Install time: .4 hr/side Req.: 1 per axle

### APPLICATIONS

**Toyota:** 2006 & Up RAV4/Highlander

## TOYOTA CAM BOLT KITS 25435/25440

These Cam Bolt Kits are a replacement kit for the OE adjusters. The OE bolts on Toyota trucks and SUV's are frequently "frozen" and do not allow for adjustment. Remove the frozen bolt assembly and replace it with an SPC cam kit to get up to  $\pm 1.50^\circ$  camber and caster change. OE adjuster assemblies that are severely corroded may require SPC's press tool 40915 for removal, making the job quick and easy.



25435

25440

**25435** **Front** Adj. range:  
Camber/Caster  $\pm 1.5^\circ$  Req.: 1 per wheel

**\$29.<sup>99</sup>**

### APPLICATIONS

**Lexus 4WD:** 2003 - 09 GX **Toyota 4WD:** 2005 - 15 Tacoma

**Toyota RWD:** 2005 - 15 Tacoma w/6 lug axles

**Toyota RWD/4WD:** 2007 - 09 FJ Cruiser, 2003 - 09 4runner

**25440** **Front** Adj. range:

Camber/Caster  $\pm 1.50^\circ$  Req.: 1 per wheel

**\$59.<sup>99</sup>**

### APPLICATIONS

**Lexus 4WD:** 2010 & Up GSX

**Toyota RWD/4WD:** 2010 - 14 FJ Cruiser

2016 & Up Tacoma w/ 6 lug axles  
2010 & Up 4Runner

### Kilfroist

K16 Kilfroist Pneumatic Tool Anti-Freeze Lubricant,  
16 Oz. bottle - 18184581 - **\$9.99**

- Prevents the freezing of pneumatic equipment caused by the formation of ice in and around exhaust ports and valves. Kilfroist absorbs the water in the airline. Is a semi-synthetic lubricant which has none of the drawbacks associated with normal oils.



*Winter is here!*

Protect your investment with a boot. Ask your rep for the right size.



**ASK US ABOUT OUR 1/2"**  
**BATTERY POWERED OPTIONS**

FROM:

**Milwaukee**

### CP7748TL2 Torque Limited 1/2" Drive

- Limited 1/2" Drive
- "Best Practice Tool" bubble on side
- The CP7748TL series is intended to be used as a "snugging" tool prior to final tightening with a calibrated torque wrench to reach the specified torque rating
- Torque limited in forward: 60/70 ft. Lbs. - 90/100 Nm, Full in reverse
- Insulation & Comfort: Contoured comfort grip handle instead of TPR injected in handle
- Low sound level suited for all light vehicle tire changing applications
- 360° swivel air inlet



| ASCOT     | MC GEE NO. | PRICE           |
|-----------|------------|-----------------|
| 153-77483 | CP7748TL2  | <b>\$219.99</b> |

### 1/2" CP77482 - Extreme Torque & Durability

- Most powerful 1/2" air wrench in its class
- Twin hammer grease clutch
- Ergonomic rubber handle
- Reinforced nose wings and back housing cap for longer durability
- Max Torque 1200 ft. lbs.
- 922 ft. lbs. Working Torque



**CP77482**  
**\$184.99**



**CP7736-2 1/2 Impact**  
**\$149.99**

Patented spring hammer clutch for smooth operation and extended durability  
Low air consumption and high torque make this tool very efficient

- ULTIMATE TORQUE: 550 ft./lbs.
- Comfort and control with new ergonomic grip and trigger

### 1" Heavy Duty Air Impact Wrench

2140 ft.lbs 2900 Nm of maximum torque in reverse

- Pinless closed reinforced rocking dog impact mechanism
- Socket retainer ring combined with hole retainer
- Ergonomic side handle
- Full teasing trigger
- Regulator with integrated forward/reverse with 3-position power settings in both directions



155-77826  
1" Heavy Duty Air Impact Wrench

| ASCOT NO. | MC GEE NO. | PRICE           |
|-----------|------------|-----------------|
| 155-77826 | CP77826    | <b>\$534.99</b> |
| 155-17782 | CP7782SP6  | <b>\$609.99</b> |

153-02312

### 231XP2

1/2" Super Duty Extended Anvil  
**Air Impact Wrench**

**\$149.77**

This new model redefines the standards set by the classic IR231 model, with an enhanced Twin Hammer impact mechanism for more power and in-handle exhaust to direct air away from the operator and the work area.



2235TIMAX2

| Ascot No. | McGee No.   | Description                             | Price           |
|-----------|-------------|---|-----------------|
| 153-00231 | IR231       | Air Wrench 1/2" Dr Short Anvil          | <b>\$135.99</b> |
|           | 2235TIMAX2  | Air Wrench 1/2" Long Anvil Titanium     | <b>\$279.99</b> |
|           | 2235QTIMAX2 | 1/2" Dr Quiet Air Wrench Long Anvil     | <b>\$329.99</b> |
|           | 2235TIMAX   | Air Wrench 1/2" Dr Short Anvil Titanium | <b>\$324.99</b> |

**FREE**  
**KOOZIE® 6 PACK COOLER WITH**  
**IR AIR TOOL PURCHASE!**

(While supplies last)



BCPC

### 3/4" Maximum Power Impact Air Wrench

- 3/4" Maximum Power Impact Air Wrench
- 1350 ft./lbs. maximum reverse torque from a tool that weighs just 7.4 lbs. and is compact enough to access tight spaces
- Built to last and designed to withstand tough use in rugged environments
- An air motor that's 16% more efficient than its predecessor and an easy-to-clean inlet screen means less down time, better tool performance, and less money spent on compressed air
- Torque Range: 200-900 ft./lbs.



| Ascot No. | McGee No.  | Description                                | Price           |
|-----------|------------|--|-----------------|
| 154-12145 | 2145QiMAX  | Standard Anvil                             | <b>\$529.99</b> |
| 154-22145 | 2145QiMAX3 | 3" Extended Anvil                          | <b>\$599.99</b> |
| 154-32145 | 2145QiMax6 | 6" Extended Anvil                          | <b>\$649.99</b> |
| 154-00261 | IR261      | HD 3/4" SD Wrench 1100 Ft/Lb Torq          | <b>\$509.99</b> |
| 154-02616 | 2616       | 3/4" Super Duty Air Impact w/6" Ext. Anvil | <b>\$579.99</b> |

### 1" Heavy Duty Air Impact Wrench

- Combines exceptional power, durability, and operator convenience
- Delivers 1450 ft./lbs. of maximum torque, with a 5000 RPM free speed and four-position power regulator
- 360° swivel inlet
- Available in 6" extended anvil and 6" extended #5 spline drive anvil for high production truck tire changing



155-02856

| Ascot No. | McGee No. | Description                | Price           |
|-----------|-----------|----------------------------|-----------------|
| 155-28560 | IR285B    | Standard Anvil             | <b>\$629.99</b> |
| 155-02856 | IR285B6   | 6" Extended Anvil          | <b>\$474.99</b> |
| 156-28566 | IR285BS6  | #5 Spline Super Duty Anvil | <b>\$584.99</b> |

 **Chicago Pneumatic**



Check out our **highlighted** blow out specials. Prices are **slashed** as they are a first come first serve basis for the last of these air tools from RPG! Don't miss out on savings and quality.

15617786 1" Spline, 15410261 3/4", & 15322131 1/2"

## 1/2" Drive Composite Impact Wrench

- Convenient one-hand operated forward/reverse push button
- Four-setting torque adjustment switch
- 685 ft./lbs., 8000 RPM, 4.2 lbs
- Twin hammer mechanism provides smooth balance
- Energy efficient motor for maximum performance with precise speed control
- Swivel air inlet prevents hose from twisting

Now with  
forward/  
reverse  
button!



153-12260

| Ascot No. | McGee No. | Description  | Price                                      |
|-----------|-----------|--|--|
| 153-12260 | A21312COM | 1/2" Drive Composite Impact Wrench 2" Extended Anvil | <b>\$134.99</b>                            |
| 153-22131 | 15322131  | 1/2" Drive Composite Impact Wrench Short Anvil       | <b><del>\$119.99</del><br/>NOW \$79.99</b> |

## 1" Drive Mini Air Impact Wrench

- 6" Extended Anvil
- Free speed: 5000 RPM
- Maximum torque: 2000 ft/lbs
- Only 20 lbs – 50% less than the market leading 1" product, smallest and lightest 1" in the tire service industry
- Twin hammer clutch



155-26464

**\$499.99**

| Ascot No. | McGee No. | Description   |
|-----------|-----------|---|
| 155-26464 | 15526464  | 1" Drive Mini Air Impact Wrench - 6" Extended Anvil |

- 6" extended anvil
- 3-position forward and reverse
- High efficiency 6-vane motor
- Pinless clutch mechanism
- Swoop back side handle for maneuverability/balance
- Working Torque 1,800-2,000
- Free Speed 5,000 RPM



| Ascot No  | McGee No | Description                 | Price           |
|-----------|----------|-----------------------------|-----------------|
| 155-12856 | A2856    | 1" Drive Super Duty Impact  | <b>\$399.99</b> |
| 156-12856 | A285SP6  | #5 Spline Super Duty Impact | <b>\$499.99</b> |

## Marvel Air Tool Oil

085 Marvel Air Tool Oil 32 Oz - 18100085 - **\$7.99**

- Prevents rust formation while providing positive lubrication for smooth starting and long tool life
- Assures maximum performance by dissolving gum and sludge that cut down tool speed and reduce power output



085

## Blaster 16ATC - Air Tool Conditioner

- Restores & prolongs tool life - 11 oz.
- Provides a coating & lubrication for tools while in use
- Inhibits rust, increases RPMGS for normal maintenance

16ATC  
181-00404

**\$6.79**

| Ascot #   | McGee # | Descriptions                      | Price         |
|-----------|---------|-----------------------------------|---------------|
| 395-00016 | 16CBD   | Blaster Citrus Degreaser - 11 oz. | <b>\$7.99</b> |



Video on proper air tool maintenance; make your tools last! (También en español)

<http://vimeo.com/212944966/>



## 1/2" Drive Super Duty Air Impact Wrench

- 2" extended anvil
- Handle exhaust
- Free speed: 8000 RPM
- Maximum torque: 600 ft./lbs.
- Proven design and the most popular configuration in the tire service industry
- Powered by the durable and high performing twin hammer mechanism
- Net weight: 5.6 lbs.

**\$119.99**



A2312G

Protect your investment  
with bootie JB04BLUE.

| Ascot No. | McGee No. | Description                                      |
|-----------|-----------|--|
| 153-33120 | A2312G    | 1/2" Drive Air Impact Wrench - 2" Extended Anvil |
| 153-33121 | 15323121  | 1/2" Drive Air Impact Wrench Short Anvil         |

## 3/4" Drive Impact Wrench

- Short anvil
- 6-position power setting
- Deliver 1100 ft./lbs. of maximum torque with 5500 rpm free speed
- The most powerful 3/4" drive classic wrench
- Suitable for tire or engine work on truck, bus or farm machinery
- Comparable to the IR261



154-10261

**~~\$399.99~~ - NOW \$249.99**

| Ascot No. | McGee No. | Description                          |
|-----------|-----------|--------------------------------------|
| 154-10261 | 15410261  | 3/4" Drive Short Shank Impact Wrench |

6" EXTENDED ANVIL

## 1" Drive Super Duty Impact Wrench



155-17786

**\$399.99!**

## Heavy Duty & High Torque!

15617786 – Spline drive version -

**~~\$469.99~~ - NOW \$299.99**

- DURABLE: Steel end plates offering durability and extended life
- ADVANCED DESIGN: Proven motor and hammer technology; highly efficient air motor
- WORKING TORQUE RANGE: 370-1475 ft./lbs.
- 1 YEAR LIMITED WARRANTY on parts and workmanship
- COMPARE to CP77826



## Super Red Pneumatic Air Tool Lubricant

- Dissolves gum and & varnish formation
- Ensures smoother starts
- Special rust & oxidation inhibitor
- Clean and free running
- 12 bottles per case
- Usable on piston or rotary type air tools

| Ascot #   | McGee # | Price         |
|-----------|---------|---------------|
| 181-00406 | 0406    | <b>\$6.54</b> |



JB04blue



175-10029  
Set of 6 Rotor Blades

175-13457  
Hammer Tune-Up Kit

## MC GEE STOCKS A FULL LINE OF 1/2" AND 1" DRIVE SOCKETS!

### 1" DR 10 Piece Truck Set

Contains the following sizes: 13/16" square, 1-1/16", 1-1/8", 1-1/4" thin wall deep, 1-1/2" controlled standard socket, 17mm & 21mm square with inside lip, 33mm, 35mm & 41mm deep

| Ascot No. | McGee No. | Price    |
|-----------|-----------|----------|
| 165-03110 | 3110      | \$199.95 |



### Popular Truck Sockets

1" DR Square Impact Sockets

| Ascot No. | McGee No. | Description           | Price   |
|-----------|-----------|-----------------------|---------|
| 165-03026 | 3026S     | 1" Dr. x 13/16 square | \$21.55 |
| 165-03030 | 3030S     | 1" Dr. x 15/16 square | \$24.70 |



### High Visibility Dual Color Leather Double Palm Gloves

Split leather double palm

- High visibility green and orange colors
- Half fleece lining
- 12 pairs per package

396-55223

\$4.00/pr



### RPG Mechanic's Gloves

Black synthetic leather palm with small patches

Features blue spandex on back, neoprene on knuckle, 4cm wide elastic, hook & loop

396-10011  
\$9.95



### Gemstone Protective Eyewear - Clear

Y19CFC - \$2.98 pr.



### Cotton Weave Blue Poly Palm Glove

C122 \$1.90/pr  
\$ .99/pr. per doz

### Micro Diamond Nitrile Gloves

- 100 per box
  - Texture Finish
  - 6 mil Thickness
  - Powder Free
- Call for current pricing and availability



| Ascot No. | McGee No.    | Size    | Color  |
|-----------|--------------|---------|--------|
| 396-00302 | 32806BK240R3 | Medium  | Black  |
| 396-00303 | 32806BK240R4 | Large   | Black  |
| 396-00304 | 32806BK240R5 | X-Large | Black  |
| 396-00402 | 32806OR240R3 | Medium  | Orange |
| 396-00403 | 32806OR240R4 | Large   | Orange |
| 396-00404 | 32806OR240R5 | X-Large | Orange |

### Half Size Flip Socket

- Set includes the sizes below:  
-18.5mm x 19.5mm; -21mm x 21.5mm;  
-21.5mm x 22.5mm; -22mm x 22.5mm - Extractor punch
- Made from durable chromoly steel
- Coated with a rust and corrosion resistant black oxide finish
- Sizes are laser etched on each socket

| Ascot No. | Mfg. No. |
|-----------|----------|
| 167-12051 | 000524   |

\$39.99



### 1/2" DR 13 Piece SAE Deep Set

- Contains the following sizes: 7/16", 1/2", 9/16" 5/8", 11/16", 3/4", 13/16", 7/8", 15/16", 1", 1-1/16", 1-1/8", 1-1/4"

| Ascot No. | McGee No. | Price   |
|-----------|-----------|---------|
| 163-01151 | 1151D     | \$99.95 |



### 1/2" DR 5 Piece Deep Thin Wall Flip Socket Set McGee #1205D

- Includes the following 1/2" drive deep thin wall flip sockets:
- 3/4" x 13/16"
- 19mm x 21mm
- 7/8" x 15/16"
- 17mm x 19mm
- 3" extension
- Packaged in a durable plastic blow molded case
- 17mm x 19mm flip socket for European applications
- Equivalent to Grey 1504FW but with an extra socket

| Ascot No. | McGee No. | Price   |
|-----------|-----------|---------|
| 167-12050 | 1205D     | \$39.95 |



### Locking Lug Master Key Set

The set was designed explicitly for the purpose of removing locking lug nuts on aftermarket wheels. The 16 piece set comes with both standard (SAE) and metric pieces that can be used on Spline, Star, Hex and Fluted Hex fasteners.

40201283 - \$89.00



### 1/2" DR Flip Socket Sale!

STD. "Flip" Socket & Metric "Flip" Socket

Double-end reversible impact socket. Fits passenger and light truck wheel nuts.



| Ascot #   | Part No. | Description                        | Price   |
|-----------|----------|------------------------------------|---------|
|           | 0703T    | 7/8" x 15/16" Deep Thin Wall       | \$11.76 |
|           | 1246D    | 3/4"-13/16" Deep                   | \$10.15 |
|           | 1246DT   | Extra thin 1246D                   | \$9.90  |
|           | 1249D    | 7/8"-15/16" Deep                   | \$10.57 |
|           | 1291D    | 19mm-21mm Deep                     | \$11.88 |
| 167-12912 | 1291DT   | Flip Thin 19mm and 21mm Thin, Deep | \$9.73  |

### 1/2" Dr. 4-Piece Flank Bite Damaged Nut Remover Socket Set

163-22219 - \$39.95

- New Flank Bite design works on up to an industry leading 90% rounded lug nut
- Also safe for forward tightening of lug nuts without damage
- Includes following sizes: 17mm, 19mm, 21mm, 22mm







1/8 - 16 Outer Cap Nut  
891RZ/892LZ



995LZ/RZ  
3/4 - 16 Super Single Cap Nut



269Z  
Flange Wheel Nuts



881M/333B  
Free Spinning Flange Nut  
2203/2304



3/4 - 16 Outer Cap Nut  
888RZ/889LZ



336RZ/337LZ - 13/16sq.  
Inner Nut for Steel/Aluminum  
Combination  
Longer Version - 621RY/622LY



708RZ/709LZ  
Grade 8.2 Inner  
Nut-Aluminum Wheels



988RZ/LZ - 13/16sq.  
Inner Cap Nut- Dual  
Aluminum Wheels

## BULK DISCOUNTS AVAILABLE!

| McGee No.                | Mfg. No. | Similar To:              |                   | Sale Price |
|--------------------------|----------|--------------------------|-------------------|------------|
| 891RZ (RH)               | GL-2001  | Budd-37891/2             | Euclid-5552-R/L   | \$1.16     |
| 892LZ (LH)               | GL-2002  | Nuturn-W-13/14           | Batco-13-3012-R/L | \$1.16     |
| 888RZ (RH)               | GL-2101  | Budd-37888/9             | Euclid-5652-R/L   | \$1.91     |
| 889LZ (LH)               | GL-2102  | Nuturn-W-15/16           | Batco-13-3013-R/L | \$1.91     |
| 995LZ (LH)               | GL-2103  | Alcoa-5554               | Euclid-5554-R/L   | \$5.48     |
| 995RZ (RH)               | GL-2104  | Budd-70613/4             |                   | \$5.48     |
| 269Z                     | GL-2202  | GMC-3771410              |                   | \$3.30     |
| 881M                     | GL-2302  | (1 1/2 Hex) M.W. 88881   |                   | \$4.97     |
| 333B                     | GL-2301  | (1 1/4 Hex) Budd 106333  |                   | \$2.61     |
| <b>Metric Outer Nuts</b> |          |                          |                   |            |
| GL2009                   | GL-2009  | Hino-9004-21112          | Isuzu-1-4233-023  | \$5.97     |
| GL2010                   | GL-2010  | (Inner Thread = M30-1.5) |                   | \$5.97     |

| McGee No.        | Mfg. No. | Similar To:                     |                   | Sale Price |
|------------------|----------|---------------------------------|-------------------|------------|
| 336RZ (RH)       | GL-1003  | Budd-35336/7                    | Euclid-5735 R/L   | \$3.68     |
| 337LZ (LH)       | GL-1004  | Nuturn-W107/108                 | Batco-13-3007-R/L | \$3.68     |
| 621RY (RH)       | GL-1005  | Budd-22621/2                    | Euclid-5568 R/L   | \$4.17     |
| 622LY (LH)       | GL-1006  | Nuturn-W105/106                 | Batco-13-3006-R/L | \$4.17     |
| 988RZ (RH)       | GL-1011  | Alcoa-5988-R/L                  | Nuturn-W-486/7    | \$4.17     |
| 988LZ (LH)       | GL-1012  | Euclid - 5988-R/L               | Batco 13-3026-R/L | \$4.17     |
| <b>Grade 8.2</b> |          |                                 |                   |            |
| 708RZ (RH)       | GL-1001  | Euclid-7895R/L                  | Budd-10708/9      | \$1.87     |
| 709LZ (LH)       | GL-1002  | BWP-M128/9                      | Batco-13-3032R/L  | \$1.87     |
| <b>Metric</b>    |          |                                 |                   |            |
| GL1009 (RH)      | GL-1009  | Hino-9004-23101                 | Isuzu-1-42335-005 | \$7.91     |
| GL1010 (LH)      | GL-1010  | (M20 Inner & M30 Outer Threads) |                   | \$7.91     |

## Hub-Centric Wheel Nuts - The Original! - High Quality - Skirt Nut

By filling the void between the stud hole, "clocking" is eliminated, and problems caused by clocking, such as wheel offs and wheel hub vibrations, are eliminated.

- Hub Centric Nut fills void standard flange nuts don't
- Stops rim from shifting forwards or backwards
- Eliminates "clocking" caused by standard wheel nuts not filling wheel hole completely
- Certified American Steel
- Each part tested for thread, fit and finish
- 50 per box

Wheel Assembly with  
Standard Nut

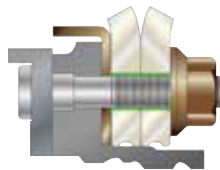

Void (Highlighted in  
Green) between stud  
and hole.

Wheel Assembly with  
Hub Centric Nut

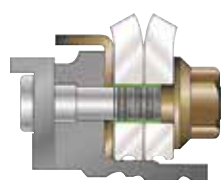

Hub centric nut fills void  
between stud and hole.



1) YELLOW  
HIGHLIGHT  
shows void  
between stud  
and stud hole.

2) Hub Centric  
Nut fills void  
between stud  
and hole.



Made in USA

| Ascot No. | Description             |                             |
|-----------|-------------------------|-----------------------------|
| 491-00133 | 33mm Hex X 1.5mm Thread | <b>49100133<br/>\$10.44</b> |

Other Sizes Available

Extended threading allowing Skirt Nut to go down into Hub-Piloted Disc Wheel an extra 3/16" (5mm) into stud hole



| Ascot No. | Mfg. No.           | Description  |  | Price          |
|-----------|--------------------|--|--|----------------|
| 491-02906 | GL-2906<br>333SN6  | <b>Haltec 6mm Sleeve Nut</b><br>• Steel Steers   |  | <b>\$10.19</b> |
| 491-02919 | GL-2919<br>333SN19 | <b>Haltec 19mm Sleeve Nut</b><br>• Aluminum Steers<br>• Steel/Steel Drives<br>• Steel Outer/Aluminum Inner Drives      |  | <b>\$12.52</b> |
| 491-02928 | GL-2928<br>333SN28 | <b>Haltec 28mm Sleeve Nut</b><br>• HD Aluminum<br>• Super Single<br>• Wide Base<br>• Aluminum Outer/Steel Inner Drives |  | <b>\$13.28</b> |
| 491-02939 | GL-2939<br>333SN39 | <b>Haltec 39mm Sleeve Nut</b><br>• Dual Aluminum Drive Axle  |  | <b>\$13.56</b> |

## Nut Loosener Penetrating Blaster - 16PB

A penetrating lubricant that frees everything! Displace moisture by saturating troubled area and allow to stand for a few minutes. 12.2 oz. spray.



#606 Oil Can  
**\$15.85**

**\$6.45 ea.**



## 3-Piece Twist Socket Lug Nut Removal System

- Removal of damaged 3/4" and 19mm, 13/16" and 21mm lug nuts
- Two dual-sided twist sockets have a fluted design which gives the sockets a tight grip to remove the most difficult locking and damaged lug nuts from the socket
- Works with 1/2" impact gun or breaker bar for service calls
- Includes an extrator punch



**\$59.77**

Due to global commodity price increases, shipping delays with container availability and getting through the ports, McGee Company cannot guarantee pricing or availability on items. We have done the best we can to increase stock to meet demand. For more info, see inside cover.



### Truck Wheel Dolly



- Easily handles new super wide tires that are becoming prevalent in the trucking industry.
- Provides technician with the leverage needed to handle the removal and installation of large tires
- Heavy duty tubular steel construction
- Bent handle design improves leverage and reduces user strain
- 14" rollers turn and pivot for accurate & efficient alignment of mounted truck tires with hub stud
- 26" wide carriage handles tire diameters 36"- 48"; 450 lb. capacity

| Ascot No. | McGee No. | Description | Price           |
|-----------|-----------|-------------|-----------------|
| 407-70130 | AFF3591   | Truck       | <b>\$112.44</b> |

BJT300A for 19.5-24.5" Wheels

### 3-1/2 Ton Professional Heavy Duty Double-Pumper Floor Jack

**Model 350SS - \$399.99**

This unit offers all the features of our model 350GT with additional speed and efficiency thanks to AFF's double-pumper advantage for quicker lifting.

- Lifts from 4" to 19-1/2"
- Pinned steel saddle (1-1/8" stud) with rubber pad for added vehicle protection
- Rear-mounted 2-3/4" swivel casters for ease of maneuverability
- One-piece 50-1/4" padded handle parks upright
- Ship weight 119 lbs.



Replacement Power unit **350SSKHU - \$141.56**



**Ask us about our no mar options!**

### 20-Ton 72090A

INTENDED USE: Heavy duty truck, agricultural and heavy construction equipment. Ideal for loaded truck and trailer roadside service calls.

- Its light weight makes it perfect for mobile repair service.
- Long handle with 36-1/2" reach helps in positioning jack under vehicles with low overhang.
- Parkerized coating on pump piston, extension screw and extension adapters and chrome coated ram offer protection against rust.
- Removable extension screw with two 4" extension adapters (included) for added height.
- Self-retracting ram eliminates manual lowering.
- 5 1/4" diameter high impact composite wheels make maneuverability easy.
- Fast efficient air pump reduces lifting time and has a built-in relief mechanism which prevents the jack from being used beyond its maximum allowable capacity.
- Convenient push button air valve connected to an in-line filter prohibits contaminants from entering the air/hydraulic system.

|                  |        |                 |                |
|------------------|--------|-----------------|----------------|
| Low Lift Height  | 8.625" | Base Size       | 9.25" x 17.25" |
| High Lift Height | 22.75" | P.S.I. Range    | 100-130        |
| Stroke           | 4.125" | Shipping Weight | 63 lbs.        |
| Screw Extension  | 2"     |                 |                |



**Please call for pricing and availability**

### Bottle Jacks

- Extension screw on some models
- Rust protection covering
- Uniweld construction
- 50% overload factor
- Fewer moving parts

**ZN12 12-Ton.....\$119.78**

**ZN22 22-Ton.....\$178.32**



### 22 Ton Jack Stand 6522

- Sold individually, 22 ton capacity when used in pairs
- Ideal for supporting trucks, trailers and equipment in industrial, agricultural, construction and industrial work environments
- Large v-shaped saddle allows better contact with the load
- Pin style design provides maximum security even under the heaviest loads
- Adjusts to four positions from 12" to 20"



**\$199.99**

### 20 Ton Capacity Air/Hydraulic Super Duty Bottle Jack

- AFF's most innovative and robust air/hydraulic bottle jack to date
- Redesigned air motor
- Super thick base to increase stability on every surface
- High-strength Steel Ram and cylinder with long ram guide for greater safety in off-center load conditions
- Welded Tank (threaded and screwed to the base) endures the rigors of in-service conditions and reduces risk of tilting out of the oil reservoir



|             |        |         |          |
|-------------|--------|---------|----------|
| Low         | 10.375 | Lift    | 6.375    |
| High        | 20.625 | Base    | 5.75 x 9 |
| Ship weight |        | 45 lbs. |          |

|        |                    |                 |
|--------|--------------------|-----------------|
| 5620SD | 20-ton standard    | <b>\$324.99</b> |
| 5621SD | Low profile design | <b>\$299.99</b> |
| 5630SD | 30-ton super duty  | <b>\$439.99</b> |
| 76320B | 20-ton Norco       | <b>\$329.99</b> |



**Jack Oil  
HF100**

**\$7.34 Qt.**

### 22 Ton Air/Hyd Axle Jack with 3pc Ext Kit

**New 565F from AFF - Now with reinforced frame**

Call for availability and pricing

**72200D from Norco - Call for availability and pricing**

**Omega 23221C \$669.99**

- Quick rated capacity lift using air-actuated operation
- User friendly, self-returning spring minimizes operators effort, greatly reducing fatigue
- Inline air filter traps contaminants and protects air motor for longer life
- U.S. patented built-in by-pass device protects hydraulic system from over pumping damage
- One year limited warranty

| Capacity | Height min/max | Ext Screw | Handle Length | Ship Weight |
|----------|----------------|-----------|---------------|-------------|
| 22 ton   | 10/18.5"       | 3.88"     | 47.38"        | 99.44 lbs   |

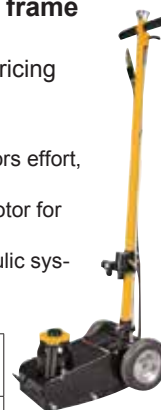

### 400SS 4 Ton HD Floor Jack \$399.99

- Twin hydraulic system for fast and efficient lifting
- Heavy duty pump, ram, and cylinders are precision machined and inspected to ensure long service life
- High grade U-cups seals and high-pressure plunger for maximum performance
- Rear mounted swivel casters for easy maneuverability
- Universal joint technology provides a more controlled descent
- Pinned and padded saddle for extra vehicle protection
- Flanged side plates for increased stability
- Integrated parts tray keeps small components from getting lost



\*PRICING SUBJECT TO CHANGE DUE TO STEEL SURCHARGES



## 30251005 10-Ton High Jack Stands (pair)

- Pin-style stands with supporting range from 27.95" to 47.56" suitable for high-height applications
- HD tubular steel design provides stability and rigidity
- Multiple pin holes to allow easy adjustments
- Saddle with lugs for easy positioning of the load

**\$387.99**



## 22-Ton Jack Stands

- Sturdy, welded steel construction for exceptional safety and strength
- Heavy gauge steel helps prevent distortion or twisting
- Multi-position column bar for convenient height adjustment
- Sold in set of two



**30263220 \$234.99**

## 20-Ton Air Bottle Jack

- Welded cylinder and reservoir for added strength and durability
- Chrome plated rams to resist rust and wear
- Built in bypass device to protect hydraulic system from over-pumping damage
- Self-returning spring for ease of operation
- Built-in muffler to promote quiet operation and air filter for extended motor life
- High speed turbo motor for efficient, effortless operation
- 1/4" quick connect feature allows for ease of mobility and remote operation



Shorty - Compare to Shinn Fu 18209

**30161207 \$297.99**

| Ascot No. | McGee No. | Capacity | Min Height | Max Height | Handle Length | Overall Length | Overall Width | Saddle Diameter |
|-----------|-----------|----------|------------|------------|---------------|----------------|---------------|-----------------|
| 301-61204 | 30161204  | 20 tons  | 7 1/8"     | 12 5/8"    | 18 7/8"       | 7 1/2"         | 5 1/8"        | 1 3/4"          |
| 301-61200 | 30161200  | 20 tons  | 10 1/2"    | 20 1/2"    | 18 7/8"       | 7 1/2"         | 5 1/8"        | 1 3/4"          |
| 391-61124 | 39161124  | 12 Tons  | 6 3/4"     | 13 3/8"    | 18 7/8"       | 6 1/2"         | 4 3/8"        | 1 1/2"          |
| 301-61120 | 30161120  | 12 Tons  | 9 3/8"     | 18 5/8"    | 18 7/8"       | 6 1/2"         | 4 3/8"        | 1 1/2"          |
| 301-61206 | 30161206  | 20 tons  | 10 1/2"    | 20 1/2"    | 18 7/8"       | 9 1/4"         | 6 7/8"        | 1 3/4"          |
| 301-61207 | 30161207  | 20 tons  | 8 1/4"     | 15 1/2"    | 18 7/8"       | 9 1/4"         | 6 7/8"        | 1 3/4"          |

## Blow Out Specials!\*



**20-Ton Welded Inline Bottle Jack**

**30161200 \$99.99**



**20-Ton Short Welded Inline Bottle Jack**

**30161204 \$99.99**

**30161124 \$109.99**



**12-Ton Welded Inline Bottle Jack**

**30161120 \$54.99**



**20-Ton Air Bottle Jack**

**30161206 \$119.99**

\*While supplies last



**Basic Jack Maintenance**

**RPG™**  
**ASK US ABOUT OUR TRANSMISSION AND UNDER HOIST JACKS TODAY!**  
**1-800-525-8888**

## 3.5 Ton Service Jack

- Patent pending Air-Breather for pressure balance for optimum jack performance
- Safety bypass system for cylinder protection
- Industrial grade casters for easier transportation
- Heavy duty chassis for increased strength and durability
- Bolt-on reinforced and heavy duty lift arm axle
- Universal joint mechanism
- Sturdy, one-piece handle
- Foam handle for vehicle protection
- Protective saddle pad to prevent damage to the vehicle



| Version     | McGee #  | Price           |
|-------------|----------|-----------------|
| Traditional | 30262035 | <b>\$349.99</b> |

| Capacity | Min. Height | Max. Height | Handle Length | Overall Length | Saddle Diam. | Ship Weight |
|----------|-------------|-------------|---------------|----------------|--------------|-------------|
| 3.5 Ton  | 3.75"       | 21.75"      | 50.5"         | 31.125"        | 4.2"         | 107 Lbs     |

## Accessories for 3.5 Ton Service Jacks



*Coated Wheels*

| Ascot No  | McGee No  | Description                          |
|-----------|-----------|--------------------------------------|
| 302-62351 | 620351    | Front wheel assembly                 |
| 302-62359 | 620359    | Rear caster assembly                 |
| 302-62375 | 6203513PU | Coated wheels and casters - set of 4 |
| 302-62357 | 30262357  | Replacement power unit               |

## 3-Ton Jack Stands

- Ratchet height adjustment built within column
- Multi-level ductile iron ratchet bar adds strength and durability
- Sold in set of two



**3-Ton – 30263030 \$37.99**

**6-Ton – 30263060 \$77.99**

## 2-Ton Service Jack

- True "low-profile" design with deep reach and minimum 2.75" height for low clearance vehicles
- Universal joint mechanism
- Foam handle for vehicle protection
- Industrial grade casters for easy transport
- Safety bypass system for cylinder protection
- 24" max height for increased work space



**30262021 \$299.99 Low profile design!**

## Heavy Duty Truck Lock

### FLEET OWNERS AND OPERATORS:

### Wheel & tire theft is one thing you can't afford

For less than the cost of one tire, you can protect a complete Tractor and Trailer and avoid:



- Increased insurance costs
- Scheduling and delivery delays
- Additional expenses for downtime
- thousands of dollars in stolen equipment
- Loss of perishable load
- Lost business
- Possible vehicle damage

### Your answer to around the clock wheel & tire security is McGard

Wheel locks are easy to install and very effective as a theft deterrent. Simply replace one lug on each wheel for disc styles, and two for spoke. There are no moving parts to corrode or jam. Each lock has a specially coded pattern milled into it that engages with the corresponding pattern on the key/adaptor tool. McGard offers a wide range of key patterns for added security and your fleet's pattern will be registered with us to make ordering additional locks or keys quick & easy.



#### Metric Hub Mounted Disc Wheel Lock

|                       |   |                        |                 |
|-----------------------|---|------------------------|-----------------|
| Part Number:<br>52003 | Wheel lock set for metric hub mounted disc wheels. Set includes 10 locks & 2 keys. Application-tandem axle tractor & tandem axle trailer. | Thread:<br>22mm x 1.5. | <b>\$246.43</b> |
|-----------------------|---|------------------------|-----------------|

#### Mounted Disc Wheel Lock

|                       |   |                        |                 |
|-----------------------|---|------------------------|-----------------|
| Part Number:<br>52004 | Wheel lock set for metric hub mounted disc wheels. Set includes 6 locks & 2 keys. Application-tandem axle tractor or single axle tractor and single axle trailer. | Thread:<br>22mm x 1.5. | <b>\$163.24</b> |
|-----------------------|---|------------------------|-----------------|

## Split-Beam Click Torque Wrenches

**PRECISION INSTRUMENTS**

- Extremely accurate: within 4% of reading from 20% of full scale to full scale
- Setting torque on adjustable wrenches is fast and easy because there is no spring tension on the adjustment knob
- Torque setting locks on adjustable wrenches for repetitive applications
- Wrench length designed to provide the leverage required for maximum torque applications. Also provides the needed reach for those hard to get at places.

EXTREMELY ACCURATE



Made in USA



| Ascot No.                                  | Part No. | Description | Ft./Lbs. | Price           |
|--|----------|-------------|----------|-----------------|
| 168-03250                                  | C3FR250F | 1/2" Drive  | 250      | <b>\$218.76</b> |
| 168-05600                                  | C5D600F  | 1" Drive    | 600      | <b>\$498.00</b> |
| Generic Ascot Torque Wrench-made in Taiwan |          |             |          |                 |
| 168-00250                                  | -        | 1/2" Drive  | 250      | <b>\$179.13</b> |

## Micro-Adjustable Torque Wrench

**Now! \$189.95**

- Dual scale, calibrated dual direction
- Positive lock with spring loaded pull down lock ring
- Fast, accurate and easy to set
- Easy-to-read laser marked scale
- Ergonomic comfort-grip
- Most feature quick release buttons which provide good socket retention as well as easy socket removal
- Range: 50-250 ft./lbs.
- Accuracy:  $\pm 4\%$  clockwise  $\pm 6\%$  CCW of indicated value, CW, from 20% to 100% of full scale

DUAL SCALE



| Ascot No. | Description                               |
|-----------|---|
| 168-12250 | 1/2" Drive Micro-Adjustable Torque Wrench |

CALIBRATED DUAL DIRECTION

## Flex Hinge Torque Wrench

- 168-60011
- Robust construction
- Accurate results  $\pm 4\%$
- Adjustable torque settings
- Dual scaled, Ft./Lbs. & N.m.
- Durable storage case
- Every wrench is supplied with calibration certificate
- 2 adapters included: 3/4" to 1"; 3/4 to 3/4"
- Similar to Norbar 12007 & 12007.01



**\$399.95**



Made in Taiwan

## Heavy Duty Truck Torque Wrench

**168-12017 4AR1- \$529.57**



- Robust construction gives accurate results to  $\pm 4\%$  even in arduous work conditions
- Supplied with a calibration certificate
- Break back action gives an unmistakable signal
- Break angle improves accuracy by reducing the possibility of overtorquing
- Dual scaled, Nm and ft./lbs.
- New handle - more comfortable and guides operator's hand to correct position
- Now split for ease of transportation and storage

**169-03013 - 1" Female x 13" Socket Extension!**

**03013 - \$59.28**



# TIRE VALVE TOOLS

23



| Ascot No. | McGee No. | Description   | Price          |
|-----------|-----------|---|----------------|
| 469-52000 | 52000     | Valvecapper is 11.5" long-designed to reach the inner valve on dual wheel. One end is for the removal/ installation of valve caps and the other end is removal/installation of the core | <b>\$15.95</b> |
| 469-00011 | TL645     | Cable Valve Fishing Tool. Valve core wrench and deflating pin with flexible cable for fishing valve through rim hole. 24"   | <b>\$1.92</b>  |

## Valve and Core Tools



| Ascot No. | McGee No. | Description  | Price          |
|-----------|-----------|--|----------------|
| 469-00992 | 610       | Tubeless Tire and Tire Valve Inserting and Removing Tool. For all sizes of snap-in passenger car tire valves | <b>\$8.97</b>  |
| 469-43002 | 43002     | Plastic Valve Puller   | <b>\$10.95</b> |
| 469-00014 | -         | Install/Remove Removal Tool. Rubber block adds leverage  | <b>\$9.95</b>  |

## Core Tools

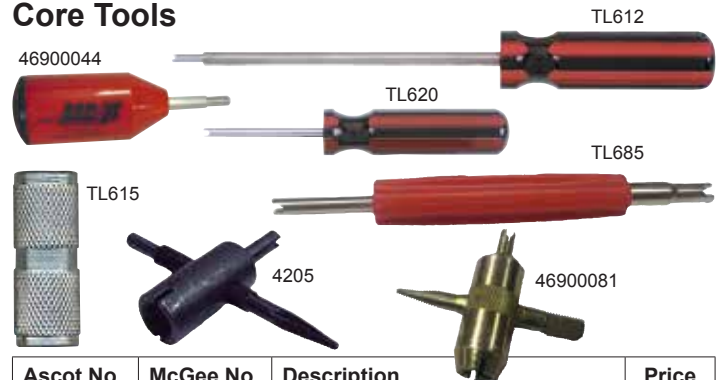

| Ascot No. | McGee No. | Description                    | Price          |
|-----------|-----------|--------------------------------|----------------|
| 469-00612 | TL612     | Standard Core Tool 8"          | -              |
| 469-00021 | TL615     | Standard Deflator Core Remover | <b>\$1.20</b>  |
| 469-00607 | TL620     | Core Tool Screwdriver Handle   | -              |
| 469-00005 | TL685     | Standard and L/B Core Tool     | <b>\$2.25</b>  |
| 469-00002 | 4205      | 4 Way Tool Steel               | <b>\$4.95</b>  |
| 469-00044 | 46900044  | Core Torque Tool               | <b>\$21.02</b> |
| 469-00081 | 46900081  | 4 WayTool - "The Best"         | <b>\$5.00</b>  |

## Valve Stem Ratchet Wrenches



| Ascot No. | McGee No. | Description   | Price          |
|-----------|-----------|---|----------------|
| 469-00018 | VSW18     | For TR570 series valves                                       | <b>\$14.95</b> |
| 469-00020 | VSW20     | For TR540 & TR550 series valves                               | <b>\$16.95</b> |
| 168-00058 |           | 5/8" Preset Torque Wrench for TR540-550 Series Valve Hex Nuts | <b>\$49.45</b> |
| 168-00916 |           | 9/16" Preset Torque Wrench for TR570 Series Valve Hex Nuts    | <b>\$49.45</b> |

## TIRE INFLATION SYSTEMS



Used with AB100

Auto Inflators save time and money. Proper inflation creates longer tire wear and increased fuel mileage. These self-calibrating units are accurate to +/- .03 psi. Can be used as a reference point to calibrate hand held gauges.

Allows remote control of the inflation process, allowing the technician to avoid the "blast zone" during inflation.

**Let us design a custom installation for your shop**



Used with AB200



**FLEET SOLUTIONS FROM  
McGEE COMPANY**



**PRECISION  
INFLATION  
SYSTEM**

AB200-Dual control, dual tire self-calibrating automatic inflation  
AB100-Single control unit dual tire self-calibrating automatic inflation

**Dill – OE - Snap-In Tubeless Tire Valves**

Made with special rubber compound to resist ozone damage and prevent premature deterioration caused by rim hole compression, heat, cold. Maximum inflation pressure is 65 P.S.I.

| Valve Hole | McGee No. | Effective Length | Standard Pack Box | 50 Pk Price   |
|------------|-----------|------------------|-------------------|---------------|
| .453       | TR412     | 7/8"             | 500               | <b>\$ .33</b> |
| .453"      | TR413     | 1 1/4"           | 500               | <b>\$ .33</b> |
| .453"      | TR414     | 1 1/2"           | 500               | <b>\$ .40</b> |
| .453"      | TR423     | 2 1/2"           | 500               | <b>\$ .60</b> |
| .453"      | TR418     | 2"               | 500               | <b>\$ .48</b> |
| .625"      | TR415     | 1 1/2"           | 500               | <b>\$ .45</b> |
| .625"      | TR425     | 2"               | 500               | <b>\$ .75</b> |

Special prices on boxes of 500 each.



413 414 418 423 415 425



Machine Year Month Day

Snap-in tire valves have become a commodity even though they are critical in maintaining the correct tire pressure. As questions arise regarding the life of rubber components and as an effort to provide traceability for this product line, Dill provides a solution! Each Dill stem has the production data etched on it!

**Chrome-Sleeve Snap-in Type Tubeless Tire Valves**

**Now! Economical Asian stems TR413IV – \$.17 ea.**

**TR418IV - \$.31 ea.**

**High Pressure Snap-In Valves — Dill OE**

- Tubeless snap-in type valves for high pressure applications
- Maximum cold inflation pressure is 100 psi
- For .453" or .625" rim holes
- Do not use on tire rims that exceed .205" in thickness



| Ascot No. | TR No.  | Eff. Length | Valve Hole Dia. | Sale Price    |
|-----------|---------|-------------|-----------------|---------------|
| 461-00600 | TR600HP | 1.27"       | .453"           | <b>\$ .79</b> |
| 461-00602 | TR602HP | 2"          | .453"           | <b>\$ .89</b> |
| 461-00801 | TR801HP | 1.25"       | .625"           | <b>\$ .89</b> |
| 461-00802 | TR802HP | 2"          | .625"           | <b>\$1.09</b> |

TR600HPV import - 100 each - **\$ .32 ea**

**Chrome Hi-Performance Valve****Perfect for Custom Wheels**

Chrome plated valve and sealing cap. Especially suited to custom wheels. Includes grommets for .453" and .625" passenger car wheels.

**\$1.09 ea.**

**Radial Commander Valve For 15° Disc Wheels**

- 23° bend clamp-down valve for .625" valve hole
- Bend allows clearance of brake drum for tire service **\$1.96 ea.**

| Ascot No. | Part No. | Description                 |
|-----------|----------|-----------------------------|
| 462-01147 | N1147    | Radial Commander Valve Dill |

**Quality**

Quality snap-in valve stems are made with EPDM synthetic rubber rather than natural rubber to meet SAE ozone requirements. EPDM rubber also has a broader temperature range than natural rubber and will remain flexible in extremely cold weather.

Good quality valve stems conform to SAE J1205 - J1206 standards setting performance criteria for heat resistance, aging and ozone resistance



Weathered Valve

**Caution: For maximum rim thickness of .205 (13/64"). Not to be used with metal valve extensions.**

Maximum air pressure 80 psi. Light truck replacement valve.

**Enkei Valves**

- A high performance "No Show" type chrome plated valve that installs from the outside
- A rubber washer and nut are on the inside
- Fits .453" diameter hole



| Ascot No. | McGee No. | Description             | Price         |
|-----------|-----------|-------------------------|---------------|
| 462-06010 | TR6010    | 3/4" Length, Standard   | <b>\$1.99</b> |
| 462-06020 | TR6020    | Bent at 45° Angle       | <b>\$2.10</b> |
| 462-06030 | TR6030    | 1-1/4" Length, Standard | <b>\$2.70</b> |
| 462-06040 | TR6040    | 1-3/4" Length, Standard | <b>\$4.71</b> |

*Quality valves assure trouble free service!*

**TR416 Clamp-In Tubeless Tire Valves**

- Nickel plated metal valves can be installed in all passenger cars, light trucks and industrial rims with .453" or .625" valve holes
- Rubber grommet forms a seal when valve is clamped to rim by tightening hex nut
- Maximum inflation pressure is 130 psi
- Includes 2 rubber grommets

| Ascot No. | McGee No.     | Eff. Length | Price         |
|-----------|---------------|-------------|---------------|
| 462-00416 | TR416 (3640)  | 1-1/4"      | <b>\$1.09</b> |
| 461-01416 | TR416L (3641) | 2"          | <b>\$1.19</b> |

3640 - 1 1/4"





## Bead Bazooka

- Ultra compact design for fitting in truck cabinets
- More powerful than previous design



| Ascot No. | Description                     | Price    |
|-----------|---------------------------------|----------|
| 473-00103 | 3 Liter Cars & SUV Tires        | \$299.95 |
| 473-00106 | 6 Liter Car & Commercial Tires  | \$338.00 |
| 473-00110 | 10 Liter Car & Commercial Tires | \$399.00 |

## 5-Gallon Bead Seater

- 5-gallon capacity
- Equipped with a butterfly valve for maximum air discharge
- Designed for commercial use on large truck tires, passenger and ATV tires to 24.5"
- Made in Taiwan
- Parts interchangeable with CH5



473-01500  
5-Gallon Bead Seater

\$149.99

RPG05GALAL - Aluminum version - \$218.80  
RPG05GALED - \$199.95

- Steel tank
- 5-Gallon capacity
- End discharge with flared barrel
- Equipped with a butterfly valve for maximum air discharge
- Designed for commercial use on large truck tires, passenger and ATV tires to 24.5"
- Made in Taiwan



RPG05GALED

## 5-Gallon Cheetah Bead Seater

473-00500 CH5

- Makes seating the most difficult bead safe, simple
- 5-gallon capacity
- Designed for commercial use on large truck tires, passenger and ATV tires to 24.5"
- Fill tank from any service station chuck or service truck air compressor
- Made in Taiwan



\$179.95

## Dual Foot Air Chucks

| Ascot No. | McGee No. | Description  | Price   |
|-----------|-----------|--|---------|
| 478-01350 | CH350LO   | Straight-On/Angled Chuck. Protective Black Epoxy Finish (Normally Closed)        | \$12.43 |
| 478-00335 | CH335     | Angled Chuck. Plated Finish (Normally Closed)                                    | \$8.40  |
| 478-03300 | CH330LO   | Straight-On/Angled Chuck. With Lock-On Threads (Normally Closed)                 | \$9.06  |
| 478-03301 | CH330     | Straight-On/Angled Chuck (Normally Closed)                                       | \$7.15  |
| 478-03330 | CH333LO   | Straight-On/Angled Chuck. 14" Long (Normally Closed)                             | \$11.27 |
| 478-06172 | 6172USA   | Angle Chuck for Inner Dual Wheels with Tilted Valves - 6" Chrome                 | \$5.70  |
| 478-06174 | 6174USA   | Extra Long Length Lock Feature Straight and 30° Reverse Angle Chuck - 14" Chrome | \$10.62 |
| 478-06175 | 6175USA   | Lock Feature Straight-On 30° Reverse Angle Chuck - 6" Chrome                     | \$7.82  |
| 478-06999 | 6999USA   | Straight with 30° Reverse Angle Chuck - 6" Chrome                                | \$6.45  |
| 478-16999 | 6999LUSA  | Same as 6999USA Except for Lock-On - 6" Chrome                                   | \$6.50  |



478-00335

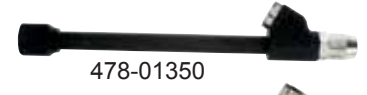

478-01350



478-03300

## Ball Foot Chucks

| Ascot No. | McGee No. | Description   | Price  |
|-----------|-----------|---|--------|
| 478-00335 | 5499      | Ball Foot Chuck. 1/4" Female Thread (Normally Closed)                   | \$4.23 |
| 478-00315 | 5567      | Ball Foot Chuck With Lock-on Clip. 1/4" Female Thread (Normally Closed) | \$6.90 |



478-00315

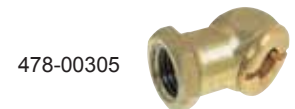

478-00305

## European-Style Clip-On Chucks

| Ascot No. | McGee No. | Description   | Price   |
|-----------|-----------|---|---------|
| 478-02985 | CH360     | European-Style Clip-On Chuck. 1/4" Female Fitting. Silver Clip. (Normally Closed).          | \$12.67 |
| 478-02995 | CH360OP   | European-Style Clip-On Chuck. 1/4" Female Fitting. Black Clip. (Normally Open).             | \$10.00 |
| 478-01200 | N1200     | European-Style Clip-On Chuck. Serrated Shank for 1/4" I.D. Hose. Silver. (Normally Closed). | \$8.00  |



Made in the USA

478-01200



478-02985



| McGee No. | Description   | Price  |
|-----------|---|--------|
| 6293DUSA  | European-Style Clip-On Chuck, 1/4" Female Fitting. Silver Clip. (Normally Closed). (CH360) - Dill | \$7.60 |
| 6293EUSA  | European-Style Clip-On Chuck. 1/4" Female Fitting. Black Clip. (Normally Open). (CH360001) - Dill | \$7.64 |

## Lock On Air Chucks

| Ascot No. | McGee No. | Description  | Price   |
|-----------|-----------|--|---------|
| 478-05265 | 5265SH    | Lock-On Air Chuck. Specially Designed To Lock Onto The Cap Of A Standard Bore Valve Stem When The Sliding Sleeve Is Pushed To Forward Position | \$12.00 |



\$12.00

## Closed vs Open Air Chucks

Did you know?

Closed air chucks are used for multi-tire inflators and nitrogen generators since air flow begins with contact to the valve core.

Open air chucks are used for inflation gauges and tire changers since air flow is controlled before reaching the chuck.



| Ascot No. | McGee No. | Description                              | Finish  | Price          |
|-----------|-----------|--|---------|----------------|
| 46805005  | 635       | TPMS Black Plastic Cap Long Skirt Bx/100 |         | <b>\$23.00</b> |
| 46800660  | 660V      | Standard Black Plastic Valve Cap (100)   | Plastic | <b>\$2.11</b>  |

| Ascot No. | Mfg. No. | Operating Pressure Range                        | Operating Pressure | Price          |
|-----------|----------|---|--------------------|----------------|
| 468-05405 | 5405V    | 0-200 PSI-Peaks of 300 (100)                    | 90 PSIG            | <b>\$10.99</b> |
| 468-20055 | SH20055  | TPMS Electroless Valve Core Nickel Plated (100) |                    | <b>\$12.00</b> |

| Ascot No. | Mfg. No. | Description                   | TR No. | Operating Pressure | Finish        | Price          |
|-----------|----------|-------------------------------|--------|--------------------|---------------|----------------|
| 468-07572 | 7572V    | Dome-Shaped Top & Guide (100) | VC3    | 0-200 PSI          | Nickel Plated | <b>\$14.95</b> |
| 468-20495 | SH20495  | TPMS Alum Valve Cap Bx/100    |        |                    |               | <b>\$25.83</b> |

## Green Valve Caps for Nitrogen Inflated Tires



| Ascot No. | McGee No. | Description                           | Price          |
|-----------|-----------|---------------------------------------|----------------|
| 46800207  | 46800207  | Green Plastic Nitrogen Cap (100/bx)   | <b>\$4.17</b>  |
| --        | 590021    | Chrome Nitrogen Valve Cap (100/box)   | <b>\$40.15</b> |
| --        | 590019    | Aluminum Nitrogen Valve Cap (100/box) | <b>\$40.15</b> |

Use chrome caps on brass stems only and aluminum caps on aluminum stems



## Tire Tread Depth Gauges



| Ascot No.  | McGee No. | Description   | Price         |
|------------|-----------|---|---------------|
| 454-00599  | 595TM     | Tire Tread Depth Gauge. Used to measure tire tread depth in 1/32" increments  | <b>\$3.20</b> |
| 454-015124 | 5124      | Red-Yellow-Green Tread Depth Gauge: Allows your customer to visually display when tires should be replaced due to tread wear. | <b>\$3.44</b> |
| 454-00712  | NS712     | Metal Case 595TM - Aluminum Stem  | <b>\$3.40</b> |

## Double Seal Cap



- Reduce pressure check time by 65%
- Designed for high pressure truck tire service
- Inflate, deflate or gauge directly thru the DS-1 saving time during inflation and pressure checks

Now approved by UPS and Ryder

Visit McGee resource page for details or link at:



| Ascot #   | McGee # | Description               | Price         |
|-----------|---------|---------------------------|---------------|
| 468-04191 | DS1     | Double Seal Cap - Haltec  | <b>\$.79</b>  |
| 468-02222 | AE1     | Alligator Double Seal Cap | <b>\$ .89</b> |

## Couplers & Nipples

- Steel plated couplers with hardened steel balls and stainless steel springs
- Plugs heat-treated to reduce wear on critical mating surfaces
- Interchange with Tru-Flate 10 and 100 type series as well as units produced by other manufacturers
- Maximum working pressure 300 psi.



## Automotive Series

| Ascot #              | Dill No. | Milton No. | Amflo No. | McGee No. | Thread | NPT  | Price         |
|----------------------|----------|------------|-----------|-----------|--------|------|---------------|
| <b>COUPLERS</b>      |          |            |           |           |        |      |               |
| 131-61523            | D-13     | 785        | C2        | 3504      | Female | 1/4" | <b>\$4.71</b> |
| 131-61524            | D-12     | 786        | C1        | 3503      | Male   | 1/4" | <b>\$7.63</b> |
| 131-62523            | D13R     | --         | --        | 3505      | Female | 1/4" | <b>\$5.51</b> |
| <b>ADAPTER PLUGS</b> |          |            |           |           |        |      |               |
| 131-61539            | D-3C     | 784        | CP2       | 3507      | Female | 1/4" | <b>\$1.58</b> |
| 131-61538            | D-2C     | 783        | CP1       | 3506      | Male   | 1/4" | <b>\$1.38</b> |

## Industrial Interchange

| Ascot #              | Dill No. | Milton No. | Amflo No. | McGee No. | Thread | NPT  | Price         |
|----------------------|----------|------------|-----------|-----------|--------|------|---------------|
| <b>COUPLERS</b>      |          |            |           |           |        |      |               |
| 131-61573            | 102      | 715        | C20       | 5142-12   | Female | 1/4" | <b>\$5.11</b> |
| 131-61574            | 103      | 716        | C21       | 5141-12   | Male   | 1/4" | <b>\$5.10</b> |
| <b>ADAPTER PLUGS</b> |          |            |           |           |        |      |               |
| 131-61578            | 110      | 727        | CP21      | 5138-11   | Male   | 1/4" | <b>\$1.29</b> |
| 131-61579            | 109      | 728        | CP20      | 5139-11   | Female | 1/4" | <b>\$1.49</b> |

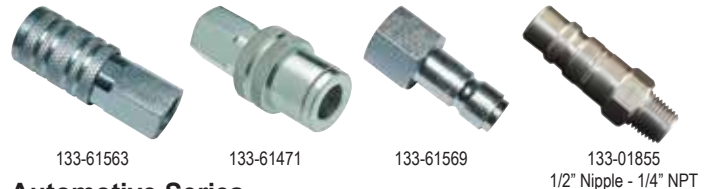

## Automotive Series

| Ascot #              | Dill No. | Milton No. | Amflo No. | McGee No. | Thread | NPT  | Price          |
|----------------------|----------|------------|-----------|-----------|--------|------|----------------|
| <b>COUPLERS</b>      |          |            |           |           |        |      |                |
| 133-61563            | D-17     | 1815       | C10       | 3512      | Female | 1/2" | <b>\$14.40</b> |
| 133-61564            | D-16     | 1816       | C9        | 3511      | Male   | 1/2" | <b>\$13.69</b> |
| 133-61471            | D-17R    | --         | --        | D17R      | Female | 1/2" | <b>\$14.53</b> |
| <b>ADAPTER PLUGS</b> |          |            |           |           |        |      |                |
| 133-61569            | D-3F     | 1818       | CP10      | 3514      | Female | 1/2" | <b>\$5.20</b>  |
| 133-61568            | D-2F     | 1817       | CP9       | 3513      | Male   | 1/2" | <b>\$5.48</b>  |
| 133-61474            | D-0F     | 1819       | CP9-03    | 3537      | Male   | 3/8" | <b>\$3.42</b>  |
| 133-01855            | N/A      | 1855       | N/A       | 1855MI    | Male   | 1/4" | <b>\$2.91</b>  |

## PREVOST 1/4"

### Automotive Style Couplers

- One hand push button design - red
- Fits all 1/4" automotive style adapters
- Longer lasting

Constructed of high impact tough composite material. Smooth finish will not scratch and will not hang up like traditional couplers. Press the button and the downstream air releases, and when the coupler is discharged it automatically releases adapter or hose, preventing dangerous hose whip. Use with any automotive nipple. Industrial use with 513811, 513911, and 11E.



| Mfr. No   | Description - Automotive    | Price          |
|-----------|-----------------------------|----------------|
| URC061201 | 1/4" FPT Automotive Coupler | <b>\$20.70</b> |
| URC061251 | 1/4" MPT Automotive Coupler | <b>\$22.90</b> |

Use with industrial - blue button

| Mfr. No   | Description - Industrial    | Price          |
|-----------|-----------------------------|----------------|
| IRC061201 | 1/4" FPT Industrial Coupler | <b>\$25.98</b> |





## Tubeless Truck Clamp-in Valves Dill - with U.S.A. made grommet!

Straight clamp-in valves used on both demountable and non-demountable rims. For .625" diameter valve hole.

| McGee #   | Effective Length            | 50 Ea. | Cost Each |
|-----------|-----------------------------|--------|-----------|
| TR500     | 2"                          | \$1.33 | \$1.60    |
| TR501     | 1 1/2"                      | \$1.33 | \$1.60    |
| TR570     | 3 1/8"                      | \$1.38 | \$1.66    |
| TR571     | 3 3/8"                      | \$1.40 | \$1.68    |
| TR572     | 3 3/4"                      | \$1.42 | \$1.70    |
| TR57213   | 13° bend in valve           | —      | \$2.02    |
| TR573     | 4 3/8"                      | \$1.50 | \$1.80    |
| TR57313   | 13° bend in valve           | —      | \$1.90    |
| TR573HT13 | 13° bend in valve high temp | —      | \$2.42    |
| TR574     | 5"                          | \$1.63 | \$1.96    |
| TR575     | 1-1/8"                      | —      | \$1.36    |

Import TR5721V - \$1.14 ea! TR5731V - \$1.23

**Remember - Bending a valve after it is in the wheel will often ruin the grommet and will cause a valve leak.**

## Metric Rim Hole Valve MS Series

(9.7mm Valve Hole)

- Some imported trucks will have steel wheels that incorporate the 9.7mm valve hole (.390")

Recommend installation torque 100 in - lbs

| McGee No | Ascot No  | ETRTO   | Bend | A       | B       | Price (ea.) |
|----------|-----------|---------|------|---------|---------|-------------|
| 60MS27   | 462-06027 |         | 27°  | 1-3/16" | 1-3/16" | \$3.49      |
| 70MS27   | 462-07025 | V3-20-5 | 27°  | 1-3/16" | 1-9/16" | \$3.49      |
| 80MS27   | 462-08027 | V3-20-7 | 27°  | 1-3/16" | 2"      | \$3.49      |
| 90MS27   | 462-09027 | V3-20-4 | 27°  | 1-3/16" | 2-3/8"  | \$3.49      |
| 115MS27  | 462-11527 | V3-20-6 | 27°  | 1-3/16" | 3-3/8"  | \$3.99      |
| 41MS00   | 462-04100 | V3-20-1 | STR  | 1-3/16" | —       | \$3.49      |
| 70MS7    | 468-00707 | —       | 7°   | —       | —       | \$4.99      |

70MS7 - Long thread for thicker wheels on motor coaches

## Tubeless Valves for Aluminum Disc Wheels

For drop-center aluminum disc wheels with 5/8" bottom valve hole

| Ascot No. | McGee No.. | Effective Length           | Price ea. |
|-----------|------------|----------------------------|-----------|
| 463-00509 | TR509      | 4-3/4" Straight            | \$2.78    |
| 463-00510 | TR510      | 5-1/2" Straight            | \$2.90    |
| 463-00511 | TR511      | 4-1/4" Straight            | \$3.55    |
| 468-05093 | TR509-3    | Replacement Rubber Grommet |           |

## Ford "F" Series Truck Valve

- Ford "F" series with dual wheels
- Alcoa aluminum 16" wheels
- Front and rear wheels
- Chrome finish
- Dual seal cap included

| Ascot No. | McGee No. | Description           |
|-----------|-----------|-----------------------|
| 462-01600 | VS902WP   | Ford "F" Series Valve |

## Ford "F" Series Truck Valve

- Ford "F" series with dual wheels
- Accuride steel 16" x 6" wheels
- Front and rear wheels
- Nickel finish
- Includes dual seal cap

**\$2.39 ea.**

| Ascot No. | McGee No. | Description           |
|-----------|-----------|-----------------------|
| 462-02416 | TR416MC   | Ford "F" Series Valve |

## DILL Commercial Truck Tire Valves

- Parts are individually date coded for traceability
- Grommets are high temperature verified and ozone resistant
- 570 series valves are made with 7/32" hex for easy installation
- OEM Approved
- EQ series (Viton o-ring-high temp) are made with 14mm hex to prevent spinning during torque process
- 550 series valves are designed with a screwdriver slot for easy installation
- Many truck valves are made with USA grommets and o-rings

## Metric Clamp-In Valves - 550 Series Popular on all new Alcoa wheels!

Compatible with aluminum wheel designs with .389 valve hole.

- Viton grommets offer a greater temperature range, a better seal, and a longer service life — Maximum temperature 250°
- Easier installation with screwdriver slot.
- Recommend installation torque 45 in - lbs.



| McGee # | A    | B    | C   | Price ea. |
|---------|------|------|-----|-----------|
| TR553   | 2.31 | -    | -   | \$3.99    |
| TR553C  | 0.93 | 1.38 | 45° | \$3.99    |
| TR553E  | .98  | 1.38 | 75° | \$3.99    |
| TR554D  | .98  | 1.94 | 60° | \$3.99    |
| TR555D  | .98  | 2.6  | 60° | \$3.99    |
| TR555E  | .98  | 2.6  | 75° | \$3.99    |

**Now! 100 ea. TR555D - \$2.35 ea**

## Tire Valves - 540 Series

O-ring seal valves for Alcoa truck wheel (9.7MM Valve Hole)

Many production Alcoa aluminum wheels are manufactured with a 9.7MM valve hole that requires an O-Ring tire valve. Valves have a high temperature resistant O-Ring and a heavy duty metal valve cap.



| Valve TR No. | A Height | Bend Angle | B Length | Price ea. | 100 ea. |
|--------------|----------|------------|----------|-----------|---------|
| TR543        | 2.40     | -          | -        | \$2.61    | \$1.40  |
| TR543D       | .98      | 60°        | 1.38     | \$2.74    | \$1.40  |
| TR543E       | .98      | 75°        | 1.38     | \$2.64    | \$1.40  |
| TR544        | 2.90     | -          | -        | \$3.15    | \$1.57  |
| TR544D       | .98      | 60°        | 1.94     | \$3.15    | \$1.57  |
| TR545        | 3.50     | -          | -        | \$3.24    | \$1.71  |
| TR545D       | .98      | 60°        | 2.6      | \$1.99    | \$1.59  |
| TR546        | 4.25     | -          | -        | \$3.17    | \$1.79  |
| TR546D       | .98      | 60°        | 3.35     | \$3.58    | \$1.79  |
| TR546E       | .98      | 75°        | 3.35     | \$3.62    | \$1.79  |
| TR546G       | .98      | 36°        | 3.35     | \$3.31    | \$2.65  |

## Truck Grommets



| McGee # | Rim # | Fits             | Used On   |
|---------|-------|------------------|---|
| 5953    | RG-15 | .625 Valve Hole  | TV-500 Series, TV-570 Series                          |
| RG15S   | RG-15 | .625 Valve Hole  | TV-500 Series, TV-570 Series red grommet 288°         |
| G160    | RG-22 | .812 Valve Hole  | H-41, T-81, T-30, DS-385, DS210                       |
| 5093    | RG-46 | .625 Valve Hole  | TV-509, 510, 511                                      |
| G174    | RG-48 | .625 Valve Hole  | TV-513, 515   |
| G170S   |       | .625 Valve Hole  | Heat-Resistant Grommet for TV-570 Series (400°) green |
| 59765   | RG-54 | .453 Valve Hole  | TV-416, 416L, 6008                                    |
| 525     | RG-39 | .625 Valve Hole  | TV-416, 416L  |
| G550    | RG-70 | .9975 Valve Hole | Fits TV-550 Series - 400°                             |
| 0330    | RG-60 |                  | TR-540 Series Valves - 400°                           |

## COUNTER DISPLAY

Retail Gauge Opportunity  
Promote accurate tire inflation

**941DIS** – Counter Display with Ten  
10-120 lb gauges  
**476-00941**

**\$27.95**

**7277USA** – Counter Display with  
ten USA made gauges 10-75 PSI  
**\$37.95**



## Automotive Tire Gauges



476-03501  
Black Plated Master Tire Gauge



- Pencil, chrome tire gauges with nylon indicator bars

Imprinted gauges available with your name. Call for details!

| Ascot #   | McGee # | Range      | Type   | Price          |
|-----------|---------|------------|--|----------------|
| 476-10105 | GA105   | 10-50 PSI  | Passenger Gauge                                    | <b>\$3.47</b>  |
| 476-10115 | GA115   | 20-120 PSI | High Pressure Gauge                                | <b>\$3.37</b>  |
| 476-07212 | 7212USA | 20-120 PSI | High Pressure Gauge                                | <b>\$4.13</b>  |
| 476-10100 | GA100   | 1-20 PSI   | Low Pressure Gauge                                 | <b>\$3.14</b>  |
| 476-10110 | GA110   | 10-50 PSI  | Passenger Gauge 75-340 kPa Calibrated in PSI & kPa | <b>\$2.74</b>  |
| 476-07213 | 7213USA | 10-50 PSI  | Passenger Gauge 75-340 kPa Calibrated in PSI & kPa | <b>\$3.53</b>  |
| 476-10125 | GA125   | 5-45 PSI   | Air/Liquid Gauge - tractor                         | <b>\$3.12</b>  |
| 476-07230 | 7230USA | 5-45 PSI   | Air/Liquid Gauge - tractor                         | <b>\$6.38</b>  |
| 476-10145 | GA145   | 10-75 PSI  | Mid-Range Gauge 70-500 kPa Calibrated in PSI & kPa | <b>\$2.81</b>  |
| 476-03501 | 3501    | 10-100 PSI | Master Tire Gauge & Black Angle Bend               | <b>\$16.58</b> |

| Ascot No. | McGee No. | Gauge Type  | Price          |
|-----------|-----------|---|----------------|
| 476-10135 | GA135     | Angle Chuck With Nylon Bar  | <b>\$8.55</b>  |
| 476-11135 | GA135S    | Same As Above, Angle Chuck With Metal Bar                             | <b>\$9.63</b>  |
| 476-10155 | GA155     | Straight-On With 30° Reverse Chuck                                    | <b>\$12.79</b> |
| 476-10165 | GA165     | Same As Above, Straight-On With 30° Reverse Chuck, Black Epoxy Finish | <b>\$9.56</b>  |
| 476-11155 | GA155S    | Same As Above, Straight-On With 30° Reverse Chuck, Metal Bar          | <b>\$12.92</b> |
| 476-10185 | GA185     | Dual Foot Service Gauge With Nylon Bar, 180° Chuck, Chrome Plated     | <b>\$11.77</b> |
| 476-01046 | 7285E     | Externally Adjustable Metal Bar Truck Gauge – 10-150 psi              | <b>\$13.94</b> |

## Dill USA Truck Service Gauges

| Ascot #   | McGee # | Range      | Type  | Price          |
|-----------|---------|------------|---|----------------|
| 476-00001 | SG1     | 10-150 PSI | Dual Foot Head; Chrome Body with Black Markings on a White Bar                          | <b>\$24.52</b> |
| 476-00002 | SG2     | 10-150 PSI | Dual Foot Head; Chrome Body with White Markings on a Black Bar - Adjustable             | <b>\$26.23</b> |
| 476-00003 | SG3     | 10-150 PSI | Dual Foot Head; Black Powder Coated Body with White Marking on a Black Bar - Adjustable | <b>\$26.75</b> |

## Safety Inflation Gauges

1-2% ACCURACY



477-00001  
10-120 PSI

**\$49.95**

Specify hose 6', 9', or 12'

Recommended for All Types  
of Vehicles – 10-120 PSI



**\$69.90**

477-11235

RPG Digital Inflator: 20 Hose  
w/Clip-On Chuck – 0-174 PSI

## Digital Pocket Gauge

- Range: 0-150 PSI in .5 PSI increments
- Accuracy:  $\pm 1$  PSI
- Large LCD display
- Red backlight
- Angled chuck head



476-32380  
Digital Pocket Gauge

| Ascot No. | Mfg. No. | Description                                   | Price          |
|-----------|----------|---|----------------|
| 476-32380 | 3238P    | Digital Pocket Gauge w/Angled Chuck 1 150 PSI | <b>\$18.79</b> |

## Truck Service Gauges



- Wide variety of service gauges to accommodate the numerous tire and wheel configurations encountered by tire service personnel
- Available in chrome plated or protective black epoxy finish as indicated
- Calibrated from 10-150 psi in 2 pound increments
- Nylon or metal indicator bars

## Pocket Truck Gauges



| Ascot No. | McGee No. | Description   | Price          |
|-----------|-----------|---|----------------|
| 476-10150 | GA150     | Straight-On/Angled Gauge. 20-120 psi. Chrome Plated.                              | <b>\$9.67</b>  |
| 476-10160 | GA160     | Straight-On/Angled Gauge. 10-120 PSI. Black Baked Epoxy Protective Finish.        | <b>\$9.99</b>  |
| 476-10130 | GA130     | Dual Foot Angled Pencil Gauge. 20-120 psi.  | <b>\$6.40</b>  |
| 476-07263 | 7263USA   | Straight-On/Angled Gauge USA Made 20-120 PSI. Black Baked Epoxy Protective Finish | <b>\$11.11</b> |



## REDI-Sensor™

### Simple and Accurate

#### REDI-SENSOR MULTI-APPLICATION SENSOR

- Installs right out of the box • No programming required, saving you 8-10 minutes per vehicle
- Reduces replacement sensor inventory
- Adjustable valve stem design • Fits over 90% of the market • No additional training required • All REDI-Sensors are available in a rubber stem format

#### WORKS WITH EXISTING MAJOR TPMS SCAN TOOLS:

If a shop has the tools to handle OE sensors, it's ready for REDI-Sensor. Unlike other sensors that require the purchase of specialized tools and software upgrades, no additional purchases, training or investments are needed with REDI-Sensor.

| McGee No. | Description  | Price          | Ascot No. |
|-----------|--|----------------|-----------|
| 7001HP    | 315MHz REDI-Sensor Multi-Application Sensor (Clamp-In Style)       | <b>\$33.14</b> | 461-07001 |
| 7002A     | 315 MHz REDI-Sensor for Honda, Hyundai, Kia, Lexus, Toyota & Scion | <b>\$34.57</b> | 461-07002 |
| 7003A     | 315MHz REDI-Sensor Multi-Application Sensor (Clamp-In Style)       | <b>\$34.57</b> | 461-07003 |
| 7004      | 433MHz REDI-Sensor Multi-Application Sensor (Clamp-In Style)       | <b>\$34.57</b> | 461-07004 |
| 7001HP-R  | 315MHz REDI-Sensor Multi-Application Sensor (Snap-In Style)        | <b>\$33.14</b> | 461-07011 |
| 5001R     | 433MHz Multi-Application Sensor (Clamp-In Style)                   | <b>\$34.29</b> |           |

### TPMS Profit Center

Remember, replacing the TPMS valve stem (snap-in rubber or clamp-in aluminum) or the TPMS service kit with each tire sale is done for the same reasons a traditional TR-413 snap-in is replaced with each new tire.

More information at [mcgeecompany.com/stems](http://mcgeecompany.com/stems)



**TPC**  
**\$174.99**



### How much money are you leaving on the table by not doing TPMS?

|                          | TR413 Valve Stem   | TPMS Rebuild 9066k  |
|--------------------------|--------------------|---------------------|
| ASSUMPTIONS              | 100 Tires per Week | 100 Tires per Week  |
| <b>Cost to WD</b>        | \$ 0.29            | \$ 4.03             |
| Sell price               | \$ 1.90            | \$ 8.95             |
| Profit per tire          | \$ 1.61            | \$ 4.92             |
| Weekly profit            | \$ 161.00          | \$ 492.00           |
| Annual profit (52 weeks) | <b>\$ 8,372.00</b> | <b>\$ 25,584.00</b> |

A shop doing **TPMS** makes over **three** times the amount doing TPMS versus valves alone in addition to pushing their customers to a competitor. **Be TPMS smart**; let McGee Company train you and set you up with the tools to be successful.

## EZ-sensor™

Innovation by Schrader®

### ATEQ

#### S41 & S56 tools both:

- Relearn and read all sensors, regardless of manufacturer displaying all sensor data
- Indicate OE sensor/service kit part numbers
- ECU relearn procedures, has OBDII cable, unlocks Toyota ECU
- Allows manual sensor ID entry or program sensors by wheel set (5)
- Test remote key and have LCD displays

#### S56 tool only

- Read DTCs, programs other brands of sensors, has Wifi, can program sensors from historical data, and has VIN barcode scanner

| McGee No. | Description                       | Price            |
|-----------|-----------------------------------|------------------|
| 46133560  | Dual Band 315 & 433 Mhz EZ Sensor | <b>\$29.99</b>   |
| 46133561  | Bulk 10 Pack EZ Sensor            | <b>\$259.99</b>  |
| 46934000  | Aluminum Stem for EZ Sensor       | <b>\$5.49</b>    |
| VS950     | Rubber Stem for EZ Sensor         | <b>\$2.19</b>    |
| 33700     | High Speed EZ Sensor              | <b>\$33.43</b>   |
| 21298-S41 | TPMS Tool and 24 Sensor Bundle    | <b>\$629.99</b>  |
| 21256-S56 | TPMS Tool and 30 Sensor Bundle    | <b>\$1199.99</b> |

Bulk Discounts Available

Covers both 315 and 433 Mhz



Mix 33900 EZ sensor with the stem you need!

- 25078 90 deg. valve in silver/gray
- 25080 straight valve in silver/gray
- 25082 90 deg. valve in matte black
- 25083 straight valve in matte black



S56



**33700**

Adjustable Angle Aluminum Clamp-In

Designed to eliminate multiple sensors required for TPMS work

#### APPLICATIONS:

Covers most GM, Chrysler, Honda, Nissan, Toyota, Lexus, Scion, Ford, Lincoln, & Mercury vehicles and some Mitsubishi, Subaru & Suzuki vehicles • Fully programmable • Compatible with Bartec, Schrader and SPX/OTC programming tools • Sensor features Wireless Auto Locate or WAL that allows the vehicle's TPMS system to locate and identify each TPMS sensor's specific location

### WHY SCHRADER?

Schrader is the leading global manufacturer of tire pressure monitoring systems (TPMS) for automotive, heavy-duty and off-road vehicles. Schrader is a pioneer in TPMS, a vehicle safety feature that is now standard on all cars and light trucks sold in the U.S.



#### OE MANUFACTURER

- First to market with new coverage
- Defect Allotment of 4 parts per million
- Extensive testing to guarantee quality



#### GLOBAL MARKET-LEADER

- Over 250 dedicated engineers
- Over 750 million sensors sold
- Frost & Sullivan award winning



#### TPMS PARTNER OF CHOICE

- TIA certified team
- Training and marketing support
- Partners with leading TPMS tool manufacturers

More than just a supplier, we are a TPMS partner!

### 2017 - 2020 Ford F350 DRW

Relearn: Triggering tool required\*



All Sensors\*: 9291  
Valve: VS-241



Ask about our Tesla stems

\*Also covered by REDI-Sensor 7003A and Dill 5002

\*Perform relearn before installing the outer rear wheels on the vehicle.

**Avoid flat tires! New tires mounted on TPMS equipped vehicles require TPMS replacement kits.**

**Bookmark our Dill TPMS page for quick lookup**

| Ascot No. | McGee No. | Schrader Version                  | Description  | Price         |
|-----------|-----------|-----------------------------------|--|---------------|
| 469-01030 | 1030K     | SH20017AK                         | Siemens Kit for VW (Fits 1053 Sensor) (Orange)   | <b>\$3.25</b> |
| 469-01050 | 1050K     | SH20013AK/<br>SH20030AK           | Siemens Kit for Chrysler (White)<br>SH20013AK includes bottom ball   | <b>\$3.12</b> |
| 469-01060 | 1060K     | 20001/20002/<br>20135AK/20096AK   | Fits Schrader SH20096 (Red)  | <b>\$1.75</b> |
| 469-01070 | 1070K     | 20004/20116AK/<br>20115AK/20107AK | Fits Dill 9076, 9107, 9115, 9116 (Blue)  | <b>\$1.75</b> |
| 469-01080 | 1080K     | 20003/20007/<br>20117AK/20028AK   | Fits Dill 9028, 9034, 9064, 9081, 9117, 9161 (Green)   | <b>\$1.75</b> |
| 469-01090 | 1090K     | –                                 | Compatible with Beru Sensors (Grey)  | <b>\$3.60</b> |
| 469-20036 |           | SH20036AK                         | Entire Valve (Schrader 20036) for Hyundai, Kia, Honda (Dill 1096)  | <b>\$8.72</b> |
| 469-01100 | 1100K     | SH20032AK                         | Compatible with Pacific Sensors for Toyota/Lexus (Purple)  | <b>\$3.02</b> |
| 469-01110 | 1110K     | SH20006AK                         | Compatible with Pacific Sensors for Toyota (Teal)  | <b>\$2.95</b> |
| 469-01130 | 1130K     | SH20030AK                         | Compatible with Schrader 20005 (Burgandy)  | <b>\$2.95</b> |
| 469-20025 | 2000K     | –                                 | TRW Kit for Honda, Acura   | <b>\$3.68</b> |
| 469-20010 | 2010K     | SH20015AK                         | Compatible with Schrader Sensors for Volvo (non-stock) (Lt. Brown)   | <b>\$1.92</b> |
| 469-20020 | 2020K     | SH20030AK                         | Early 2007 GM Kit for Entire Sensors (Pink)  | <b>\$1.92</b> |
| 469-20030 | 2030K     | SH20016AK                         | Dill Sensors 9154, 9204, 9214  | <b>\$1.92</b> |
| 469-02040 | 2040K     | SH20019AK                         | Kit for Honda Civic (Lt. Blue)   | <b>\$2.08</b> |
| 469-09250 | VS925A    | –                                 | Aluminum Metal Replacement Valve for GM Snap-In  | <b>\$4.18</b> |
| 469-09251 | VS925C    |                                   | Chrome Metal Replacement Valve for GM and Ford Snap-In   | <b>\$4.53</b> |
| 469-00950 | VS950     | SH20018                           | Rubber Snap-In Replacement Valve for GM & Ford fits Schrader 46133500 (ea)   | <b>\$1.99</b> |
| 469-17208 | VS950IV   | VS950IV                           | Rubber Snap-in like VS950 for GM & Ford (Import)   | <b>\$ .99</b> |
| 469-09305 | VS950SC   | –                                 | Chrome Replacement Valve for GM and Ford Snap-In   | <b>\$2.50</b> |
| 469-34000 | 46934000  |                                   | Alum Stem for Schrader 46133500 dual band  | <b>\$5.50</b> |
| 469-20020 | –         | SH20020                           | Replacement Stem Chrysler, Uses Kit 1050K  | <b>\$2.29</b> |
| 469-90660 | 9066K     | –                                 | Complete Replacement Stem Chrysler with Kit (9066B-Ball joint only)  | <b>\$4.23</b> |
| 469-07020 | 7020K     | –                                 | Accessory Kit for Redi Sensor  | <b>\$3.76</b> |
| 469-00770 | VS70      | –                                 | Available on the following vehicle in various forms: Years 2010 to 2014 (Acura, Cadillac, Chrysler, Dodge, Honda, Hyundai, KIA, Mazda, Nissan) the sensor most associated with the VS-70 is 7001/HP or 7002. | <b>\$4.97</b> |
| 469-00080 | VS80      | –                                 | Replacement Rubber Stem Kit Dill Redi 7001-R   | <b>\$4.99</b> |
| 469-00090 | VS90      | –                                 | Key at base attaches via press clip; Fits Dodge Dart, Mitsubishi Mirage  | <b>\$5.15</b> |
| 469-17436 | 1743016   | –                                 | Smart Sensor Snap-In Valve for ITM, Cub, 31Inc, Pilot  | <b>\$4.19</b> |
| 469-20014 | –         | SH20014AK                         | Kit Fits EZ Sensor 34000 Stem  | <b>\$2.13</b> |
|           | VS1010    | –                                 | Fits Hyundai Sante Fe Snap-In 7mm  | <b>\$2.43</b> |
|           | VS65      | –                                 | Base of stem is square Snap-In Fits Dodge Rams, Jeep Cherokee  | <b>\$3.75</b> |
|           | VS65IV    | –                                 | Base of stem is square Snap-In Fits Dodge Rams, Jeep Cherokee Import   | <b>\$2.02</b> |
|           | VS35      | –                                 | Dill TPMS clamp-in valve Dodge Ram   | <b>\$7.16</b> |
| 469-20031 | –         | SH20031AK                         | Assy Kit for Pacific TPMS  | <b>\$2.13</b> |
|           | VS965     | –                                 | Replacement valve stem for Hyundai / Kia   | <b>\$4.05</b> |
| 469-00919 | VS919     | –                                 | Replacement TPMS stem for 19.5 Trk Wheels, parallel key  | <b>\$3.60</b> |
|           | VS241     | –                                 | 2017 Ford F350 Super Duty dually aluminum  | <b>\$5.92</b> |
|           | VS20      | –                                 | Rubber Valve Stem for 2015 and newer GM and Ford   | <b>\$2.48</b> |
| 469-20280 | RV1000    | –                                 | Autel MX-Sensor Rubber press release stem  | <b>\$3.25</b> |
| 469-20279 | MV1000    | –                                 | Autel MX-Sensor Metal press release stem   | <b>\$3.08</b> |
| 469-20281 | CV001     | –                                 | Autel Black MX-Sensor Black Metal Valve  | <b>\$4.17</b> |
| 469-20282 | CV002     | –                                 | Autel MX-Sensor Titanium Grey Metal Valve  | <b>\$4.17</b> |
| 469-20283 | CV003     | –                                 | Autel MX-Sensor Chrome Valve   | <b>\$9.95</b> |
| 469-17393 | VS920     |                                   | .625" valve hole square found in Ford Super trucks/sprinters (VS919 Parallel key)  | <b>\$3.61</b> |
| 469-17398 | 1750398   |                                   | Short Snap in good for custom applications parallel key  | <b>\$1.44</b> |



SH20036AK



VS919



VS925A



VS925C



VS950



SH20020



VS70



VS80



VS90



469-17436



VS1010



VS65



VS20

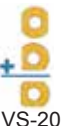

VS-20



RV1000



46917393



1750398



## ITS600 TPMS, Diagnostics, and Tire Service Tool

- Activates, reads and relearns all known sensors
- OBDII relearn for most vehicles with 99% coverage of OE sensors
- Copy By OBD sensor programming & four MX-Sensor program modes; batch program up to 20 MX-Sensors
- Includes wireless Bluetooth vehicle communication interface (VCI)
- Tire pressure placard value reset
- Read/Clear TPMS system codes & view live data
- Free Wi-Fi software updates for the life of the tool



ProUpgrade \$120

- Rapid VIN acquisition via optical VINScan
- QR Code Scan / Barcode Scan, Plate scan, Auto VIN detect and manual input
- Identify MMY and sensor OE part number via VIN decoding



### Integrate with the TBE200 for:

- Precise laser measurement of tread depth & brake disc wear
- Create comprehensive Test Report w/TPMS health, Tread depth, brake disc wear characteristics, & Repair tips

TBE200 \$489.99



TBE in action

**\$799.00** Bundle with 12 sensors only

**MaxiTPMS<sup>®</sup>**  
**ITS600K12**

**AUTEL<sup>®</sup>**

**Sick of your technicians not being able to read tire DOT codes or read what they wrote down?**



**ITS600 is the first tool to scan DOT numbers for expiration and recall lookup!**

### DIAGNOSTICS & SERVICE

- Oil light reset
- Electronic brake service
- Battery registration
- Steering angle reset
- Included service function updates are free for the life of the tool
- All systems diagnostics and maintenance services software available with Pro Upgrade purchase



## AUTEL MX-SENSOR PROGRAMMABLE UNIVERSAL TPMS SINGLE SENSOR

- Combines 315MHz & 433MHz frequencies into a single sensor
- 98% vehicle coverage • The exclusive MX-Sensor patented PRESS release valve allows rubber and metal valve stems to freely interchange by hand without requiring a tool
- Built to match or exceed OEM sensors in frequency strength and durability
- 100% ID cloneable with no relearn required • Quickly update during installation with an Autel wireless programming tool



**Qty discounts available!**

| Ascot No. | McGee No. | Description   | Price                                |
|-----------|-----------|---|--------------------------------------|
| 461-20326 | 1-Sensor  | Autel MX-Sensor Programmable Universal TPMS Single Sensor | \$29.00<br>Quantity breaks available |

## AUTEL MX-SENSOR REPLACEMENT VALVE STEMS

Patented PRESS release valve design • No valve tools required to attach to stem • Simply click in and press out • Cap and core included



| Ascot No. | McGee No. | Description   | Price  |
|-----------|-----------|---|--------|
| 469-20280 | RV1000    | Autel MX-Sensor Replacement Rubber Valve Stem         | \$3.25 |
| 469-20227 | MV1000    | Autel MX-Sensor Replacement Metal Valve               | \$3.08 |
| 469-20281 | CV001     | Autel Black MX-Sensor Replacement Metal Valve         | \$4.17 |
| 469-20282 | CV002     | Autel Titanium Grey MX-Sensor Replacement Metal Valve | \$4.17 |
| 469-20283 | CV003     | Autel MX-Sensor Chrome Valve                          | \$9.95 |

## FREE SOFTWARE UPDATES



Quick Mode

### BASIC FUNCTIONS

**EASY & FAST**

- Activate All Known TPMS Sensors
- Read Sensor ID, Temperature, Pressure
- Read Sensor Battery Condition
- On-Tool OE Sensor Information
- Program MX-Sensor With 3 Programming Options
- Batch Program 1-16 MX-Sensors

**\$360\***

**MaxiTPMS<sup>®</sup>**  
**TS508K12**

- 1 - Autel TS508 Complete TPMS Tool
- 4 - Metal Valve Stems
- 12 - 1Sensor TPMS Programmable Sensors



Advanced Mode

### COMPLETE FUNCTIONS

**POWERFUL**

- Same TPMS Features as Quick Mode
- TPMS Status Screen - View System Faults
- Read & Clear TPMS DTCs
- On-Tool DTCs Description
- Program MX-Sensors by Copying ECU Sensor IDs
- On-Tool Relearn Procedure Guide
- Widest Vehicle Coverage For OBD Relearn
- Tire Pressure Placard Value Reset

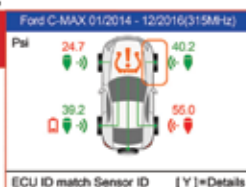

## AUTEL TPMS TOOL

- The MaxiTPMS<sup>®</sup> TS508 is a new generation TPMS diagnostic & service tool specially designed to activate all known TPMS sensors, read TPMS sensor status, check TPMS system health condition, program MX-sensors and conduct TPMS relearn
- With Quick Mode and Advanced Mode options, you can save time and energy by choosing the most suitable way to complete TPMS work



TS508

## MC Series fits more U.S. vehicles than any other weight!

## "MCN" Series- Wheel Protectors® Coated

The "MCN" series is the recommended weight for all applications shown below. The "MCN" meets all OEM quality specifications.

## "MC" Series-Uncoated

Fits most Chrysler, GM, Ford since 1990, Fiat

We recommend that coated weights be used on all vehicles having alloy wheels.

"MCN" Coated—25 pc. box. "MC" Uncoated—50 pc. box

MC



AUDI  
BMW  
CATERA  
GEO  
HYUNDAI  
JAGUAR  
KIA  
MITSUBISHI (see chart)  
SUBARU  
SUZUKI  
VOLVO  
MINI  
LAND ROVER  
SMART CAR

IAW



AUDI  
HONDA  
& ACURA  
MERCEDES  
VW  
From 1997  
All from 1980 to 1989

EN



Also used on many after-market alloy wheels with thin rim flanges



ACURA  
DAEWOO  
HONDA  
INFINITI  
ISUZU  
LEXUS  
MAZDA  
NISSAN  
TOYOTA  
Most since 1990  
All since 1999  
All since 1989  
All since 1990  
All since 1997  
All since 1990  
Many since 1990  
All since 1990  
All since 1990



FN



See chart for exceptions

## Wheel Cleaner

Stop Using Expensive Wheel Cleaning Solutions

A clean wheel is critical to good stick-on wheel weight adhesive.

- Water-Based
- Non-Petroleum
- Biodegradable
- Non-Toxic

## A Note About Today's Wheels

For environmental reasons the car manufacturers recently started using water-based paint on wheels.



Unfortunately, those paints have an adverse effect on the adherence of wheel weights. The special formulation assures optimal adherence even on surfaces coated with water-based paint.

| Ascot No.       | Description                          | Price          |
|-----------------|--------------------------------------|----------------|
| <b>48675032</b> | Wheel Cleaner<br>32 Oz. Spray Bottle | <b>\$11.25</b> |
| <b>48675017</b> | Wheel Cleaner<br>1 Gallon Bottle     | <b>\$19.95</b> |

3358HD  
486-33581



Scraper 71510  
486-071510



|                  |  |                |
|------------------|--|----------------|
| <b>486-71510</b> | 71510 Adhesive Wheel Weight Super Scraper<br>Removes emblems, body side moldings and stick-on wheel weights. | <b>\$9.90</b>  |
| <b>486-33581</b> | 3358 KD Heavy Duty Weight Tool - Ideal for all weights, including coated.                                    | <b>\$28.95</b> |

|                   |                |         |  |             |               |                            |                   |                                   |
|-------------------|----------------|---------|--|-------------|---------------|----------------------------|-------------------|-----------------------------------|
|                   | 200576FE       | .25 oz. | Low Profile Coated                                 | 3 oz./strip | 48 strips/box | Width: 3/4"<br>Depth: 1/8" | Steel 576 pcs     | <b>Special!</b><br><b>\$29.95</b> |
|                   | 200576FER Roll | .25 oz. | Low Profile Coated                                 | Roll        |               | Width: 3/4"<br>Depth: 1/8" | Steel 700 pcs     | <b>\$39.95</b>                    |
| <br>Black         | 200576FEBLK    | .25 oz. | Low Profile Premium Tape                           | 3 oz./strip | 48 strips/box | Width: 3/4"<br>Depth: 1/8" | Steel 576 Seg/box | <b>Special!</b><br><b>\$34.70</b> |
|                   | FSF101CP       | .25 oz. | Low Profile Economy Tape                           | 3 oz./strip | 48 strips/box | Width: 3/4"<br>Depth: 1/8" | Steel 576 pcs     | <b>\$22.95</b>                    |
|                   | 320FE          | .25 oz. | Premium Coated Steel                               | Roll        |               | Width: 3/4"<br>Depth: 1/8" | Double Tap Tape   | <b>\$89.95</b>                    |
|                   | 7026           | .25 oz. | Low Profile Premium Tape                           | 3 oz./strip | 48 strips/box | Width: 3/4"<br>Depth: 1/8" | Lead 576 seg/box  | <b>Special!</b><br><b>\$38.93</b> |
| <br>White         | 7026FEW        | .25 oz. | Tape-On-Top Low Profile Premium Tape White Polycat | 2 oz./strip | 30 strips/box | Width: 3/4"<br>Depth: 1/8" | Steel 240 Seg/box | <b>Special!</b><br><b>\$31.75</b> |
| <br>Plombco Style | WR31252CW      | .25 oz. | Cold Weather Tape                                  | 3 oz./strip | 52 strips/box | Width: 3/4"<br>Depth: 1/8" | Lead 624 pcs      | <b>\$69.86</b>                    |
| <br>Plombco Style | 312FE52CW      | .25 oz. | Cold Weather Tape                                  | 3 oz./strip | 52 strips/box | Width: 3/4"<br>Depth: 1/8" | Steel 624 pcs     | <b>\$42.95</b>                    |
| <br>Plombco Style | WR41230CW      | .50 oz. | Cold Weather Tape                                  | 3 oz./strip | 30 strips/box | Width: 3/4"                | Lead 360 pcs      | <b>\$80.26</b>                    |



## "I7" Series

*BTLM = I7*

Most popular weight for the medium-duty truck. Used on most trucks with tube type tires. 25 per box except 10 & 12 oz.; 20/box & 14 & 16 oz.; 10/box.

| Part. No. | Weight  |
|-----------|---------|
| I71       | 1.0 oz. |
| I72       | 2.0 oz. |
| I73       | 3.0 oz. |
| I74       | 4.0 oz. |
| I75       | 5.0 oz. |
| I76       | 6.0 oz. |

| Part. No. | Weight   |
|-----------|----------|
| I78       | 8.0 oz.  |
| I710      | 10.0 oz. |
| I712      | 12.0 oz. |
| I714      | 14.0 oz. |
| I716      | 16.0 oz. |

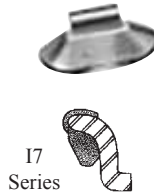

I7 Series

## CT

*BTLT + I9 = CT*

Used on "section" type, straight flange, tubeless wheels, Goodyear Super Single; Budd 7.50" and 8.25" wheels with Firestone or Goodyear discs. Uncoated.

| Part. No. | Weight  |
|-----------|---------|
| CT2       | 2.0 oz. |
| CT3       | 3.0 oz. |
| CT4       | 4.0 oz. |
| CT6       | 6.0 oz. |
| CT8       | 8.0 oz. |

| Part. No. | Weight   |
|-----------|----------|
| CT10      | 10.0 oz. |
| CT12      | 12.0 oz. |
| CT14      | 14.0 oz. |
| CT16      | 16.0 oz. |



**LEAD, STEEL, AND PLASTEEL WEIGHT OPTIONS!**

## Truck Tape-On Weights

|  |              |         |  |               |              |               |                |
|--|--------------|---------|--|---------------|--------------|---------------|----------------|
|  | 300360       | .50 oz. | Standard Profile Quick Tab with Premium Tape | 30 strips/box | Width: 1"    | Lead 360 pcs  | <b>\$70.30</b> |
|  | 300224FE     | .50 oz. | Standard Profile Quick Tab with Premium Tape | 24 strips/box | Width: 1"    | Steel 224 pcs | <b>\$29.78</b> |
|  | 300224FE BLK | .50 oz. | Standard Profile Quick Tab with Premium Tape | 24 strips/box | Width: 1"    | Steel 224 pcs | <b>\$32.83</b> |
|  | 420FE        | .50 oz. | Standard Profile                             | Roll          | Width: 1"    | Steel 640 pcs | <b>\$94.69</b> |
|  | CL6          | 1 oz.   | Standard Profile Quick Tab with Premium Tape | 30 strips/box | Width 3/4"   | Lead 180 pcs  | <b>\$73.93</b> |
|  | 1184         | 1 oz.   | Standard Profile with Premium Tape           | 18 strips     | Width 3/4"   | Steel 72 pcs  | <b>\$29.13</b> |
|  | 48410300     | 1 oz.   | Standard Profile with Economy Plastic Tape   | 36 strips     | Width 3/4"   | Steel 144 pcs | <b>\$26.00</b> |
|  | 48410301     | 1 oz.   | Standard Profile with Economy Plastic Tape   | 36 strips     | Width 3/4"   | Steel 144 pcs | <b>\$28.95</b> |
|  | CL12         | 2 oz.   | Standard Profile Quick Tab with Premium Tape | 8 strips/box  | Width 1-1/4" | Lead 48 pcs   | <b>\$46.90</b> |
|  | 484-10400    | 2 oz.   | Standard Profile with Plastic Tape           | 18 strips     | Width 1-1/4" | Steel 54 pcs  | <b>\$34.91</b> |

## Adhesive Wheel Weight Roll Stand

- All-metal construction
- Accommodates three rolls
- Floor mount
- Easy to assemble
- Fits all rolls except 520FE

486-31281  
Adhesive Wheel Weight Roll Stand  
**\$149.95**



| Ascot No. | McGee No. | Description                      |
|-----------|-----------|----------------------------------|
| 486-31281 | WWR3      | Adhesive Wheel Weight Roll Stand |

## "TS" Series

CHEVROLET GMC - Use on full size pickup, Suburban, Yukon, Tahoe from 2000. Denali & Escalade use MCS for 2000  
FORD - Expeditions from 1997 - F-100, F-150 from 1997  
LINCOLN - Navigator from 1998

We recommend the use of TS series weights on all full size pickup trucks and vans equipped with steel wheels. The use of "REG" series passenger weights on thicker truck rims may cause over-stressing of clips resulting in weight failures.

| Part. No. | Weight  |
|-----------|---------|
| TS025     | .25 oz  |
| TS050     | .5 oz   |
| TS075     | .75 oz  |
| TS100     | 1 oz    |
| TS125     | 1.25 oz |
| TS150     | 1.5 oz  |

| Part. No. | Weight  |
|-----------|---------|
| TS175     | 1.75 oz |
| TS200     | 2 oz    |
| TS225     | 2.25 oz |
| TS250     | 2.5 oz  |
| TS275     | 2.75 oz |
| TS300     | 3 oz    |

| Part. No. | Weight  |
|-----------|---------|
| TS325     | 3.25 oz |
| TS350     | 3.5 oz  |
| TS375     | 3.75 oz |
| TS400     | 4 oz    |
| TS450     | 4.5 oz  |
| TS500     | 5 oz    |



## "TAL" Series Wheel Protectors® Coated Wheel Weights

A new special weight for all Alcoa and Accuride (from 1983) aluminum tubeless heavy truck wheels. The weights will fit both sides of the wheel. These new weights replace the "OS-TAL" and "DS-TAL" series. Use rim gauge RGT2 to verify correct application (either OS-TAL or DS-TAL slot).

"TAL" Coated



| Part. No. | Weight  |
|-----------|---------|
| TAL030    | 3.0 oz. |
| TAL040    | 4.0 oz. |
| TAL060    | 6.0 oz. |
| TAL080    | 8.0 oz. |

## Wheel Weight Adhesive Removal Tool

**A143252 - \$67.99**  
**Replacement pad - A1432526 only - \$6.99**

- Lock-off trigger for added safety
- High torque motor to cut through stubborn wheel weight adhesive, body pinstripes, etc.
- Rubber-insulated housing for comfort
- High RPM to prevent pad from bogging down; 3,700 RPM free speed



## Why studded tires are the best choice for winter driving!

**Braking distance on Icy Road - (from 31 mph) Average calculated at different temps**

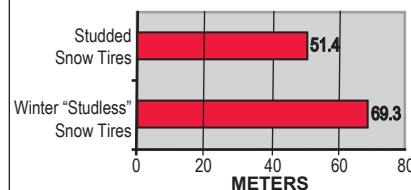

35% BETTER THAN 'STUDLESS' WINTER TIRES

**Acceleration on Ice (seconds from 3 to 12 mph) Average calculated at different temps**

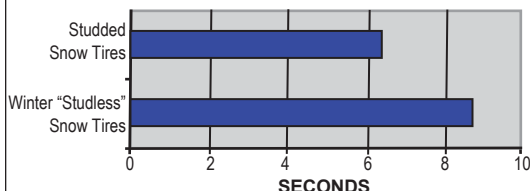

STUDDED TIRES 36% BETTER THAN WINTER "STUDLESS" SNOW TIRES

**Dry Asphalt Braking distance 77 MPH to 0 MPH Finnish Tekniikan**

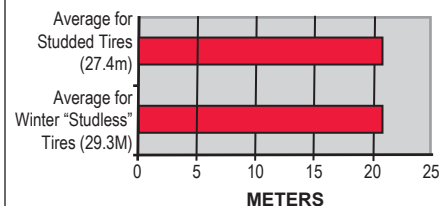

## Stud Gun, Studding Equipment



| ASCOT NO. | MFG. NO. | DESCRIPTION   |
|-----------|----------|---|
| 458-00010 | 10G      | <b>Stud Gun.</b> Standard of the Industry. Automatic. Light weight.   |
| 458-00002 | KFP2     | <b>Stud Feeder.</b> Fully automatic with 110 Volt motor, fast loading. Provides positive stud orientation. Feeds up to 225 studs per minute.        |
| 458-04048 | 4048     | <b>Feederboy Stud Gun.</b> Designed for fast feeding studs of the AS-9 Gun. Attaches with screw clamp. Operates by manually turning the feeder cap. |
| 458-00005 | K5       | <b>Stud Feeder.</b> INCLUDES: Shield for gun. Welded steel construction with saddle.  |
| 458-00500 | K500     | <b>Studding Equipment Kit.</b> INCLUDES: K-5 stand, AS-9 gun, KFP2 automatic stud feeder.   |

## Ugigrip®, Self-Adjusting Carbide Tire Stud

- Delivers full-time traction, increases the safety, convenience and security.
- To order studs to best fit your customers' tire, use the TSMI number recommended by the tire manufacturer



### SINGLE FLANGE STUDS:

| TSMI Size                 | 11     | 12     | 13     | 15     | 16     | 17     | 19     |
|---------------------------|--------|--------|--------|--------|--------|--------|--------|
| Overall Length            | .345"  | .375"  | .470"  | .520"  | .585"  | .515"  | .635"  |
| Jacket Dia.               | .197"  | .197"  | .197"  | .197"  | .197"  | .197"  | .250"  |
| Bottom Dia                | .354"  | .354"  | .354"  | .354"  | .354"  | .354"  | .354"  |
| Nearest 32" to Hole Depth | 11/32" | 12/32" | 13/32" | 15/32" | 16/32" | 17/32" | 19/32" |

MADE IN FRANCE FOR OVER 50 YEARS!

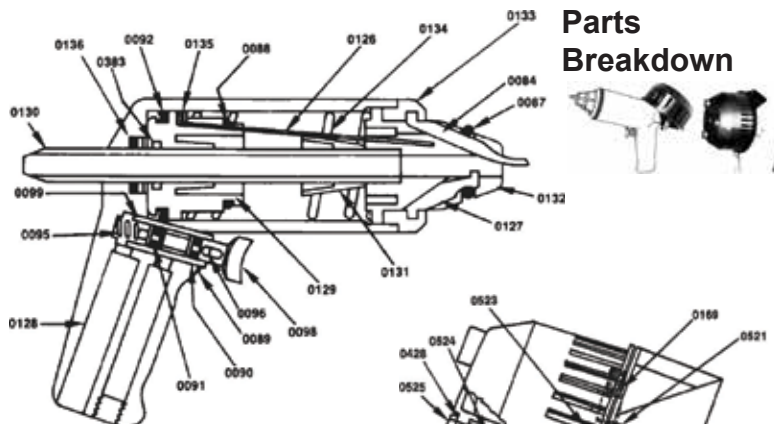

**STUD GUN PARTS (AS-9 MODEL)**

| Part No. | Description        |
|----------|--------------------|
| 0084     | External Finger    |
| 0087     | O-Ring             |
| 0088     | O-Ring             |
| 0089     | O-Ring             |
| 0090     | O-Ring             |
| 0091     | O-Ring             |
| 0092     | Piston Cup         |
| 0095     | Trigger Spring     |
| 0096     | Trigger Pin        |
| 0098     | Trigger            |
| 0099     | Trigger Sleeve     |
| 0126     | Pressing Spring    |
| 0127     | Internal Finger    |
| 0128     | Handle Body        |
| 0129     | Piston             |
| 0130     | Feed Tube          |
| 0131     | Tapered Sleeve     |
| 0132     | Head (Steel)       |
| 0133     | Ring Nut           |
| 0134     | Compression Spring |
| 0135     | Ring               |
| 0136     | O-Ring             |
| 0383     | Piston Cup         |

**STUD FEEDER PARTS (KFP2 MODEL)**

| Part No. | Description      |
|----------|------------------|
| 0169     | Deflector Spring |
| 0172     | Snap Ring        |
| 0173     | Screw            |
| 0174     | Washer           |
| 0175     | Clamp            |
| 0180     | Drive Shaft Pin  |
| 0428     | Washer           |
| 0519     | Feed Wheel       |
| 0520     | Base Plate       |
| 0521     | Retaining Ring   |
| 0522     | Feed Tube        |
| 0523     | Screw            |
| 0524     | Shaft            |
| 0525     | Hex Bolt         |

## Stud Gun Repair & Conversion Kits

| ASCOT NO. | STUDDING GUN | USE WITH STUDS NUMBERED   |
|-----------|--------------|---|
| 458-03810 | 0381         | <b>Tire Stud Mini Repair Kit.</b> INCLUDES: (3) 0084 External Fingers; (1) 0087 O-ring; (1) 0088 O-ring; (3) 0126 Pressing Springs  |
| 458-03820 | 0382         | <b>Tire Stud Gun Large Repair Kit.</b> INCLUDES: (6) 0126 Pressing Springs; (3) 0084 External Fingers; (2) 0087 O-ring; (2) 0088 O-ring; (1) 0092 Piston Cup; (1) 0136 O-ring |



## Tire Bags, Seat Protectors, Steering Wheel Covers, Paper Floor Mats, Parts Bags

### Dispensing Racks

Centralize your cleanliness products for the professional image your business needs and the convenience your employees deserve. The top tray holds paper floor mats and elastic band steering wheel covers. Rollers are for seat covers, tire bags, and parts bags.



#PSC



#SWC - 500 ea



250 Bags! - HDTB



#FPFM

| Order No. | Description                             | Ship Wt. Lbs. |
|-----------|---|---------------|
| PSC       | Seat Protectors - Roll of 500           | 20            |
| SWC       | Car Steering Wheel Covers - 500 pkg     | 10            |
| HDTB      | Large Tire Bag for SUV - Roll of 250    | 30            |
| FPFM      | Heavy Duty Paper Floor Mat - Box of 500 | 32            |
| WPB       | Parts Bags, 12" x 20" - Roll of 500     | 15            |
| DR        | Dispenser Stand Only                    | 25            |
| 41110     | Large Tire Bag - Roll of 100            | 13            |



#WPB

Chain 'Em Up is a HD, non-skid, drive on/off ramp with safety features that will shorten your chain up time to one simple step and allow you to accomplish chaining up in just minutes!

**LARGE WEIGHT CAPACITY**  
Tested to support maximum truck and cargo loads.

**VERSATILE UTILITY TOOL**  
Great for any maintenance on elevated tires, quicker and easier than a jack.

**LIGHT WEIGHT**  
Easy to carry and maneuver.

**STRONG AND DURABLE**  
High-impact plastic.

**4" LIFT HEIGHT**  
Heavy-Duty Non-Skid Traction.



# CHAIN 'EM UP



**\$99.95**  
each ramp  
#Ramp1

Featuring advanced engineering and durable, high-impact plastic to support CMV weights while still being light-weight.

**INSTALLING CHAINS ON TIRES THAT ARE ELEVATED IS JUST EASIER – PURE AND SIMPLE!**

Largest stock of tire chains in the Rocky Mountain Area!

### Laclede™ Wide Base Truck Chains

| Tire Sizes    |                 |             | Non-Cam Stock No. | Cam Stock No. |
|---------------|-----------------|-------------|-------------------|---------------|
| 8.25-15LT     | 275/70R16LT     | 235/75R17.5 | 3210R             | 3210CAM       |
| 10-15LT       | 285/65R16       | 245/70R17.5 |                   |               |
| 265/70R15LT   | 295/50R16LT     | 245/75R17.5 |                   |               |
| 265/75R15LT   | 235/80R17       | 255/65R18   |                   |               |
| 305/50R15     | 245/75R17LT     | P255/70R18  |                   |               |
| 31X10.50-15LT | 255/60R17       | P265/65R18  |                   |               |
| 33X10.50-15   | P255/70R17      | 255/70R18   |                   |               |
| P265/70R16    | P265/65R17      | 275/55R18   |                   |               |
| P265/75R16    | P265/70R17      | 265/50R19   |                   |               |
| 245/85R16LT   | 265/60R17       | 275/55R19   |                   |               |
| 265/70R16LT   | 265/70R17LT     | 225/70R19.5 |                   |               |
| 265/75R16LT   | 265/75R17       | 245/60R20   |                   |               |
| 265/80R16LT   | 275/65R17       | 265/60R20   |                   |               |
| PR78-15       | 275/65R16LT     | 305/45R17   | 3227R             | 3227CAM       |
| 11-15LT       | 285/60R16LT     | P265/60R18  |                   |               |
| 31X11.50-15LT | 32X11.50-16LT   | 285/60R18   |                   |               |
| 32X11.50-15LT | 33X13.50-16     | 285/65R18LT |                   |               |
| 33X9.50-15LT  | 34X9-16         | 285/45R19   |                   |               |
| 33X13.50-15   | 12-16.5LT       | 275/60R20   |                   |               |
| 34X9.50-15LT  | 31X10.50-16.5LT | P285/50R20  |                   |               |
| PR78-16       | 285/60R17       |             |                   |               |
| P285/60R16    | 285/70R17       |             |                   |               |
| 275/75R16     | 265/70R18       | 275/50R20   | 3228R             | 3228CAM       |
| 285/75R16LT   | P275/60R18      | 275/45R21   |                   |               |
| 31X12.50-16   | 275/65R18       |             |                   |               |
| 12-15LT       | 35X12.5-16      | 295/70R18LT | 3229R             | 3229CAM       |
| P315/70R15    | 35X13.5-16      | 325/60R18   |                   |               |
| 325/60R15     | 36X13-16        | 33X12.5-18  |                   |               |
| 31X13.5-15    | 32X12.50-16.5LT | 33X13-18    |                   |               |
| 32X12.50-15   | 33X12.5-16.5    | 275/65R20LT |                   |               |
| 33X12.50R15   | 33X15.5-16.5    | 285/55R20LT |                   |               |
| 33X14-15      | 275/70R17       | 285/60R20   |                   |               |
| 33X14.50-15   | 285/75R17LT     | 295/55R20   |                   |               |
| 35X12.50-15   | 295/70R17LT     | 305/50R20   |                   |               |
| 35X14.5-15    | 305/65R17       | 305/55R20   |                   |               |
| 11L16         | 305/70R17       | 32X11.50-20 |                   |               |
| 285/70R16LT   | 33X12.50-17     | 33X12.5-20  |                   |               |
| 295/75R16LT   | 10.50/80R18     | 285/50R22   |                   |               |
| 305/70R16LT   | 275/70R18LT     | 33X11.5-22  |                   |               |
| 305/85R16LT   | 285/75R18LT     |             |                   |               |
| QR78-15       | 315/70R17LT     | 35X12.5-18  | 3231R             | 3231CAM       |
| 35X13.5-15    | 325/70R17       | 285/65R20   |                   |               |
| 37X13-15      | 345/55R17       | 295/65R20   |                   |               |
| 315/75R16LT   | 35X12.50-17     | 325/60R20   |                   |               |
| 345/55R16LT   | 37X12.50-17     | 35X12.50-20 |                   |               |
| 37X12.50-16   | 305/60R18       | 325/50R22LT |                   |               |
| 38X13-16      | 305/70R18LT     | 35X12.5-22  |                   |               |
| 38X12.50-16.5 | 325/65R18       | 295/60R22.5 |                   |               |
| 35X14-15      | 36X14-16.5      | 37X13.5-18  | 3235R             | N/A           |
| 36X12.50-15   | 37X12.5-16.5    | 285/70R19.5 |                   |               |
| 36X13.5-15    | 38X15.5-16.5    | 275/75R20   |                   |               |
| 37X13.50-15   | 355/70R17LT     | 37X12.50-20 |                   |               |
| 35X14-16      | 37X13.5-17      |             |                   |               |
| 36X12.5-16.5  | 14-17.5         |             |                   |               |
| 37X14.50-15   | 38X14.50-16     | 37X13.50-20 | 3251R             | N/A           |
| 39.5X15-15    | 39.5X15-16.5    | 37X13.50-22 |                   |               |
| 40X17-15      | 40X17-16.5      |             |                   |               |
| 325/80R16     | 355/65R18       |             |                   |               |
| 355/80R20     | 15-22.5         |             | 3255R             | 3255CAM       |
| 13-22.5       | 385/65R22.5     |             |                   |               |
| 18-22.5       | 445/65R22.5     |             | 3261R             | N/A           |
| 38.5X16-15    | 39.5X15-16      | 15-19.5     | 3265R             | N/A           |
| 39.5X18-15    | 39.5X18-16.5    | 38X15.50-20 |                   |               |
| 38.5X16-16    | 38X15.5-18      |             |                   |               |
| 445/50R22.5   | 455/55R22.5     |             | 3269R             | 3269CAM       |
| 445/65R19.5   | 16.5-22.5       | 425/65R22.5 | 3271R             | 3271CAM       |

### Grader Chains

| Tire Sizes  | Tire Chain Stock No. |           |
|-------------|----------------------|-----------|
| 13.00-24/25 | 14.00-20/21          | 15.5-25   |
| 14.00-24    | 14.00-25             | 400/75R28 |
| 16.00-20/21 | 17.5-25              |           |
| 16.00-24    | 16.00-25             |           |
| 20.5-25     |                      |           |
| 18.00-25    | 18.00-24             | 18.00-26  |
| 23.5-25     |                      |           |
| 26.5-25     | 755/70R25            | 30.5R32   |
| 710/70R38   |                      | 800/65R32 |

### LG Cam Series Available



Wide Base Truck Cam Chains

Dual Truck Chains

DUO Tractor Chains

### Tractor Chains

| Tire Sizes |            |           |           |           | Stock No. |
|------------|------------|-----------|-----------|-----------|-----------|
| 9.5-24     | 9.5-28     | 11.2-24   |           |           | DUO214    |
| 9.5-32     | 11.2-28    | 230/95R32 | 355/80R20 |           | DUO226    |
| 10.5/80-18 | 12-16.5    | 280/70R20 | 300/70R20 | 315/75D15 | DUO225    |
| 12.4-24    |            |           |           |           | DUO229    |
| 9.5-36     | 9.5-38     | 11.2-32   | 12.4-28   |           | DUO218    |
| 13.9-36    | 320/85R34  |           |           |           | DUO242    |
| 13.6-24    | 13.6-26    | 14.9-24   |           |           | DUO240    |
| 14.9-26    |            |           |           |           | DUO250    |
| 14.9-28    | 14.9-30    |           |           |           | DUO252    |
| 13.6-28    | 16.9-24    | 320/85R38 | 340/85R28 | 380/85R34 | DUO260    |
| 14.9-38    | 15.5-38    | 320/90R46 |           |           | DUO254    |
| 17.5-24    | 17.5L-24   |           |           |           | DUO263    |
| 16.9-26    | 16.9-28    | 420/85R28 |           |           | DUO262    |
| 18.4-16.1  | 21.5L-16.1 |           |           |           | DUO264    |
| 18.4-24    | 19.5L-24   |           |           |           | DUO268    |
| 16.9-30    | 18.4-26    | 18.4-28   | 18.4-30   | 540/65R30 | DUO271    |
| 550/65R25  | 600/65R28  |           |           |           |           |
| 18.4-34    | 480/85R34  | 600/65R25 |           |           | DUO273    |
| 16.9-38    | 18.4-38    | 20.8-34   | 420/80R46 | 460/85R34 | DUO272    |
| 480/80R38  |            |           |           |           |           |
| 18.4-42    | 18.4-46    | 380/90R54 | 480/80R46 |           | DUO277    |
| 20.8-38    |            |           |           |           | DUO276    |
| 24.5-32    | 23.1-34    | 28.1-34   | 620/70R42 | 650/75R32 | DUO282    |

### Tire Chain Adjusters

|                          |                |                 |                |                          |
|--------------------------|----------------|-----------------|----------------|--------------------------|
|                          |                |                 |                |                          |
| Passenger Car No. 29110  | Truck No. 6032 | Grader No. 6304 | Truck No. 0218 | Passenger Car No. 39110  |
| Trucks Nos 29925 & 29229 |                |                 |                | Trucks Nos 39925 & 39229 |

| Ascot No. | Mfg. No. | Description                     | Qty.                 |
|-----------|----------|---------------------------------|----------------------|
| 458-29110 | 29110    | Passenger Car - Rubber          | 2 per bag            |
| 458-29225 | 29225    | Light Truck - Rubber            | 2 per bag            |
| 458-29229 | 29229    | Heavy Truck - Rubber            | 2 per bag            |
|           | 0218     | Spider Truck                    | 2 per bag            |
| 458-06302 | 6302     | Light Truck - Spring            | 1 pair per container |
| 458-06304 | 6304     | Tractor/Grader - Spring         | 1 pair per container |
|           | 39110    | Passenger Car - Rubber Arm Blue | 2 per bag            |
|           | 39225    | Light Truck - Rubber Arm Grey   | 2 per bag            |
|           | 39229    | Heavy Truck - Rubber Arm Green  | 2 per bag            |



## Laclede Single Truck Chains

- Recommended for high-way use
- Available in R—regular side chain
- Available with cam side chain



| Tire Sizes  |             |               |             |             | Non-Cam Stock No. | Cam Stock No. | Weight Per Pair | Cross Chains Per 1/2 Pair | Replacement Cross Chain |
|-------------|-------------|---------------|-------------|-------------|-------------------|---------------|-----------------|---------------------------|-------------------------|
| 7.00-14LT   | P205/75R14  | 28X8.50-14    |             |             | 2209R             | N/A           | 19              | 11                        | 6219                    |
| 185-14      | 195/75R14LT | 205/60R17.5   |             |             |                   |               |                 |                           |                         |
| H70-14ST    | H78-15ST    | 6.70-15LT     | P215/75R15  | 7-17.5LT    | 2211R             | 2211CAM       | 23              | 13                        | 6219                    |
| H78-14ST    | LR78-15     | 7.00-15LT     | 195/75R15LT |             |                   |               |                 |                           |                         |
| 215/75R14LT | P235/75R15  | P225/70R16    | 255/60R16   | P235/65R17  | 2216R             | 2216CAM       | 22              | 12                        | 6221                    |
| 9-14.5MH    | 215/75R15LT | P225/75R16    | 255/75R16LT | 235/65R17   |                   |               |                 |                           |                         |
| H78-15LT    | 30X9.50-15  | 205R16        | 8.00-16.5   |             |                   |               |                 |                           |                         |
| P225/75R15  | 6.50-16LT   | 225/75R16LT   | P235/60R17  |             |                   |               |                 |                           |                         |
| 7.00-15TR   | 245/75R15LT | 235/75R16LT   | 8-17.5      | P255/45R18  | 2219R             | 2219CAM       | 24              | 13                        | 6221                    |
| 7.50-15LT   | 7.00-16LT   | 245/70R16LT   | 8.50-17.5   | 225/65R18   |                   |               |                 |                           |                         |
| P275/60R15  | 8.75-16LT   | 255/65R16LT   | 215/70R17.5 | 235/60R18   |                   |               |                 |                           |                         |
| 235/75R15LT | 215/80R16LT | 8.75-16.5     | P235/50R18  | 235/65R18   |                   |               |                 |                           |                         |
| 245/70R15LT | 215/85R16LT | P235/70R17    |             | 245/55R19   |                   |               |                 |                           |                         |
| NR78-15     | LR78-16     | 9.50-16.5     |             |             | 2221R             | 2221CAM       | 26              | 14                        | 6221                    |
| 7.50-15TR   | 7.50-16LT   | 7.00-17LT     |             |             |                   |               |                 |                           |                         |
| 275/60R15LT | 235/85R16LT | 215/75R17.5   |             |             |                   |               |                 |                           |                         |
| 7.50-17     | 245/70R17LT | 225/70R17.5   | 7.00-18     | 8-19.5      | 2214R             | 2214CAM       | 28              | 15                        | 6221                    |
| P245/65R15  | P245/75R16  | 265/60R16LT   | P245/65R17  | P255/55R18  | 2229R             | 2229CAM       | 24              | 12                        | 6225                    |
| P245/70R15  | P255/65R16  | 275/60R16LT   | P245/70R17  | 255/55R18   |                   |               |                 |                           |                         |
| P255/70R15  | P255/70R16  | 30X9.50-16LT  | P255/55R17  | 255/60R18   |                   |               |                 |                           |                         |
| P265/70R15  | P275/60R16  | 31X11.50-16   | P255/60R17  | 235/55R19   |                   |               |                 |                           |                         |
| P265/75R15  | 235/70R16LT | 32X9-16LT     | P255/65R17  |             |                   |               |                 |                           |                         |
| 255/75R15LT | 235/80R16   | 32X10.00-16LT | P275/60R17  |             |                   |               |                 |                           |                         |
| 29X9.50-15  | 245/75R16LT | 10-16.5LT     | 225/75R17LT |             |                   |               |                 |                           |                         |
| P235/70R16  | 255/70R16LT | P235/75R17    | 245/65R17   |             |                   |               |                 |                           |                         |
| P245/70R16  | 265/50R16LT | P245/55R17    | 275/60R17   |             |                   |               |                 |                           |                         |
| 8.25-15TR   | P275/70R16  | 245/70R19.5   | 275/55R20   |             | 2228R             | 2228CAM       | 27              | 14                        | 6225                    |
| 285/75R15   | 255/85R16LT | P275/60R20    |             |             |                   |               |                 |                           |                         |
| 7.50-18     | 265/70R19.5 | 6.50-20       | 7.00-20     |             | N/A               | 2233CAM       | 38              | 11                        | 6251                    |
| 9.00-15TR   | 9R17.5      | 7.50-20       | 235/80R22.5 | 255/70R22.5 | 2237R             | 2237CAM       | 40              | 12                        | 6251                    |
| 9.00-16LT   | 10R17.5     | 8-22.5        |             |             |                   |               |                 |                           |                         |
| 10-15TR     | 11R17.5     | 9-22.5        | 275/70R22.5 |             | N/A               | 2239CAM       | 44              | 13                        | 6251                    |
| QR78-16     | 8.25-20     | 245/75R22.5   |             |             |                   |               |                 |                           |                         |
| 9.00-20     | 10-22.5     | 255/80R22.5   | 265/75R22.5 |             | 2241R             | 2241CAM       | 46              | 14                        | 6251                    |
| 10.00-20    | 11-22.5     | 275/80R22.5   |             |             | 2245R             | 2245CAM       | 49              | 15                        | 6251                    |
| 285/75R22.5 | 295/75R22.5 | 305/70R22.5   | 275/80R24.5 | 285/75R24.5 | 2247R             | 2247CAM       | 48              | 14                        | 6253                    |
| 10.00-22    | 11-24.5     |               |             |             | 2249R             | 2249CAM       | 53              | 15                        | 6253                    |
| 11.00-15TR  | 11.00-20    | 12-22.5       | 12.5-22.5   | 295/80R22.5 | 2251R             | 2251CAM       | 62              | 14                        | 6260                    |
| 12.00-20    | 13/80R20    | 11.00-22      | 315/80R22.5 | 12-24.5     | 2255R             | 2255CAM       | 67              | 14                        | 6263                    |



## Laclede Snow Blower & Garden Tractor Chains

| Tire Sizes     |                 | Stock No. |
|----------------|-----------------|-----------|
| 4.00/4.80 x 8  |                 | 1301G     |
| 16 x 6.50 x 8  | 15 x 6.00 x 6   | 3300G     |
| 18 x 8.50 x 8  |                 | 3307G     |
| 20 x 10 x 8    | 20 x 10 x 10    | 7145G     |
| 20 x 8.00 x 10 | 20 x 8 x 8      | 1308G     |
| 23 x 9.50 x 12 | 23 x 10.50 x 12 | 5307G     |

Other sizes available - call for details.



## Laclede Forklift Chains

- Square link alloy cross chains

| Tire Sizes   |               |              |         | Stock No. |
|--------------|---------------|--------------|---------|-----------|
| 6.50-10      |               |              |         | 2108FL    |
| 7.50-10      | 7.00-12       | 25 x 8.50-14 |         | 2110FL    |
| 7.00 x 15    | 28 x 9-15     | 29 x 8-15    | 8.15-15 | 2116FL    |
| 27 x 8.50-15 | 28 x 9.50-15  |              |         |           |
| 7.50-15      |               |              |         | 2121FL    |
| 250-15       | 27 x 10.50-15 |              |         | 2129FL    |
| 8.25-15      |               |              |         | 2128FL    |
| 300-15       | 28 x 12.50-15 |              |         | 3129FL    |



## Laclede ATV/UTV Chains

- Reinforced cross chain for increased wear and traction
- Two link spacing cross chain

| Tire Sizes   |              |              |              |              | Stock No. |
|--------------|--------------|--------------|--------------|--------------|-----------|
| 24 x 9 x 11  | 24 x 11 x 11 | 25 x 10 x 11 | 25 x 11 x 12 | 26 x 10 x 12 | 618       |
| 24 x 11 x 9  | 24 x 11 x 12 | 25 x 10 x 12 | 26 x 9 x 12  | 26 x 10 x 14 |           |
| 24 x 11 x 10 | 25 x 8 x 12  | 25 x 11 x 9  | 26 x 9 x 14  |              |           |
|              |              |              |              |              |           |

Call for details on other sizes.



# McGEE COMPANY

**Denver (HDQTR)**  
1140 South Jason St.  
Denver, CO 80223

**(800) 525-8888**

(303) 777-2615  
FAX (303) 777-7140

**Salt Lake City**  
1101 S. 700 West  
Salt Lake City, UT 84104

**(800) 525-8888**

(801) 487-8751  
FAX (801) 487-8753

**Albuquerque**  
4412 Prospect NE  
Albuquerque, NM 87110

**(800) 525-8888**

(505) 883-9613  
FAX (505) 883-1382

**Dallas**  
8504 Chancellor Row  
Dallas, TX 75427

**(800) 525-8888**

(214) 689-0400  
FAX (214) 689-0448

# Traction Laws in Colorado and California!

## CALIFORNIA

California Alternative Traction Devices (ATD)-Section 1070-1074-Title 13 California code of regulations. As of July 1, 2019, the California Highway Patrol (CHP) new regulations require all ATD to prove they can exceed or equal the performance of approved metal traction devices in all aspects of traction. The specifics of the traction requirements are outlined in the new regulation and follow the ÖNORM Austrian standards for traction devices. AutoSock® meets the ÖNORM standards and each pair of AutoSock® are the only textile ATD labelled as required in California with the ÖNORM symbol of compliance. AutoSock® can be used instead of tire chains in California.

## COLORADO

House Bill 19-1207 changes the game in Colorado for passenger vehicles. Starting August 2, 2019, the legislation updated requirements for drivers using state highways during winter months. Specifically, it changed the required minimum tire tread for vehicles on snowy roads to 3/16 of an inch. The law reaffirms the department's ability to close state highways during inclement weather, and requires any motor vehicles to have one or more of the following:

- Tire chains
- A CDOT approved alternative traction device like AutoSock®
- Four-wheel drive with adequate tire tread
- All-wheel drive with adequate tread and/or
- Tires with manufacturer marking for snow/mud and adequate tread



ÖNORM symbols

**Be wary of textile traction devices that don't have the ÖNORM label and are not approved for use in all States!**

## AutoSock has the OE Approvals!



Why sell or use **AutoSock**?

- ⊕ OE trusted & approved by name
- ⊕ The original ATD pioneered by textile scientists
- ⊕ Fewer SKUs than the competition
- ⊕ Faster/easier to put on than chains
- ⊕ Multilayered design for durability & wear indications
- ⊕ Approval all the way through six axel vehicles throughout the US

AutoSock is mentioned by name in the above OE manuals.

**AutoSock** is approved by leading international car manufacturers.

[www.AutoSock.us](http://www.AutoSock.us)





Showroom displays  
for the floor or  
counter available!

**DISTRIBUTORS  
WANTED**



A specially designed surface  
pattern that makes the total  
contact area exposed to dry  
friction as large as possible.

- ⊕ Less weight than chains
- ⊕ No damage to vehicle
- ⊕ No climbing under vehicles to grab broken chains
- ⊕ Great for low wheel clearance vehicles
- ⊕ Faster to put on, less than 5 minutes!



AutoSock® gets fuzzy  
“hairs” between and  
at the contact areas  
in order to increase  
the friction on snow  
and ice.

Mesh keeps snow  
out of the tread and  
wheel well while the  
orange straps help  
with centering and  
easy removal.

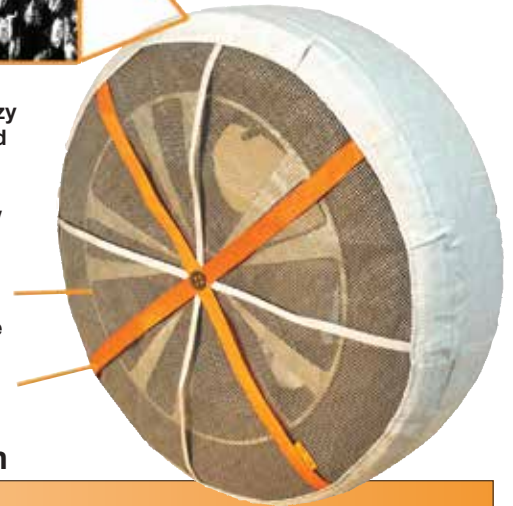

## Colorado DOT demonstration

### AutoSock for Passenger Cars - Max. Traction Force on Snow

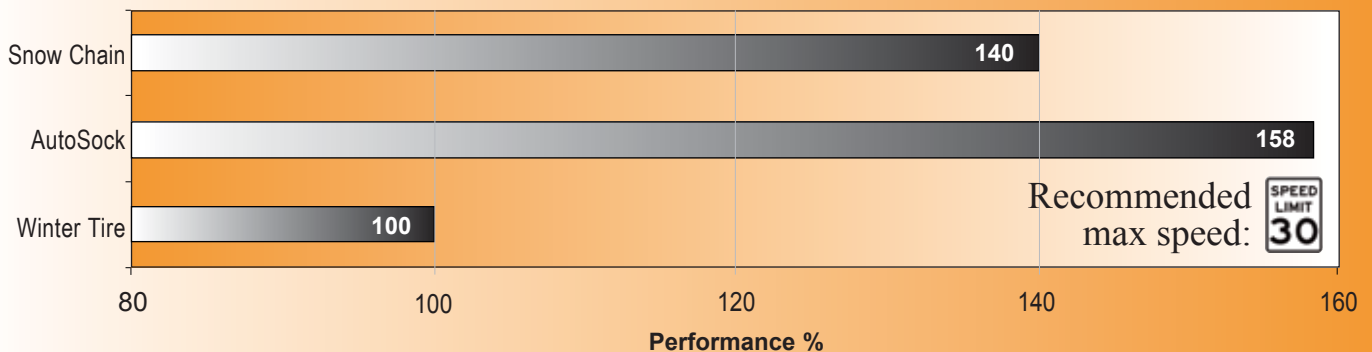

DATE: Dec 06 2007

AIR TEMP.: -7°C/25°F

TIRE SIZE: 205/55 R16

INFLATION FA: 3.0 bar

TEST VEHICLE: Pontiac FWD

LOCATION: Loveland Pass

CONDIT.: Dry snow, cloudy

ABS: on

INFLATION RA: 3.0 bar

TEST SURFACE: Packed Snow

### AutoSock for Truck - Max. Traction Force on Snow

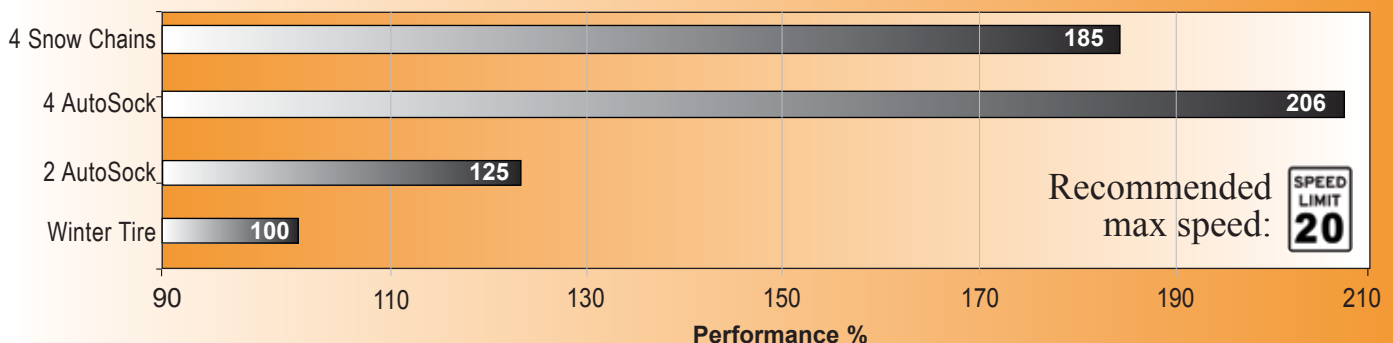

DATE: Dec 06 2007

AIR TEMP.: -7°C/25°F

TIRE SIZE: 295/70 R22.5

INFLATION FA: 8.0 bar

TEST VEHICLE: Peterbilt

LOCATION: Loveland Pass

CONDIT.: Dry snow, cloudy

ABS: on

INFLATION RA: 8.0 bar

TEST SURFACE: Packed Snow



**McGee Company**  
1140 South Jason Street  
Denver CO 80223

PRSRT STD  
U.S. POSTAGE  
**PAID**  
DENVER, CO  
PERMIT NO 1772



**ATTN: ROUTE TO SERVICE DEPARTMENT**

©2021 McGee Company, Denver, Colorado

**McGeeCompany.com • 1-800-525-8888**



**McGeeCompany.com  
Online Resources**

- Product breakdowns
- SDS
- TPMS charts
  - Schrader
  - Dill
  - Autel
- Used equipment
- Tutorial videos
- Online shopping
  - Build shopping lists
  - Review previous orders
  - See detailed photos
  - View invoices

*McGee Company offers free assembly of air hose to your required length!*



**Air Hose**

- Rubber Air Hose
- 1/4", 3/8" & 1/2" Multi Purpose Air Hose Assemblies Smooth cover, 300 PSI W.P., 1,200 lb. burst. Limited oil resistance tube & cover. Red.

Made in the USA



| Mfg. No. | Description               | Price          |
|----------|---------------------------|----------------|
| W64RJ25  | 25', 3/8" Hose, 1/4" MNPT | <b>\$29.65</b> |
| W64RJ50  | 50', 3/8" Hose, 1/4" MNPT | <b>\$59.68</b> |
| W84RJ25  | 25', 1/2" Hose, 1/2" MNPT | <b>\$48.79</b> |
| W84RJ50  | 50', 1/2" Hose, 1/2" MNPT | <b>\$87.64</b> |

**Branick Strut Spring Compressor**

The new Model 7600 has all the features you expect from Branick and more. It's the new answer for all your strut work.

The 7600 can handle the heaviest coil-over-shocks, the Ford F-150 and even the Toyota RAV-4 without need for additional adaptors.

Extra long springs? Bring 'em on! Long, short, narrow or angled, the 7600 will easily do the job! And we're listening too... We opened up the front for easier access and added longer handles for extra torque. We also have an optimal benchmount and mobile cart.



**SPECIAL \$829.00** (Stand sold separately)

**COATS • HUNTER • CEMB**  
Changers, Balancers, Lathes

**HUNTER • CEMB • ROTARY**  
Alignment Equipment

**ROTARY • NORCO • RPG • AFF**  
Lifts, Hydraulics, Jacks

**QUINCY • CHAMPION • CP**  
Air Compressors

**GRACO • RHINO • OIL STORAGE**  
Lubrication

**Coats Special ~ \$7,195.00**  
**60XE1**

Limited  
Quantity!  
In Stock

- Swing Arm Design
- Air or 110v Electric Motor
- Built-in Water Separator (Air)
- 6"-24" External Clamping Range
- Metal Clamps
- Hand Actuated Bead Loosener
- Single Point Sealer
- Extended Warranty
- Patented Robo-Arm®
- Metal and Plastic Duckhead

