



INSTRUCTION SHEET

**BALCRANK
2700 SERIES
STANDARD HOSE REEL**

MODEL NO.	PART NO.
LOW PRESSURE	
2775	810843
2785	810844
	819912
MEDIUM PRESSURE	
2740	810839
2745	810840
2765	810841
2772	810842
HIGH PRESSURE	
2720	810834
2720A	810835
2720B	810836
2720BA	810837
2720-25	814547
	819911

INSTALLATION:

- Cabinet Mount:**
The hose reel is shipped ready to use, no assembly is required for the basic reel.
- Setting The Hose Stop:**
The hose reel is adjusted prior to shipment and should not require further adjusting. However, should adjustment become necessary, remove the attached control handle and rubber bumper stop.
CAUTION: Never let the hose slip or retract as this could cause damage to the spring. Thread the hose back into the reel and down through the roller outlet. To increase tension, thread the hose around the spool in the direction that the hose pulls out. One complete revolution should be sufficient. Then pull the hose completely out to see if the ratchet releases. To decrease tension, let the hose unwind one revolution. Then replace the bumper stop and control handle.
- For Piping Installation to Pumps, Refer to Chart 1:**

IMPORTANT: Before installation of reels, flush out piping by connecting respective materials used to corresponding lines, operate pump to flush lines. After flushing, dispose of the oil (in an approved manner) as it may contain foreign matter.

PRODUCT DESCRIPTION:

The 2700 Series standard duty spring actuated reel is designed to be used with the Deluxe multiple reel cabinet. A hardened steel ratchet allows the operator to latch the reel at any desired point and a slight pull is all that is required to release the latch which allows the hose to be retracted slowly and evenly.

INSTALLATION PIPING SPECIFICATIONS

PUMPS		TYPE OF REELS	
"JET POWER" SERIES		H.P. GREASE	M.P. OILS
			L.P. AIR & WATER
TUBING (DEAD SOFT)	Less Than 200 ft. Over 200 ft. Fittings	5/8" O.D. x .083" Wall 3/4" O.D. x .095" Wall Heavy Series	5/8" O.D. x .035" Wall 7/8" x .035" Wall Standard
PIPE	Less Than 200 ft. Over 200 ft. Fittings	Pipe is Not Recommended For H.P. Grease Lines	1/2" Standard 3/4" Standard Standard
SHUT-OFF VALVE		Balcrank Model 111-1	Balcrank Model 111-2
"GIANT JET" SERIES			
TUBING (DEAD SOFT)	Less Than 200 ft. 200 ft. to 500 ft. Over 500 ft. Fittings	3/4" O.D. x .095" Wall 7/8" O.D. x .109" Wall 1" O.D. x .120" Wall Heavy Series	7/8" O.D. x .035" Wall 1" O.D. x .049" Wall 1 1/4" O.D. x .065" Wall Standard
PIPE	Less Than 200 ft. 200 ft. to 500 ft. Over 500 ft. Fittings	Pipe is Not Recommended For H.P. Grease Lines	1/2" Standard 3/4" Standard 1 1/2" Standard Standard (Malleable)
SHUT-OFF VALVE		Balcrank Model 111-1	Balcrank Model 111-2
			W.O.G. Ball Valve





INSTRUCTION SHEET

OPERATION:

No special instructions are required for the operation of the hose reel. The extension and retraction of the hose reel is accomplished by applying tension to the hose.

CAUTION: Before the removal of the roller outlet assembly, the uprights should be secured against accidental separation of the hose reel.

DISASSEMBLY/ASSEMBLY:

1. Left Hand Upright Removal:
 - a. Pull the hose out, lock the spool and remove hose. Release the locking device and slowly let the spool assembly unwind, while counting the revolutions. The tension from the spring item No. (6) will diminish.
 - b. Remove the swivel item No.'s (39, 40, or 55) from the hub item No.'s (14 or 15).
 - c. Remove the outlet assembly by unscrewing the screws item No.'s (25 & 51) from the elastic nuts item No. (1) and hex nuts item No. (11). Then remove the left hand upright item No. (50).
2. Stop Pawl Removal:

To remove the stop pawl assembly, item No. (22), place left upright in a vise. Remove the nut, item No. (24) which holds the screws, item No. (36) to the left hand upright. Remove the spring, item No. (35) from the cotter pin, item No. (37) and then the cotter pin itself. Using a small punch drive the roll pin, item No. (38) out of the collar, and push the bushing, item No. (23) out of the upright.

CAUTION: Make sure the power spring tension is released before any disassembly is done to the hose reel. Power spring repair steps No. 3 and 4 should be performed by an authorized service representative.

3. Power Spring Removal:

To remove the power spring, item No. (6), remove the cap screws, item No.'s (25 & 51), holding right upright to base, item No. (52), and top support bracket, item No. (28). Then place the side rail in a vise so that the spring case item No. (5) is horizontal. Remove the hair pin, item No. (8), cotter pins, item No. (4), and spring case cover, item No. (7). Grasp the old spring (outside the coils) near the pin, on the spring case with vise grips, and pull the spring out of the case. Before removing the vise grips, use a

small length of wire to bind the power spring so that it will not uncoil freely.

4. Power Spring Replacement:

Place new spring in case so that, starting from outside coil, spring is wound clockwise. Replace cover, item No. (7) and the cotter pins, item No.'s (4 & 8). Be sure spring center plates, item No. (10), are positioned on hub to receive center loop of spring, also make sure that the outer loop of spring is positioned on the pin. With hose completely coiled on spool (Control Handle Removed) wind hose reel spool assembly, item No. (13) in direction spool would turn if hose were being pulled out the same number of turns as was counted in section 1a of the disassembly/assembly procedure. (See section for adjusting tension).
5. Replacing Hose:

To replace hose, pull hose out, lock hose reel spool assembly, item No. (13), remove hose, replace with new hose, let hose rewind. This method will eliminate resetting tension.

TO ASSEMBLE:

Reverse the above procedures where applicable.

PREVENTATIVE MAINTENANCE:

No preventative maintenance is necessary.

CORRECTIVE MAINTENANCE:

1. General Overhaul:

Disassemble the hose reel according to the procedures in the disassembly/assembly section. Inspect parts for damage and wear. Replace parts if necessary. Re-assemble the hose reel by following the assembly procedure.
2. Reel Adjustments:

See installation; setting hose stops.
3. Power Spring Removal:

See disassembly; power spring removal.

CAUTION: Use extra care in removing the power spring and its adjacent components. Never remove outlet pipe, item No.'s (22 or 23) with tension on the power spring as this could result in damage to the power spring. Lack of caution could result in personal injury.

NOTE: Do not detach the control handle disconnect hoses or piping unless the supply pump has been completely shut off and the system pressure has been relieved.

NOTE: The working pressure of a reel assembly is governed by the hose selection. Hose specifications are found in the general catalog. The pressure rating of Bare Reels is as follows:
LOW PRESSURE REEL: (300 PSI).
MEDIUM PRESSURE REEL: (1600 PSI).
HIGH PRESSURE REEL: (6700 PSI).

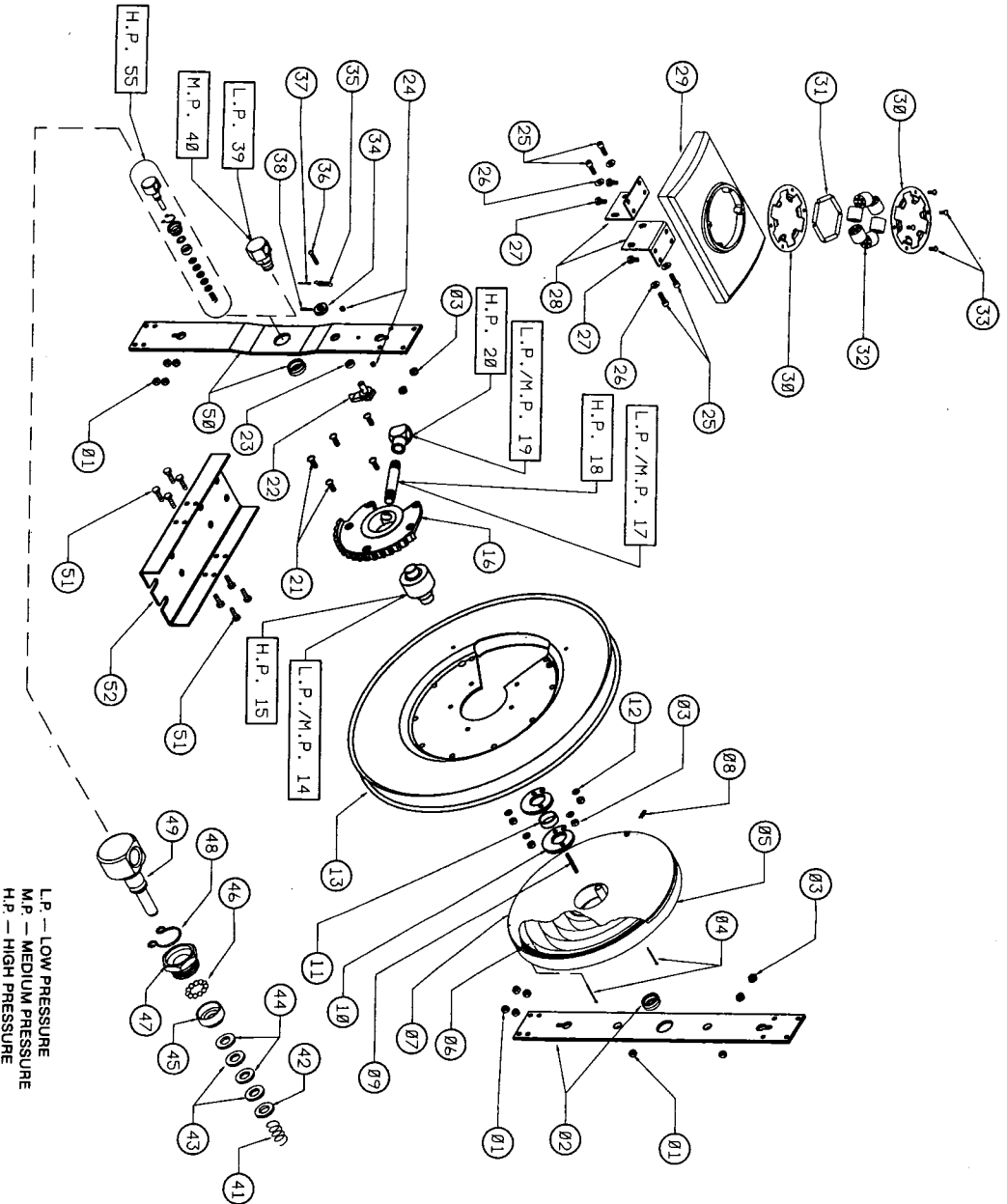

L.P. — LOW PRESSURE
M.P. — MEDIUM PRESSURE
H.P. — HIGH PRESSURE

BILL OF MATERIALS

ITEM NO.	MODEL NO.	PART NO.	DESCRIPTION	QTY.
1	63772	813561	1/4-20 ELASTIC LOCK NUT	10
2	43539	810807	RIGHT HAND UPRIGHT ASSEMBLY	1
3	21244	806592	1/4-20 HEX NUT	9
4	39611	808718	3/32 x 1-1/4 COILER PIN	1
5	41231	809439	SPRING CASE ASSEMBLY	2
6	32724	806890	POWER SPRING	1
7	32725	806892	SPRING CASE COVER	1
8	27618	806452	HAIR PIN	1
9	38613-3	808766	7/32 x 1-1/2 ROLL PIN	1
10	64154	813179	SPRING CENTER PLATE	2
11	39262	809023	1/4 LOCK WASHER	1
12	17132	805784	HOSE REEL SPOOL ASSEMBLY	5
13			LOW/MEDIUM PRESSURE HUB	1
14	39266	809027	LOW/MEDIUM PRESSURE HUB	1
15	38336	809056	HIGH PRESSURE HUB	1
16	38272	809031	STOP RATCHET	1
17	39261	809022	LOW/MEDIUM PRESSURE OUT. PIPE NIPPLE	1
18	39335	809055	HIGH PRESSURE OUTLET PIPE NIPPLE	1
19	39280	809021	LOW/MEDIUM PRESSURE OUTLET ADAPTER	1
20	39337	809058	HIGH PRESSURE OUTLET ADAPTER	1
21	18394	805822	1/4-20 x 3/4 ROUND HEAD MACHINE SCREW	5
22	42055	809860	STOP PAWL ASSEMBLY (*)	1
23	60616	812387	STOP PAWL, BUSHING	1
24	18632	805835	10-24 HEX NUT	2
25	18341	812693	1/4-20 x 3/4 ALLEN HEAD CAP SCREW (**)	1
26	61341	808673	FLAT WASHER (*)	4
27	29053	819066	1/4-20 x 1/2 HEX HD. SELF TAPPING SCREW (**)	4
28	36579	809194	TOP SUPPORT BRACKET (*)	1
29	38280A1	809154	ALUMINUM OUTLET PLATE (**)	1
30	38280A1	809171	OUTLET FRAMES (*)	2
31	38280A1	807173	OUTLET PINS (**)	6
32	33366	819096	10-24 x 1/2 ROLLERS (**)	4
33	60615	812386	STOP PAWL, THRU-OUT COLLAR (*)	6
34	56115	807727	STOP PAWL SPRING	1
35	34749	808315	10-24 x 1 ROUND HEAD MACHINE SCREW	1
36	36430	8085743	3/32 x 3/4 COILER PIN	1
37	15346	808757	AIR-WATER SWIVEL ASSEMBLY	1
38	38813-1	819141	LOW PRESSURE SWIVEL ASSEMBLY	1
39	43310	810695	WASHER PACKING (**)	1
40	31894	806775	SWIVEL SPRING (**)	1
41	31522	806732	WASHER PACKING (**)	1
42	35385	807900	SWIVEL PACKING (**)	1
43	31524	806734	SWIVEL PACKING (**)	2
44	31780	806750	PACKING SLEEVE (**)	1
45	31888	806768	1/8 BALL BEARINGS (**)	11
46	33242	806773	BALL BEARING RETAINER NUT (**)	1
47	31891	807141	SPRING BALL RETAINER (**)	1
48	33109	810808	HIGH PRESSURE SWIVEL STEM (**)	1
49	43540	805823	LEFT HAND UPRIGHT ASSEMBLY	1
50	18401	809029	1/4-20 x 3/4 HEX HEAD CAP SCREW	8
51	39288	811086	HOSE REEL BASE	1
52	43907	810831	STOP PAWL ASSEMBLY (MATCHED SET)	1
53	43555	810831	OUTLET ROLLER ASSEMBLY	1
54	41049	809396	HIGH PRESSURE SWIVEL ASSEMBLY	1
55				1

* Component of "Stop Pawl Assembly" see Item Number 53
 ** Component of "Outlet Roller Assembly" see Item Number 54
 *** Component of "High Pressure Swivel Assembly" see Item Number 55