



**INSTRUCTION SHEET**

**BALCRANK  
2700 SERIES  
HEAVY DUTY HOSE REEL**

<b>MODEL NO.</b>	<b>PART NO.</b>
<b>LOW PRESSURE</b>	
2780 .....	810856
2790 .....	810858
<b>MEDIUM PRESSURE</b>	
2755 .....	810848
2760 .....	810850
2770 .....	810852
2774 .....	810854
	819913
<b>HIGH PRESSURE</b>	
2730 .....	810845

**PRODUCT DESCRIPTION:**

The 2700 Series heavy duty spring actuated reel is designed to be used with the Deluxe multiple reel cabinet. A hardened steel ratchet allows the operator to latch the reel at any desired point and a slight pull is all that is required to release the latch which allows the hose to be retracted slowly and evenly.

**INSTALLATION:**

1. Cabinet Mount:  
The hose reel is shipped ready to use, no

- assembly is required for the basic reel.
2. Setting The Hose Stop:  
The hose reel is adjusted prior to shipment and should not require further adjusting. However, should adjustment become necessary, remove the attached control handle and rubber bumper stop.  
**CAUTION:** Never let the hose slip or retract as this could cause damage to the spring. Thread the hose back into the reel and down through the roller outlet. To increase tension, thread the hose around the spool in the direction that the hose pulls out. One complete revolution should be sufficient. Then pull the hose completely out to see if the ratchet releases. To decrease tension, let the hose unwind one revolution. Then replace the bumper stop and control handle.
3. For Piping Installation to Pumps, Refer to Chart 1:

**IMPORTANT:** Before installation of reels, flush out piping by connecting respective materials used to corresponding lines, operate pump to flush lines. After flushing, dispose of the oil (in an approved manner) as it may contain foreign matter.

**INSTALLATION PIPING SPECIFICATIONS**

<b>PUMPS</b>		<b>TYPE OF REELS</b>	
<b>"JET POWER" SERIES</b>		<b>H.P. GREASE</b>	<b>M.P. OILS</b>
<b>TUBING</b> (DEAD SOFT)	Less Than 200 ft.	5/8" O.D. x .083" Wall	5/8" O.D. x .035" Wall
	Over 200 ft.	3/4" O.D. x .095" Wall	7/8" x .035" Wall
	<b>Fittings</b>	Heavy Series	Standard
<b>PIPE</b>	Less Than 200 ft.	Pipe is Not Recommended	1/2" Standard
	Over 200 ft.	For H.P. Grease Lines	3/4" Standard
	<b>Fittings</b>		Standard
<b>SHUT-OFF VALVE</b>		Balcrank Model 111-1	Balcrank Model 111-2
<b>"GIANT JET" SERIES</b>			
<b>TUBING</b> (DEAD SOFT)	Less Than 200 ft.	3/4" O.D. x .095" Wall	7/8" O.D. x .035" Wall
	200 ft. to 500 ft.	7/8" O.D. x .109" Wall	1" O.D. x .049" Wall
	Over 500 ft.	1" O.D. x .120" Wall	1 1/4" O.D. x .065" Wall
	<b>Fittings</b>	Heavy Series	Standard
<b>PIPE</b>	Less Than 200 ft.	Pipe is Not Recommended	3/4" Standard
	200 ft. to 500 ft.	For H.P. Grease Lines	1" Standard
	Over 500 ft.		1 1/2" Standard
	<b>Fittings</b>		Standard (Malleable)
<b>SHUT-OFF VALVE</b>		Balcrank Model 111-1	Balcrank Model 111-2
			W.O.G. Ball Valve





## INSTRUCTION SHEET

### OPERATION:

No special instructions are required for the operation of the hose reel. The extension and retraction of the hose reel is accomplished by applying tension to the hose.

**CAUTION:** Before the removal of the roller outlet assembly, the uprights should be secured against accidental separation of the hose reel.

### DISASSEMBLY/ASSEMBLY:

1. Left Hand Upright Removal:
  - a. Pull the hose out, lock the spool and remove hose. Remove the locking device and slowly let the spool assembly unwind, while counting the revolutions. The tension from the spring item No. (6) will diminish.
  - b. Remove the swivel item No.'s (42, 43 or 56) from the hub item No.'s (15 or 16).
  - c. Remove the outlet assembly by unscrewing the screws item No.'s (23 & 28) from the elastic nuts item No. (1) and hex nuts item No. (3). Then remove the left hand upright item No. (53).
2. Stop Pawl Removal:

To remove the stop pawl assembly, item No. (25), place left upright in a vise. Remove the nut, item No. (27) which holds the screws, item No. (39) to the left hand upright. Remove the spring, item No. (38) from the cotter pin, item No. (40) and then the cotter pin itself. Using a small punch drive the roll pin, item No. (41) out of the collar, and push the bushing, item No. (26) out of the upright.

**CAUTION:** Make sure the power spring tension is released before any disassembly is done to the hose reel. Power spring repair steps No. 3 and 4 should be performed by an authorized service representative.

3. Power Spring Removal:

To remove the power spring, item No. (6), remove the cap screws, item No.'s (23 & 28), holding right upright to base, item No. (24), and top support bracket, item No. (31). Then place the side rail in a vise so that the spring case item No. (5) is horizontal. Remove the hair pin, item No. (8), cotter pins, item No. (4), and spring case cover, item No. (7). Grasp the old spring (outside the coils) near the pin, on the spring case with vise grips, and pull the spring out of the case. Before removing the vise grips, use a

small length of wire to bind the power spring so that it will not uncoil freely.

4. Power Spring Replacement:

Place new spring in case so that, starting from outside coil, spring is wound clockwise. Replace cover, item No. (7) and the cotter pins, item No.'s (4 & 8). Be sure spring center plates, item No. (10), are positioned on hub to receive center loop of spring, also make sure that the outer loop of spring is positioned on the pin. With hose completely coiled on spool (Control Handle Removed) wind hose reel spool assembly, item No. (13) in direction spool would turn if hose were being pulled out the same number of turns as was counted in section 1a of the disassembly/assembly procedure. (See section for adjusting tension).
5. Replacing Hose:

To replace hose, pull hose out, lock hose reel spool assembly, item No. (13), remove hose, replace with new hose, let hose rewind. This method will eliminate resetting tension.

### TO ASSEMBLE:

Reverse the above procedures where applicable.

### PREVENTATIVE MAINTENANCE:

No preventative maintenance is necessary.

### CORRECTIVE MAINTENANCE:

1. General Overhaul:

Disassemble the hose reel according to the procedures in the disassembly/assembly section. Inspect parts for damage and wear. Replace parts if necessary. Re-assemble the hose reel by following the assembly procedure.
2. Reel Adjustments:

See installation; setting hose stops.
3. Power Spring Removal:

See disassembly; power spring removal.

**CAUTION:** Use extra care in removing the power spring and its adjacent components. Never remove outlet pipe, item No.'s (18 or 19) with tension on the power spring as this could result in damage to the power spring. Lack of caution could result in personal injury.

**NOTE:** Do not detach the control handle disconnect hoses or piping unless the supply pump has been completely shut off and the system pressure has been relieved.

**NOTE:** The working pressure of a reel assembly is governed by the hose selection. Hose specifications are found in the general catalog. The pressure rating of Bare Reels is as follows:

LOW PRESSURE REEL: (300 PSI).  
MEDIUM PRESSURE REEL: (1600 PSI).  
HIGH PRESSURE REEL: (6700 PSI).

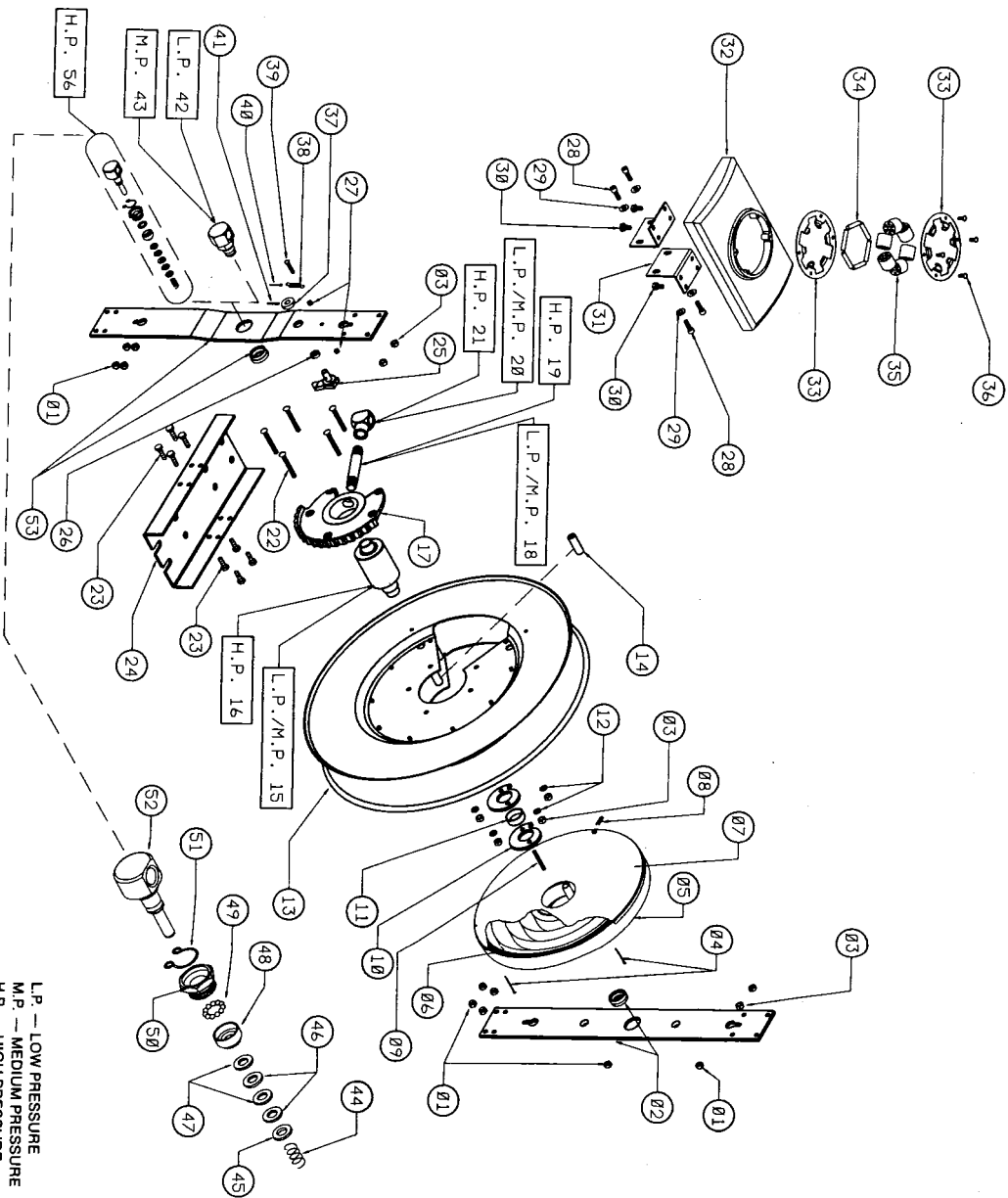

L.P. — LOW PRESSURE  
M.P. — MEDIUM PRESSURE  
H.P. — HIGH PRESSURE

**BILL OF MATERIALS**

ITEM NO.	MODEL NO.	PART NO.	DESCRIPTION	QTY.
1	63772	813561	1/4-20 ELASTIC LOCK NUT	10
2	43539	810807	RIGHT HAND UPRIGHT ASSEMBLY	1
3	21244	805992	1/4-20 HEX NUT	9
4	39611	808719	3/32 x 1-1/4 COTTER PIN	2
5	42596	810148	SPRING CASE ASSEMBLY	1
6	36320	808274	POWER SPRING	1
7	36327	808277	SPRING CASE COVER	1
8	27618	806452	HAIR PIN	1
9	38813-19	806754	7/32 x 1-5/8 ROLL PIN	1
10	64154	813779	SPRING CENTER PLATE SPACER	2
11	39148	806967	1/4 LOCK WASHER	1
12	17132	805784	HOSE REEL SPOOL ASSEMBLY	5
13			RATCHET SUPPORT	1
14	36331	808279	LOW/MEDIUM PRESSURE HUB	1
15	39148	809096	HOSE REEL SPOOL ASSEMBLY	1
16	38419	809097	RATCHET SUPPORT	1
17	38251	809097	HOSE REEL SPOOL ASSEMBLY	1
18	38252	809022	LOW/MED. PRESSURE OUTLET PIPE NIPPLE	1
19	38358	809055	HIGH PRESSURE OUTLET PIPE NIPPLE	1
20	38250	809021	LOW/MEDIUM PRESSURE OUTLET ADAPTER	1
21	38357	809058	HIGH PRESSURE OUTLET ADAPTER	1
22	18403	807189	1/4-20 x 2 ROUND HEAD MACHINE SCREW	5
23	18417	809084	1/4-20 x 3/4 HEX HEAD CAP SCREW	8
24	38417	809084	STOP PAWL BASE	1
25	42055	812997	STOP PAWL ASSEMBLY (*)	1
26	60516	812997	STOP PAWL BUSHING	1
27	18832	805835	10-24 HEX NUT	1
28	61341	812893	1/4-20 x 3/4 ALLEN HEAD CAP SCREW	2
29	29053	806613	FLAT WASHER	4
30	39579	819066	1/4-20 x 1/2 HEX HEAD SELF TAPPING SCREW	4
31	39290A1	809154	TOP SUPPORT BRACKET	1
32	33364	809037	ALUMINUM OUTLET PLATE (*)	1
33	33366	807171	OUTLET FRAME (*)	2
34	33366	807173	OUTLET PIN (*)	1
35	33365	807172	OUTLET ROLLER (*)	4
36	80615	819064	10-24 x 1/2 RD. HD. SELF TAPPING SCREW (*)	6
37	34749	812396	STOP PAWL THRUST COLLAR (*)	4
38	36430	807227	STOP PAWL SPRING	1
39	808315	808315	10-24 x 1 ROUND HEAD MACHINE SCREW	1
40	15346	805743	3/32 x 3/4 COTTER PIN	1
41	38813-1	808757	7/32 x 7/8 ROLL PIN	1
42	42	819141	LOW PRESS. AIR-WATER SWIVEL ASSEMBLY	1
43	43310	810605	LOW/MEDIUM PRESSURE SWIVEL ASSEMBLY	1
44	31894	806775	WASHER PACKING (***)	1
45	31522	806732	SWIVEL PACKING (***)	1
46	35385	807800	SWIVEL PACKING (***)	2
47	31524	806734	SWIVEL PACKING (***)	1
48	31888	806768	PACKING SLEEVE (***)	2
49	31780	806750	1/8 BALL BEARINGS (***)	11
50	31881	806773	BALL BEARING RETAINING NUT (***)	1
51	33242	807143	SPRING BALL RETAINER (***)	1
52	33709	807113	HIGH PRESSURE SWIVEL STEM (***)	1
53	43540	810088	LEFT HAND UPRIGHT	1
54	43907	811008	STOP PAWL ASSEMBLY (MATCHED SET)	1
55	43555	810831	OUTLET ROLLER ASSEMBLY	1
56	41049	809396	HIGH PRESSURE SWIVEL ASSEMBLY	1

\* Component of "Stop Pawl Assembly" see Item Number 54  
 \*\* Component of "Outlet Roller Assembly" see Item Number 55  
 \*\*\* Component of "High Pressure Swivel Assembly" see Item Number 56