

OPERATOR'S MANUAL

612254-X-D

INCLUDING: OPERATION, INSTALLATION & MAINTENANCE

ALSO INCLUDE MANUALS: 6641X-X Air Motor, 636077 Swivel, 636103 Control Handle, 636111 Control Handle (Model 612254-S-D Only), 640057 Dolly (Model 612254-D Only) & 640028 Follower Plate

612255-D

RELEASED:6-14-73
REVISED:9-5-93
IPP/PSE

USE SERVICE KITS

637066-B for 66410 Air Motor
637021 For Lower Pump Asm. (See Page 4)

CHASSIS LUBRICATOR 50:1 RATIO 120 LBS. DRUM 612254-D DRUM COVER, PORTABLE

REF	DESCRIPTION	PART NO.
*1	Coupler.....	210
2	Connector.....	2608
*3	Control Handle.....	636103
	Control Handle (Model 612254-S-D Only).....	636111
*4	Swivel.....	636077
5	Cover (Includes 9, 10 & 11).....	72903-2
6	Hose (6').....	624201-6
*7	Dolly.....	640057
8	Grommet.....	72902
9	Nozzle.....	73934
10	Nut.....	73935
11	Screw.....	Y66-368-C
*12	Follower Plate (Not Shown).....	640028

612255-D DRUM COVER, STATIONARY

REF	DESCRIPTION	PART NO
1	Cover.....	61613
*2	Follower Plate.....	640028
3	Air Hose (3').....	622201-3
4	Material Hose (4').....	624401-4
*5	Coupler (Not Shown).....	210
6	Connector (Not Shown).....	2608

*REFER TO OPERATORS MANUAL

WARNING: HIGH PRESSURE DEVICE.
IMPROPER USAGE OF EQUIPMENT COULD RESULT IN SERIOUS INJURY. THE POSSIBILITY OF INJECTION INTO THE FLESH IS A POTENTIAL HAZARD. NEVER ALLOW ANY PART OF THE HUMAN BODY TO COME IN FRONT OF OR IN DIRECT CONTACT WITH THE MATERIAL OUTLET.

AN INJECTION INJURY CAN BE SERIOUS! IF INJECTION SHOULD OCCUR, CONTACT A QUALIFIED PHYSICIAN FOR IMMEDIATE TREATMENT OF SUCH INJURIES.

612254-D
612254-S-D

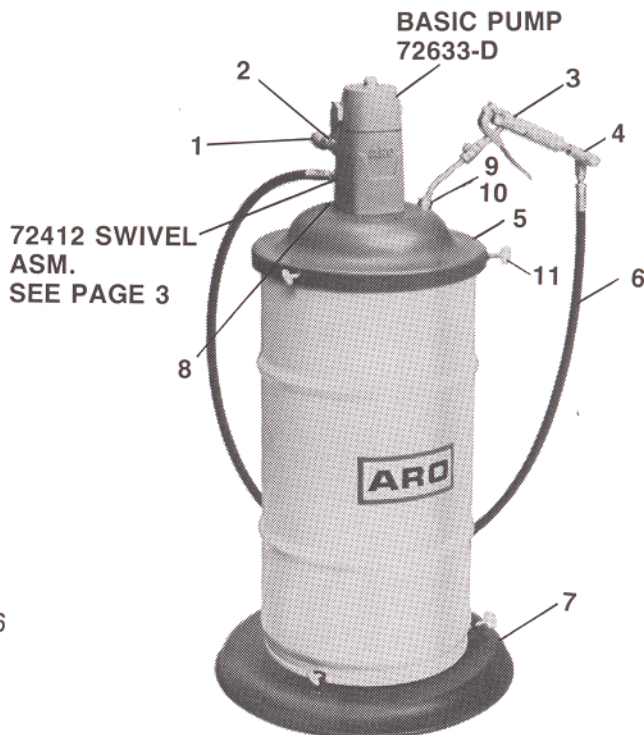

DRUM NOT INCLUDED

612255-D

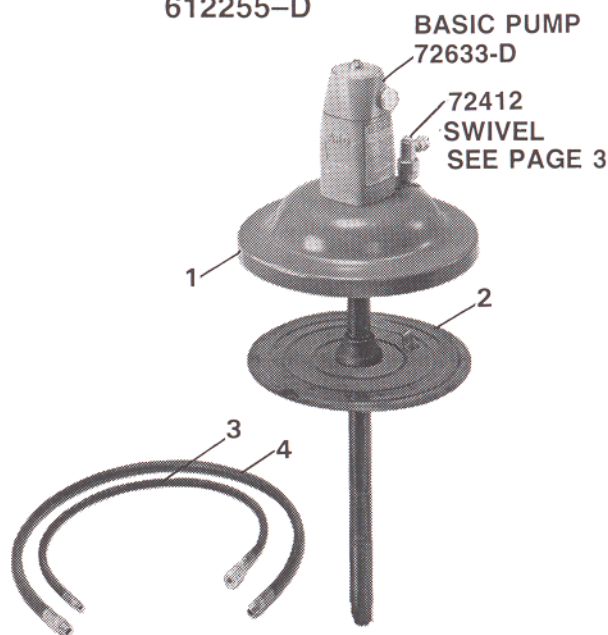

DO NOT EXCEED MAXIMUM MATERIAL WORKING PRESSURE OF 7500 P.S.I. (517 BAR) @ 150 P.S.I. (10 BAR) INLET AIR PRESSURE.

THE ARO CORPORATION • ONE ARO CENTER • BRYAN, OHIO 43506-0151
PH: (419) 636-4242 • FAX (419) 636-2115
©1993 THE ARO CORPORATION • PRINTED IN U.S.A.



Part of worldwide Ingersoll-Rand

LOWER PUMP END

The 50:1 ratio is an expression of the relationship between the effective air motor area and the effective lower pump end area. When 150 P.S.I. (10 bar) of air pressure is supplied to the air motor, the lower pump

end will develop a maximum of 7500 P.S.I. (517 bar) of fluid pressure (at no flow). As the fluid control is opened, the flow rate will increase as the air motor cycle rate increases to keep up with the demand.

SAFETY PRECAUTIONS

- Use ARO® replacement parts to assure compatible pressure rating.
- HEED ALL WARNINGS AND CAUTIONS.
- Suction and discharge connections should be flexible connections (such as hose), not rigid piped.
- Be sure material hoses and other components are able to withstand fluid pressures developed by this pump.
- Disconnect air line from pump when system sits idle for long periods of time.

WARNING: When using pump in a location where surrounding atmosphere is conducive to spontaneous combustion or when pumping, flushing or recirculating inflammable substances (e.g., paints, solvents, lacquers, etc.), failure to safeguard against static spark, open flame, heat and improper ventilation could result in explosion and/or fire causing severe personal injury or death and/or property damage.

- Safety precautions should include:
 - Use of static wire hoses.
 - Proper grounding of pump, dispensing valve or device, hoses, any object to which substance is being transferred, and containers. After grounding, periodically check to verify continuity of electrical path to ground. Test with ohmmeter from each components (i.e., hoses, pump, clamp, container, spray gun, etc.) to ground to insure continuity. Ohmmeter reading shown should be 10 ohms or

AIR AND LUBE REQUIREMENTS

- **WARNING:** DO NOT EXCEED MAXIMUM INLET AIR PRESSURE OF 150 PSI (6.9 BAR). OPERATING PUMP AT HIGHER PRESSURE MAY CAUSE PUMP DAMAGE AND/OR PERSONAL INJURY AND/OR PROPERTY DAMAGE.
- A Filter capable of filtering out particles larger than 50 microns should be used on the air supply. In most applications there is no lubrication required other than the "O" Ring lubricant which is applied during assembly or repair. When lubricated air is necessary, supply air lubricator with a good grade of SAE 90 wt. nondetergent oil and set lubricator to a rate not to exceed one drop per minute.

less. Consult local electric codes for specific grounding requirements.

- Submersion of outlet hose end, dispensing valve or device within substance being dispensed whenever possible. (Avoid free streaming of substance being dispensed.)
- Proper ventilation of area where pump and containers are located.
- Keeping inflammables away from heat, open flames and sparks.
- Keeping containers closed when not in use.
- Secure pump, connections and all contact points to avoid vibration and generation of contact or static spark.
- **CAUTION:** The chemical compatibility of the materials of which the wetted parts of the pump are constructed and the substance being pumped, flushed or recirculated with the pump must be verified. Chemical compatibility may change with temperature and concentration of chemical(s) within substance being pumped, flushed or recirculated. Consult ARO Form 8677-P, Fluid Compatibility Guide, for information on chemical compatibility. The Form 8677-P is available from ARO upon request.
- **WARNING:** DO NOT SERVICE OR CLEAN PUMP, OR REMOVE OUTLET HOSE AND/OR DISPENSING VALVE OR DEVICE, WHILE UNDER PRESSURE AS SERIOUS PERSONAL INJURY COULD RESULT. First disconnect air line, then relieve pressure from system by opening dispensing valve or device and/or carefully and slowly loosening and removing outlet hose or piping from pump.
- **CAUTION:** Do not allow pump to operate for long periods of time when out of material. This may cause unnecessary wear or damage to the pump.

FILTER-REGULATOR-LUBRICATOR combination (F-R-L) Model C28221-XXX is recommended for use with this pump. The capacity of the individual Filter-Regulator-Oiler is adequate to provide clean (40 micron), regulated, and oiled air for the pump.

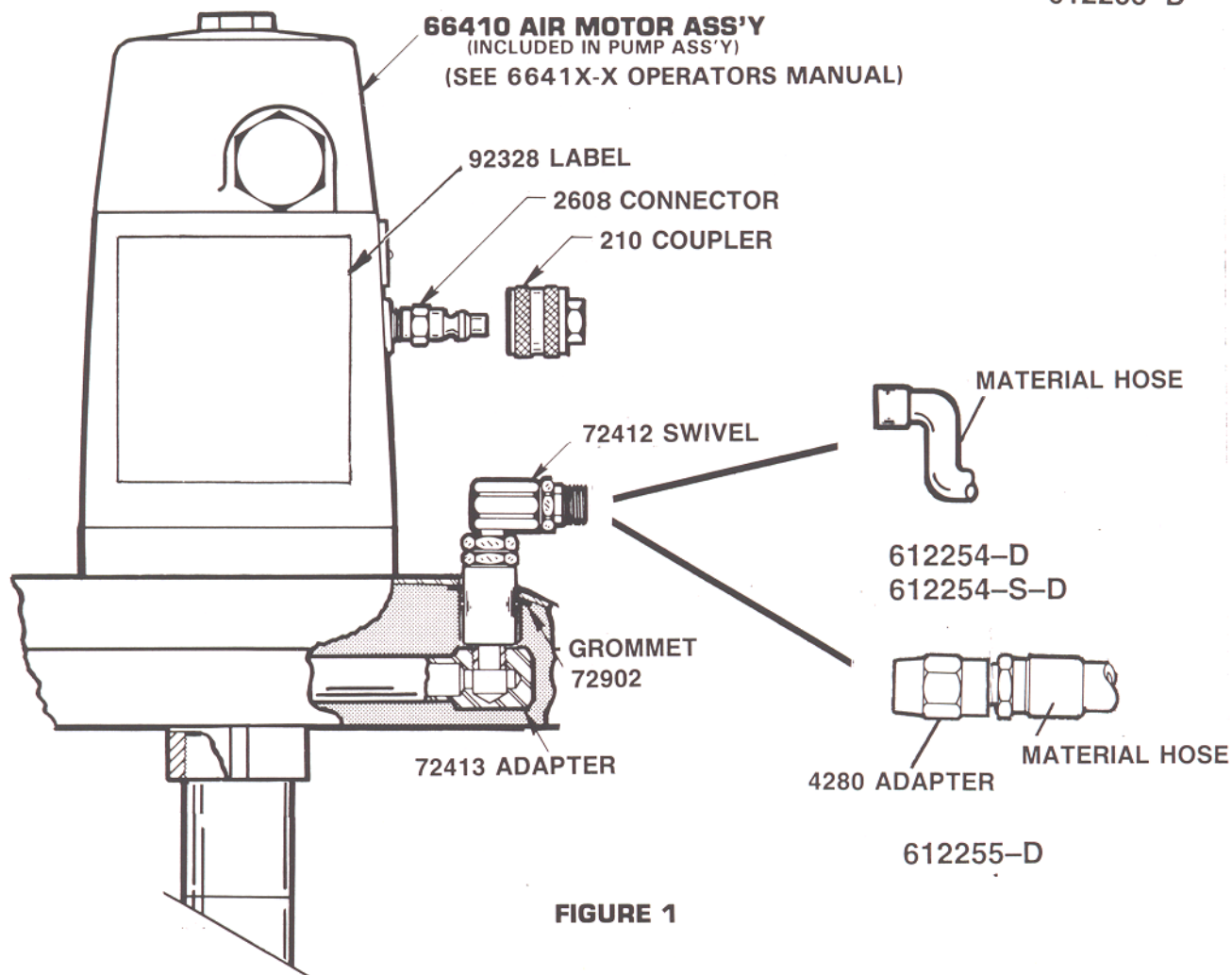

FIGURE 1

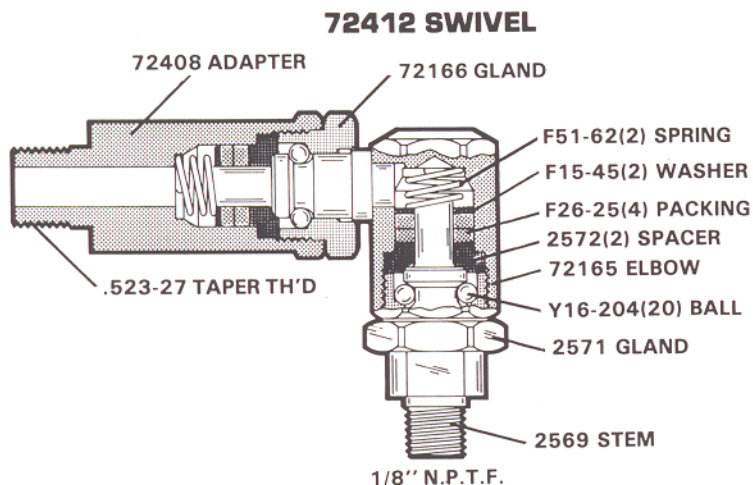

FIGURE 2

SYSTEM OPERATION

WARNING: High pressure equipment. Keep clear of nozzle.

When removing gun from grease fitting, do not pull straight off. Move gun until coupler is above 45° angle to fitting and then pull off. This will greatly increase the life of the coupler.

Should pump operate but dispense little or no lubricant, check for:

1. Inadequate supply of lubricant.
2. Improper feeding of lubricant into pump. This condition is known as "channeling" and is often indicated by light-colored frothy grease coming from control handle. Also, grease in container

will not be level but will cling to side of container and slope down to suction tube inlet. It usually occurs at cool temperatures and can be corrected by using the follower plate 640028.

3. Dirt or foreign matter between 60940 Foot Valve and 6797 Valve Seat, or other cause which may be preventing foot valve from properly seating on downstroke of piston.

If unit should completely fail to operate, the following procedure will be helpful in determining the cause:

1. Check air pressure at pump to insure air line is not obstructed and air is being supplied to pump.
2. If insufficient air is not the trouble, disconnect 210 Speed Coupler at pump and then detach Hose and Gun at 72412 Swivel. **REMOVE SLOWLY AS PRESSURE MAY BE BUILT UP IN PUMP.** Hold rag at this point and apply air to pump. If pump now operates, there is obstruction in material line, reel, or control handle. If, however, pump will still not operate, consult local dealer.

PARTS LIST

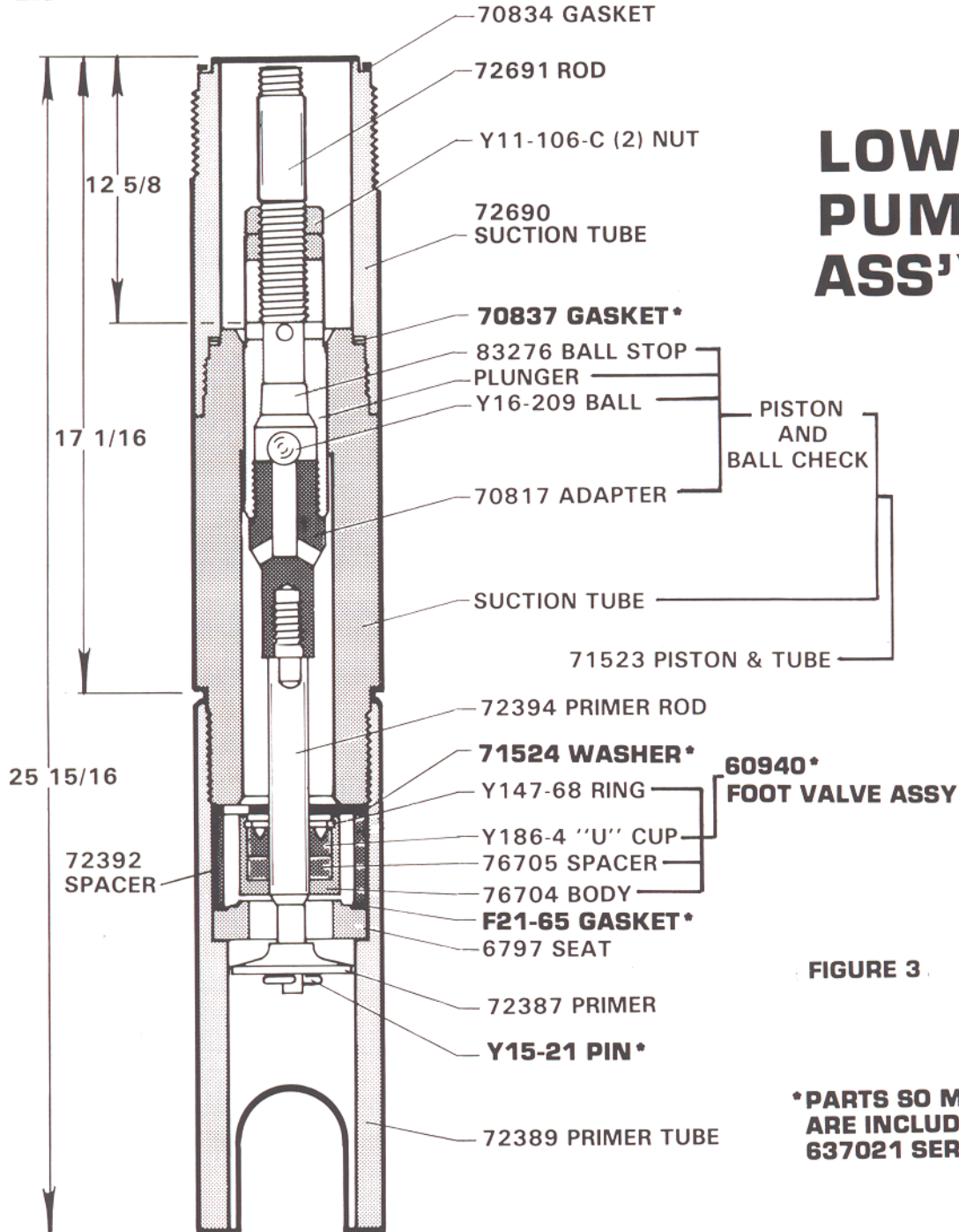

FIGURE 3

*PARTS SO MARKED ARE INCLUDED IN 637021 SERVICE KIT